

Server 1 : Qty 1  
Utility Counter

- A 4" Casters (2) w/Brakes
- B Customer Side Plate Rest w/Lift-off Bracket
- C Storage Shelf w/ Hinged Doors
- D (1) Interior Receptacle And Grommet
- E SST End Shelf Operator LH End

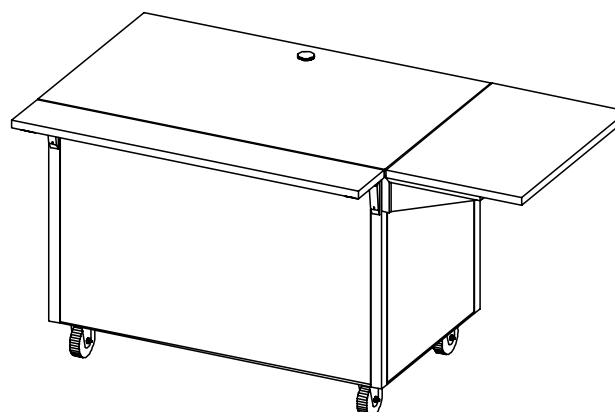
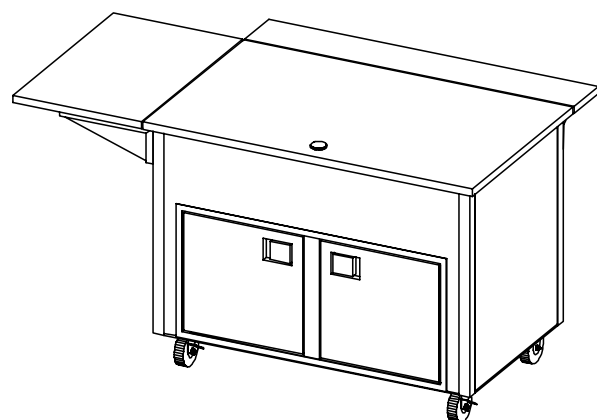

#### Finishes And Materials

Top : 16 Ga SST  
Body : Laminate TBD  
Trim : 18 Ga SST  
Plate Rest : 18 Ga SST

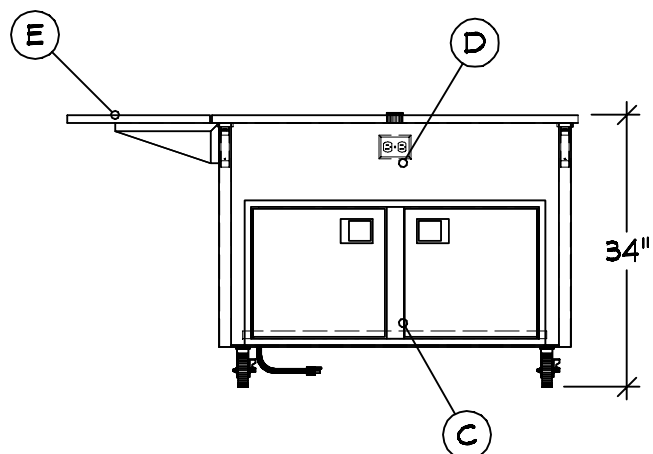
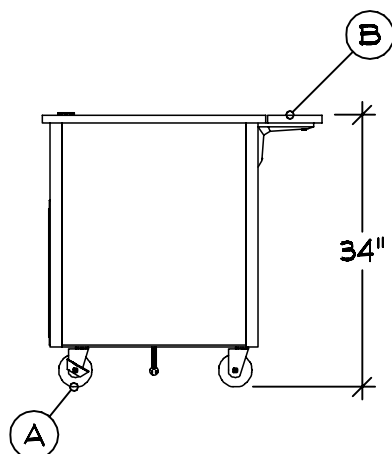

VOLTS 120  
Ø 1  
12.0 Max A

60  
15  
15

ELECTRICAL  
NEMA 5-15

WISPR

WACO - INDIAN SPRINGS BACK LINE

**VOLLRATH**

THE VOLLRATH CO., LLC

04-15-21  
COPYRIGHT 2021  
SHEBOYGAN, WI

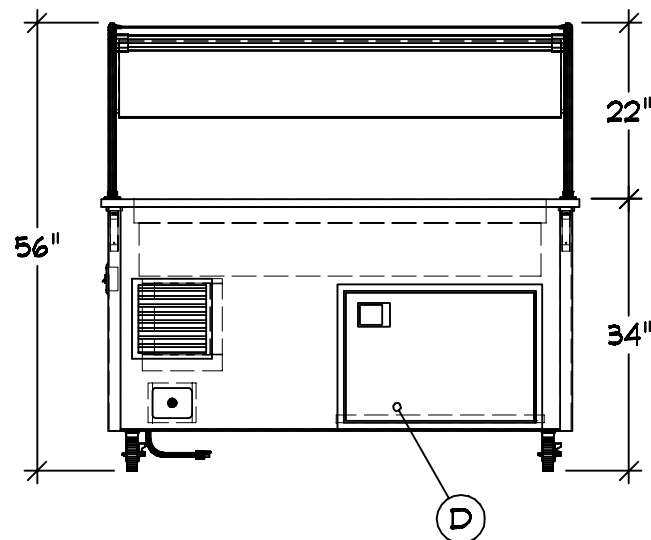
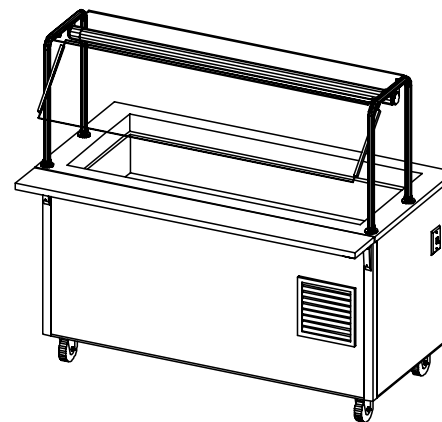
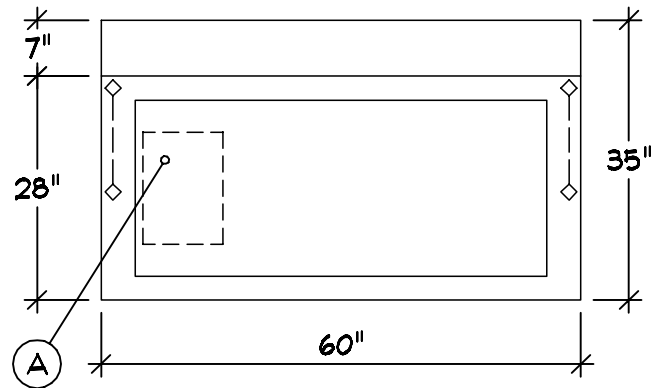
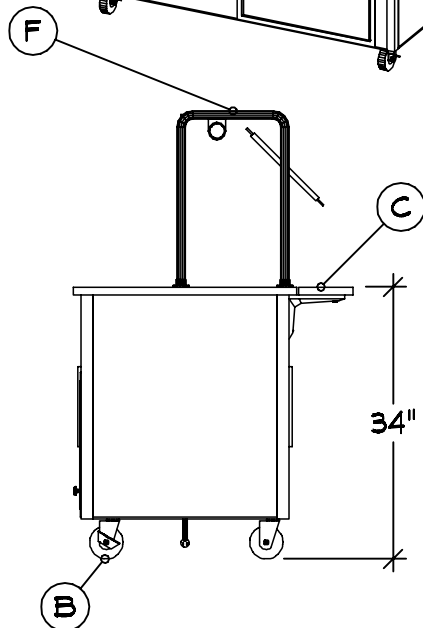
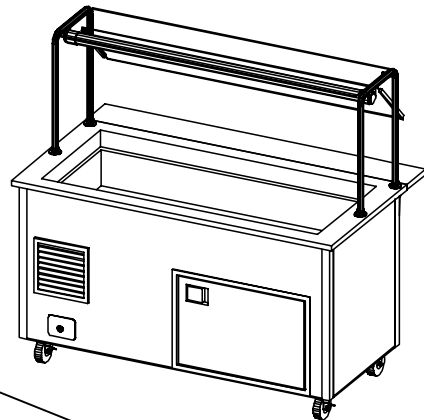
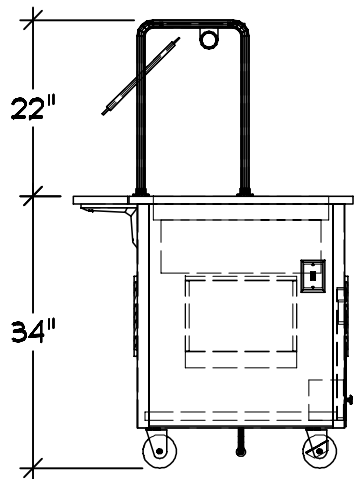

- Server 2 : Qty 1  
Cold Food Counter  
A (1) 4 Pan Nsf7 Cold Well  
B 4" Casters (2) w/Brakes  
C Customer Side Plate Rest  
w/Lift-off Bracket  
D Storage Shelf w/ Hinged  
Doors  
E (1) 1\2" Drain With Ball  
Valve  
F Contemporary Breath Guard

Single Side Buffet  
With Top Shelf  
With Adjustable Front Panel  
Full Width S-S  
1" SST Tubular Construction  
2" Dia Mounting Flanges  
3/8" Tempered Glass  
Fluorescent Lights  
On Board Switch  
\*\*\* Does Not Meet Current  
NSF Standards

#### Finishes And Materials

Top : \*\* 14 Ga SST  
Body : Laminate TBD  
Trim : 18 Ga SST  
Plate Rest : 18 Ga SST  
Breath Grd : Brushed SST

VOLTS 120  
Ø 1  
5.5 A

60  
1/2  
ELECTRICAL  
NEMA 5-15

PLUMBING CW: -  
HW: -  
WASTE: (1) Ø.5" INDIRECT

WISPR

WACO - INDIAN SPRINGS BACK LINE

**VOLLRATH**

THE VOLLRATH CO., LLC

04-15-21

COPYRIGHT 2021  
SHEBOYGAN, WI

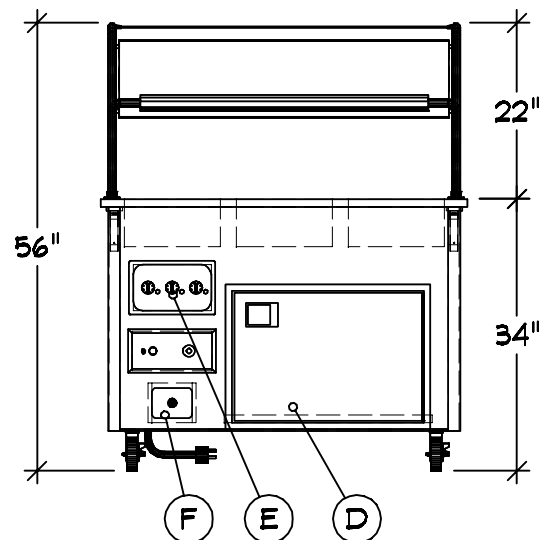
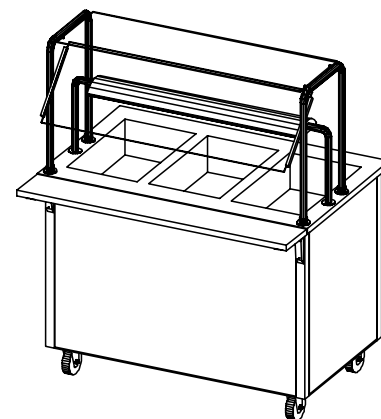
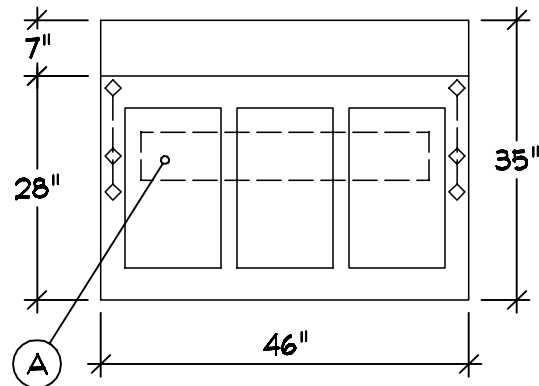
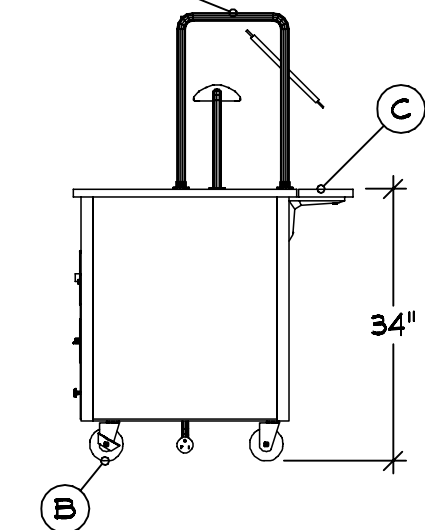
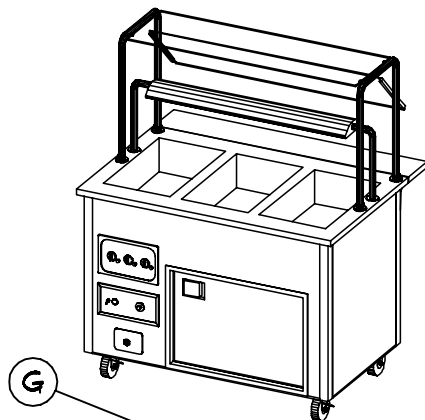
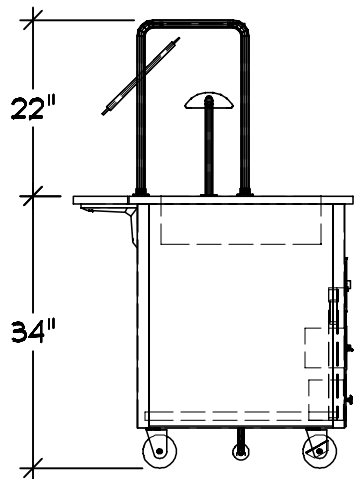

- Server 3 : Qty 1  
Hot Food Counter
- A 3 Individual Wet Hot Wells
  - B 4" Casters (2) w/Brakes
  - C Customer Side Plate Rest w/Lift-off Bracket
  - D Storage Shelf w/ Hinged Doors
  - E Dial Controls
  - F (1) 1/2" Drain With Ball Valve
  - G Contemporary Breath Guard

Single Side Buffet  
With Top Shelf  
With Adjustable Front Panel  
Full Width S-S  
1" SST Tubular Construction  
2" Dia Mounting Flanges  
3/8" Tempered Glass  
Hatco Heat Strip  
Hatco LED Light  
Remote Control And Switch  
\*\*\* Does Not Meet Current  
NSF Standards

#### Finishes And Materials

Top : \*\* 14 Ga SST  
Body : Laminate TBD  
Trim : 18 Ga SST  
Plate Rest : 18 Ga SST  
Breath Grd : Brushed SST

| EQUIPMENT                         |           | Voltage   | L1Amp                   |
|-----------------------------------|-----------|---|-------------------------|
| HOT WELLS                         |           | 120   | 15.6                    |
| HEAT STRIP                        |           | 120   | 6.9                     |
| LIGHTS                            |           | 120   | 1.4                     |
| Total Amps                        |           |   | 23.9                    |
| VOLTS                             | 120       |  | ELECTRICAL<br>NEMA 5-30 |
| Ø<br>AMP                          | 1<br>23.9 |   |                         |
| PLUMBING                          |           |   |                         |
| CW: -<br>HW: -<br>WASTE: (1) Ø.5" |           | INDIRECT  |                         |
|                                   |           |   |                         |
|                                   |           |   | WISPR                   |

**WACO - INDIAN SPRINGS BACK LINE**



04-15-21

COPYRIGHT 2021

THE VOLLRATH CO., LLC

SHEBOYGAN, WI



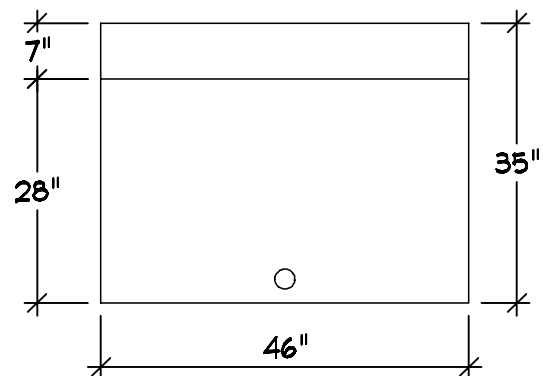
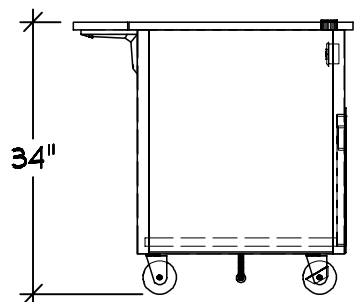

Server 4 : Qty 1  
Utility Counter

- A 4" Casters (2) w/Brakes
- B Customer Side Plate Rest w/Lift-off Bracket
- C Storage Shelf w/ Hinged Doors
- D (1) Interior Receptacle And Gromet

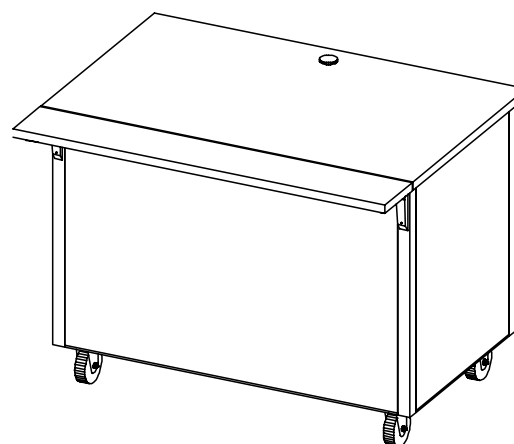
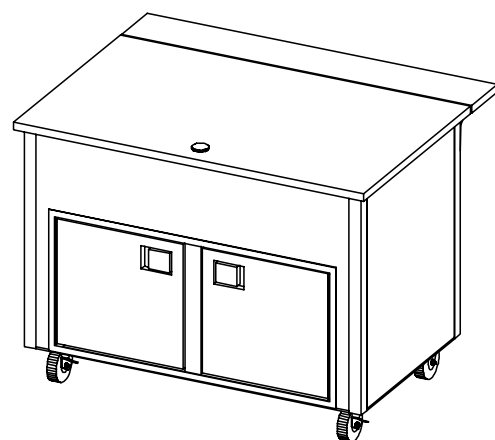

#### Finishes And Materials

Top : 16 Ga SST  
Body : Laminate TBD  
Trim : 18 Ga SST  
Plate Rest : 18 Ga SST

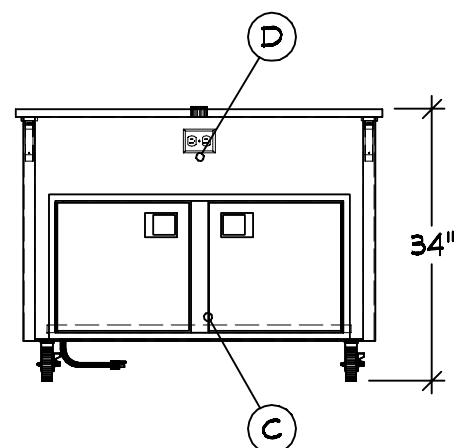
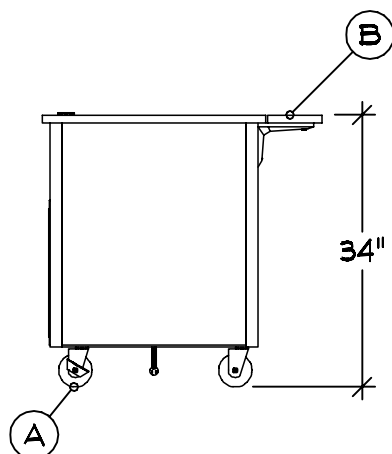

|            |     |  |                         |
|------------|-----|--|-------------------------|
| VOLTS      | 120 |  | ELECTRICAL<br>NEMA 5-15 |
| Ø          | 1   |  |                         |
| 12.0 Max A |     |  |                         |

WISPR

WACO - INDIAN SPRINGS BACK LINE

**VOLLRATH**

THE VOLLRATH CO., LLC

04-15-21  
COPYRIGHT 2021  
SHEBOYGAN, WI

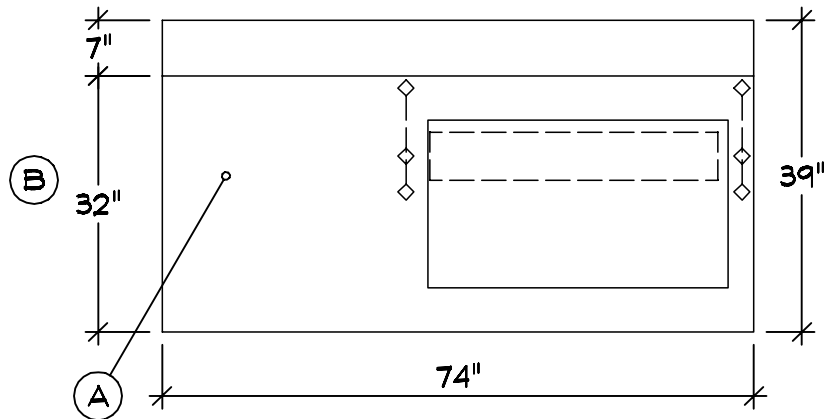
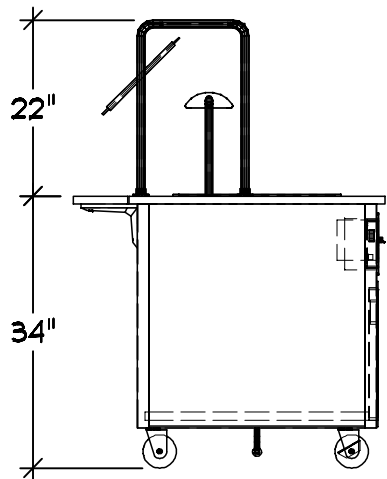

A TOP LAYOUT OPERATOR L-R

OPEN WORK TOP  
HEATED SHELF DISPLAY  
TSTAT CONTROLS  
SUPPLIED BY VOLLRATH  
INSTALLED BY VOLLRATH

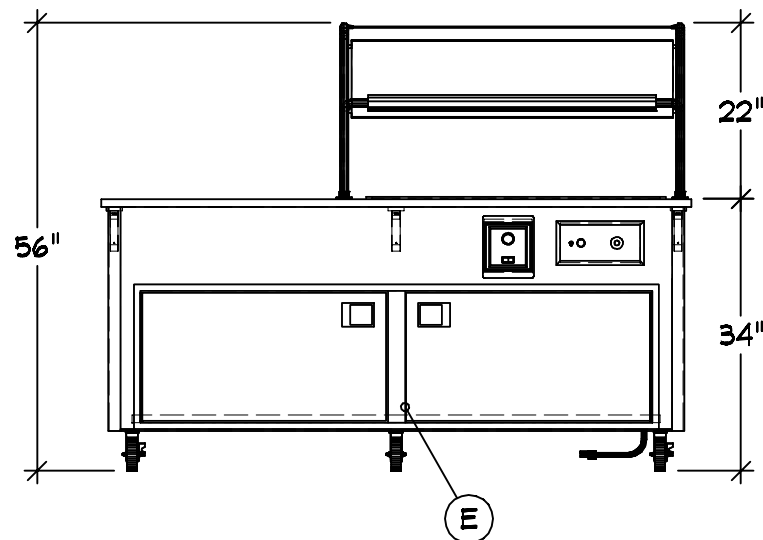
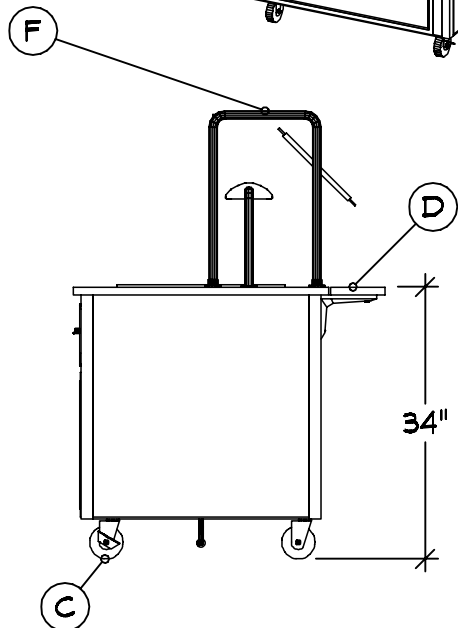
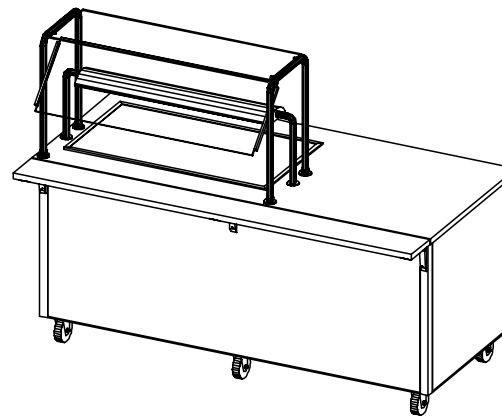



Server 5 : Qty 1  
Utility Counter

- A Custom Configuration
- B Custom Counter Depth
- C 4" Casters (2) w/Brakes
- D Customer Side Plate Rest w/Lift-off Bracket
- E Storage Shelf w/ Hinged Doors
- F Contemporary Breath Guard

Single Side Buffet  
With Top Shelf  
With Adjustable Front Panel  
Over Well Only  
1" SST Tubular Construction  
2" Dia Mounting Flanges  
3/8" Tempered Glass  
Hatco Heat Strip  
Hatco LED Light  
Remote Control And Switch  
\*\*\* Does Not Meet Current  
NSF Standards

#### Finishes And Materials

Top : \*\* 14 Ga SST  
Body : Laminate TBD  
Trim : 18 Ga SST  
Plate Rest : 18 Ga SST  
Breath Grd : Brushed SST

| EQUIPMENT Voltage LIamp   |                    |                                 |
|---|--------------------|---------------------------------|
| HEATED SHELF  | 120                | 7.8                             |
| HEAT STRIP  | 120                | 5.7                             |
| LIGHTS  | 120                | 0.7                             |
| Total Amps  |                    | 14.2                            |
| VOLTS<br>Ø  | 120<br>1<br>14.2 A | ELECTRICAL<br>NEMA 5-20         |
|  |                    |                                 |
| WISPR   |                    |                                 |
| WACO - INDIAN SPRINGS BACK LINE   |                    |                                 |
|  |                    | 04-15-21                        |
| THE VOLLRATH CO., LLC   |                    | COPYRIGHT 2021<br>SHEBOYGAN, WI |

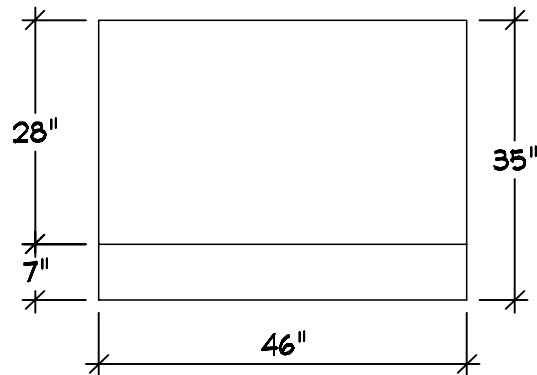
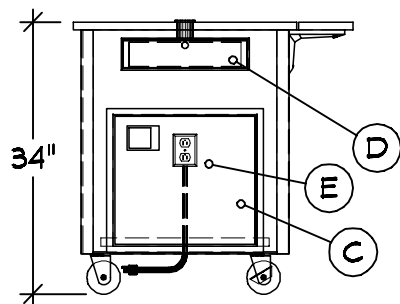

Server 6 : Qty 1  
Utility Counter

- A 4" Casters (2) w/Brakes
- B Cashier Right Side Plate Rest w/Lift-off Bracket
- C End Oriented Cashier Opening w/ Hinged Door
- D Cash Drawer
- E Receptacle And Cord Grommet

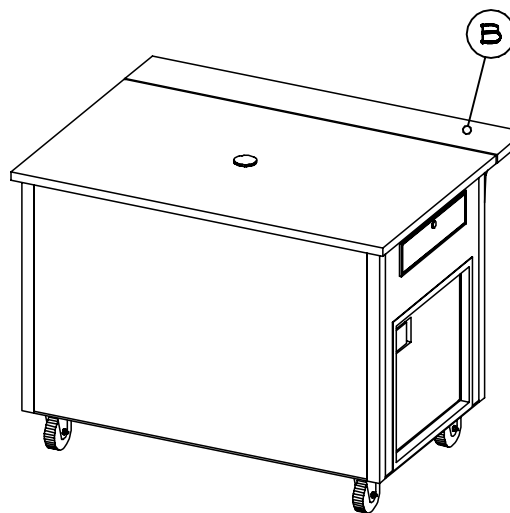
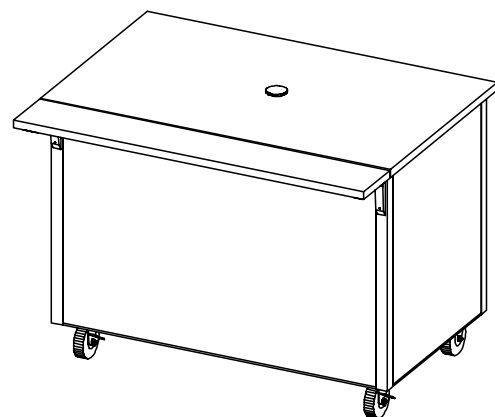

#### Finishes And Materials

- Top : 16 Ga SST
- Body : Laminate TBD
- Trim : 18 Ga SST
- Plate Rest : 18 Ga SST

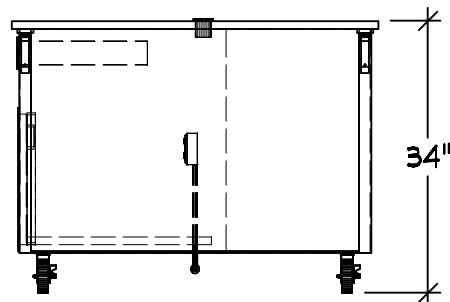
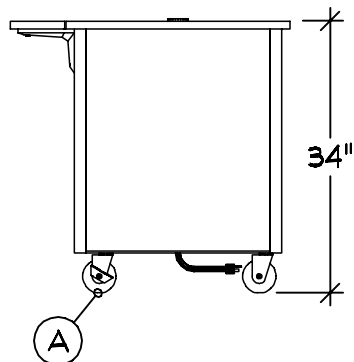

VOLTS 120  
Ø 1  
10.0 A

60  
1  
W

ELECTRICAL  
NEMA 5-15

WISPR

WACO - INDIAN SPRINGS BACK LINE

**VOLLRATH**

THE VOLLRATH CO., LLC

04-15-21

COPYRIGHT 2021  
SHEBOYGAN, WI

## GENERAL NOTES - PLEASE READ

### CONFIGURATION:

THESE DRAWINGS ARE TO BE USED IN CONJUNCTION WITH THE PREPARED QUOTATION AND MUST BE RECONCILED PRIOR TO RELEASE FOR FABRICATION.

### DIMENSIONS:

ALL DIMENSIONS SHOWN ARE  $\pm 1/4"$

### CONNECTIONS:











ALL PIPING, FITTINGS, AND INTERCONNECTION SERVICES SHOWN ARE TO BE SUPPLIED AND INSTALLED BY LICENSED CONTRACTORS IN ACCORDANCE WITH ALL LOCAL CODES.

### BY OTHERS:

VERIFY ALL EQUIPMENT LISTED AS BY OTHERS FOR SIZE AND MECHANICAL SERVICE REQUIREMENTS.

### NOTE:

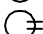
IN LINE WITH THE POLICY TO CONTINUALLY IMPROVE ITS PRODUCTS, THE MANUFACTURE RESERVES THE RIGHT TO CHANGE MATERIALS AND SPECIFICATIONS WITHOUT NOTICE.

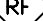
|   |                  |
|---|------------------|
|  | CONNECTION POINT |
|  | COLD WATER       |
|  | HOT WATER        |
|  | HOT + COLD WATER |
|  | DRAIN            |
|  | POWER            |
|  | SWITCH           |
|  | CORD SET         |
|  | CONV OUTLET RECP |
|  | DUPLEX RECPTACLE |
|  | SINGLE RECPTACLE |
|  | REFRIGERATION    |



## CONFIDENTIAL DESIGN

The Vollrath Company, L.L.C. ("Vollrath") considers this new design proprietary and confidential. Due to the existing relationship of trust and good faith between Vollrath and Recipient, Vollrath is providing this proprietary and confidential design and related information to Recipient with the understanding that Recipient will maintain such design and information in secrecy and will not directly or indirectly use, disseminate, or otherwise disclose this proprietary and confidential information to any outside person or organization without the express written prior consent of The Vollrath Company, L.L.C.

08-26-2018

09-16-2018

01-24-2019

07-22-2019

04-08-2021 : 09:11:20a

04-15-2021 : 10:52:53a

WISPR

WACO - INDIAN SPRINGS BACK LINE



THE VOLLRATH CO., LLC

04-15-21

COPYRIGHT 2021  
SHEBOYGAN, WI