

RVIST

RIO VISTA



THE VOLLRATH CO., LLC

08-19-21

COPYRIGHT 2021

SHEBOYGAN, WI

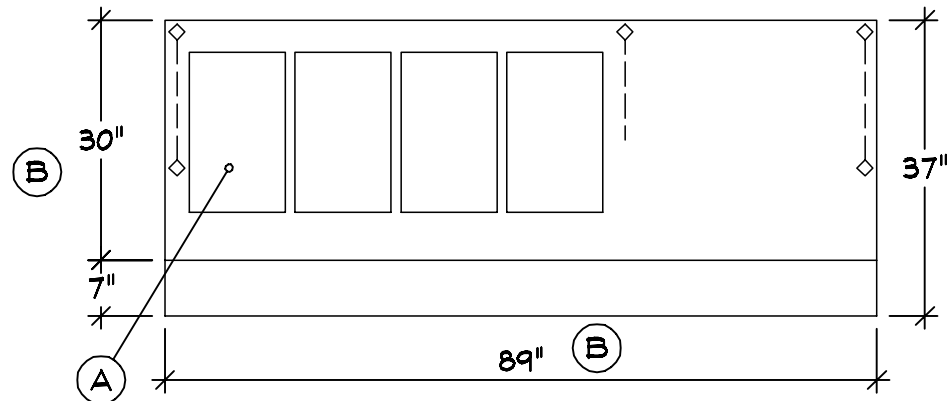
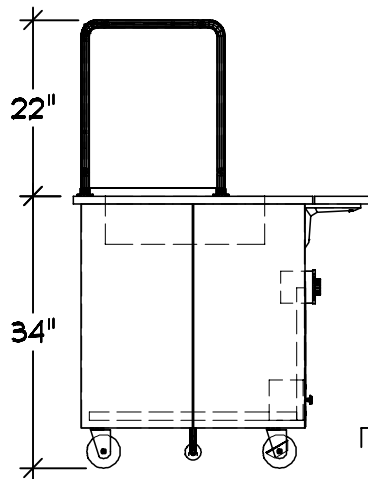

A Top Layout Operator L-R
(5) Integrated Wet Hot Wells
625 Watt Wells
Open Work Top

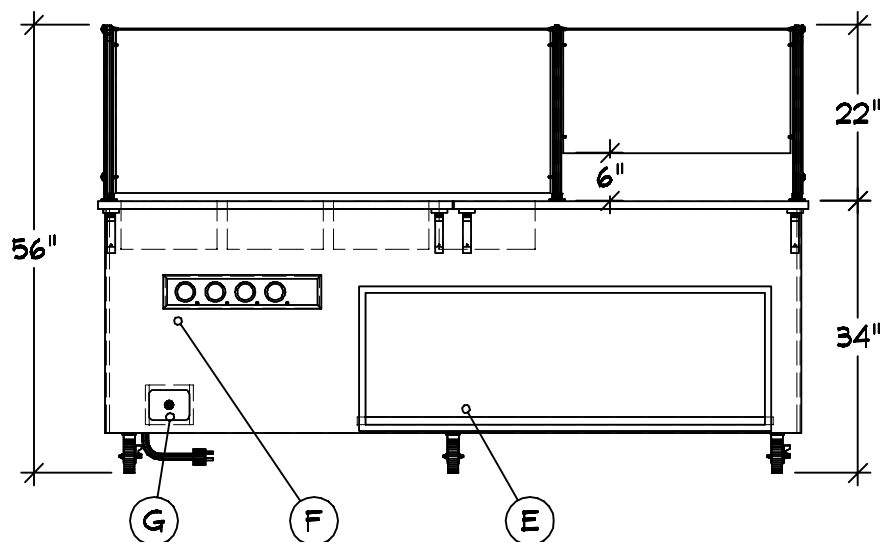
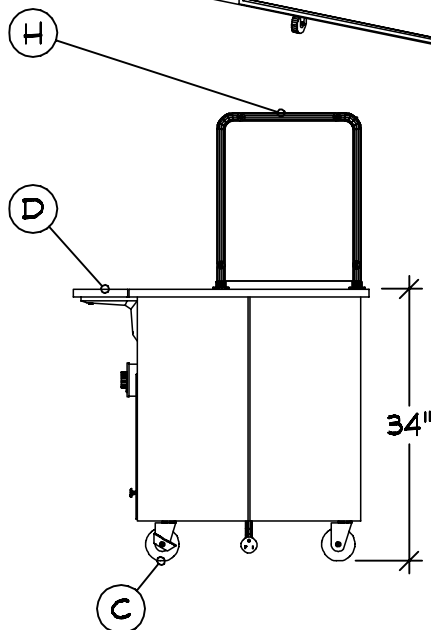
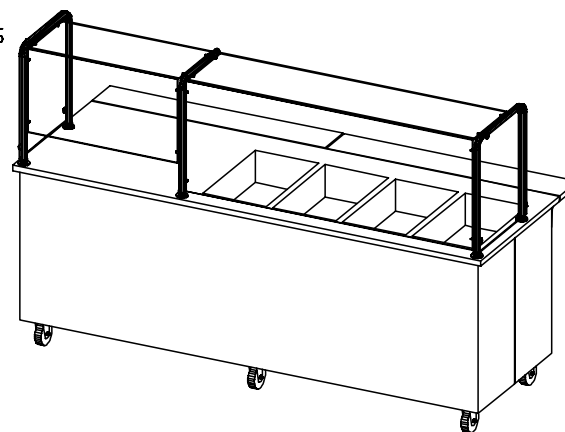
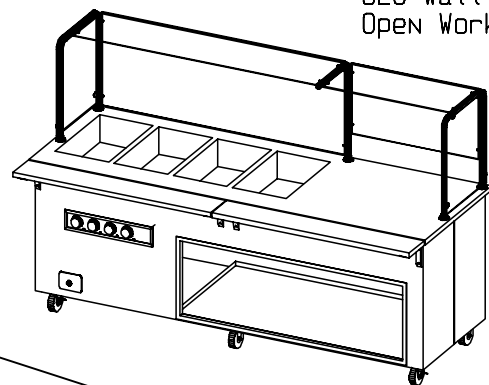

- Server 1 | Qty 1
Hot Food Counter
A Custom Configuration
B Custom Counter Width & Depth
C Casters : 4" (2) w/Brakes
D Operator Side Plate Rest w/Lift-off Bracket
E Storage Shelf w/o Doors
F Controls : Tstat Panel
G Drain : 1\2" w/ Ball Valve
H Contemporary Breath Guard

NSF Single Side Cafeteria
With Top Shelf
Full Width S-S
End Panels Both Sides
Cafeteria Style End Panels
*** Multiple Sections
*** 6" Gap 1 Section

Finishes And Materials

Top : ** 14 Ga SST
Body : ** 18 Ga SST
Trim : Standard SST
Plate Rest : 18 Ga SST
Breath Grd : Brushed SST

VOLTS 208 60 ELECTRICAL
Ø 1 12.ØA NEMA 6-15

PLUMBING CW: -
HW: -
WASTE: (1) Ø.5" INDIRECT

RVIST

RIO VISTA



THE VOLLRATH CO., LLC

Ø8-19-21

COPYRIGHT 2021
SHEBOYGAN, WI

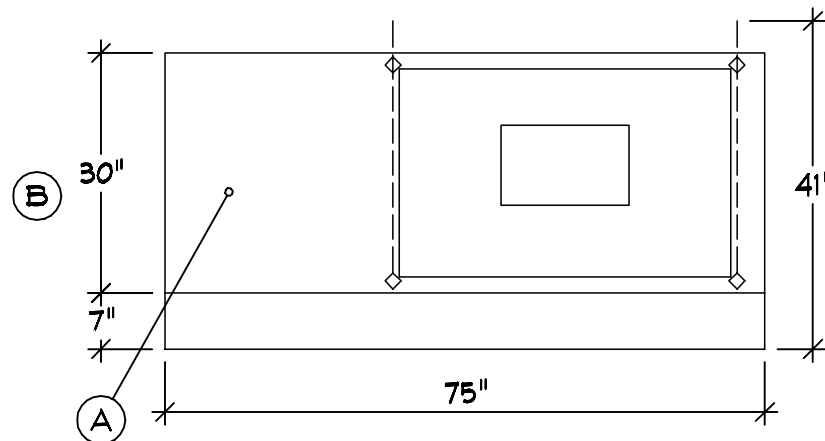
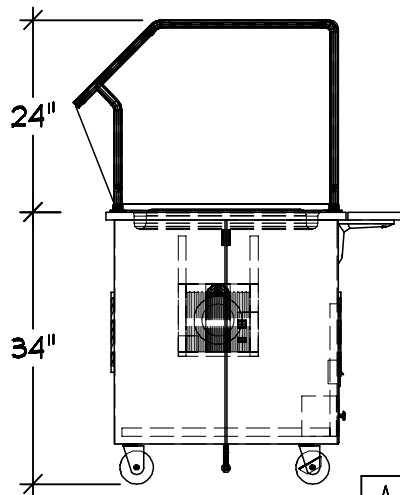

A Top Layout Operator L-R
Open Work Top
(1) 3 Pan Drop-in Frost Top

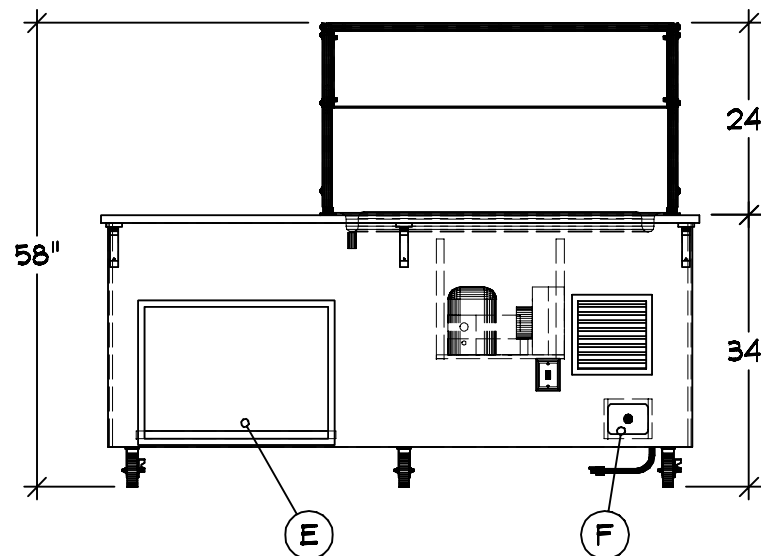
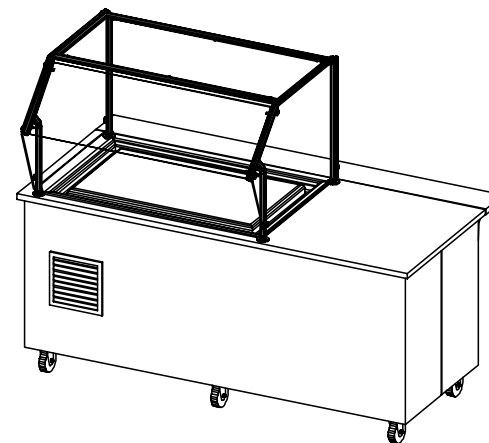
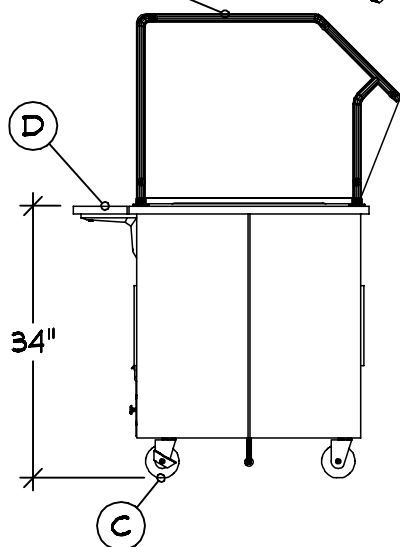
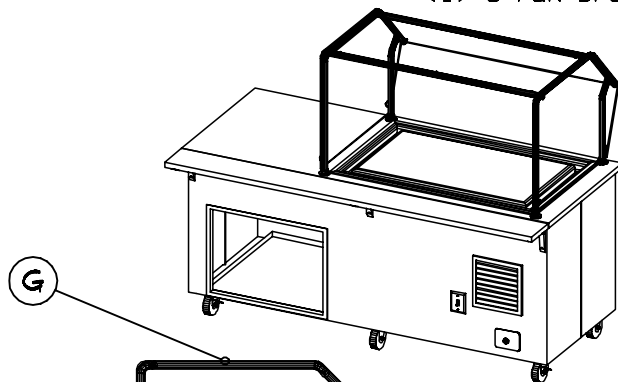

Server 2 | Qty 1
Frost Top Counter
A Custom Configuration
B Custom Counter Depth
C Casters : 4" (2) w/Brakes
D Operator Side Plate Rest
w/ Lift-off Bracket
E Storage Shelf w/o Doors
F Drain : 1½" w/ Ball Valve
G Contemporary Breath Guard
NSF Single Side Buffet
With Top Shelf
Over Food Well Only
End Panels Both Sides
Cafeteria Style End Panels

Finishes And Materials

Top : ** 14 Ga SST
Body : ** 18 Ga SST
Trim : Standard SST
Plate Rest : 18 Ga SST
Breath Grd : Brushed SST

VOLTS 120 60 ELECTRICAL
Ø 1 1/2 NEMA 5-15
7.8 A

PLUMBING CW: -
HW: -
WASTE: (1) Ø.5" INDIRECT

RVIST

RIO VISTA



THE VOLLRATH CO., LLC

08-19-21
COPYRIGHT 2021
SHEBOYGAN, WI

GENERAL NOTES - PLEASE READ

CONFIGURATION:

THESE DRAWINGS ARE TO BE USED IN CONJUNCTION WITH THE PREPARED QUOTATION AND MUST BE RECONCILED PRIOR TO RELEASE FOR FABRICATION.

DIMENSIONS:

ALL DIMENSIONS SHOWN ARE $\pm 1/4"$

CONNECTIONS:











ALL PIPING, FITTINGS, AND INTERCONNECTION SERVICES SHOWN ARE TO BE SUPPLIED AND INSTALLED BY LICENSED CONTRACTORS IN ACCORDANCE WITH ALL LOCAL CODES.

BY OTHERS:

VERIFY ALL EQUIPMENT LISTED AS BY OTHERS FOR SIZE AND MECHANICAL SERVICE REQUIREMENTS.

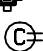
NOTE:

IN LINE WITH THE POLICY TO CONTINUALLY IMPROVE ITS PRODUCTS, THE MANUFACTURE RESERVES THE RIGHT TO CHANGE MATERIALS AND SPECIFICATIONS WITHOUT NOTICE.

	CONNECTION POINT
	COLD WATER
	HOT WATER
	HOT + COLD WATER
	DRAIN
	POWER
	SWITCH
	CORD SET
	CONV OUTLET RECP
	DUPLEX RECPTACLE
	SINGLE RECPTACLE
	REFRIGERATION



CONFIDENTIAL DESIGN

The Vollrath Company, L.L.C. ("Vollrath") considers this new design proprietary and confidential. Due to the existing relationship of trust and good faith between Vollrath and Recipient, Vollrath is providing this proprietary and confidential design and related information to Recipient with the understanding that Recipient will maintain such design and information in secrecy and will not directly or indirectly use, disseminate, or otherwise disclose this proprietary and confidential information to any outside person or organization without the express written prior consent of The Vollrath Company, L.L.C.

08-13-2021

08-13-2021 : 06:40:44a

08-19-2021 : 07:20:14a

RVIST

RIO VISTA



THE VOLLRATH CO., LLC

08-19-21

COPYRIGHT 2021
SHEBOYGAN, WI