

- ☐ APPROVED
☐ APPROVED AS NOTED

- ☐ REVISE AND RESUBMIT
☐ REJECTED

This drawing must be checked, signed, and returned before fabrication begins. Please verify all dimensions, equipment positions, finishes, breath guard mounting, and clearances.

SIGNATURE _____ DATE _____

The designs, drawings, renderings, and other documents ("Designs") furnished by The Vollrath Company, L.L.C. ("Vollrath") to you (including anything in electronic format), are owned by Vollrath, its licensors or other providers of those materials and are protected by United States and international copyright, trademark, patent, trade secret, and other intellectual property or proprietary rights laws, as applicable. The Designs may not be duplicated, reproduced, modified, or distributed, without the express written consent of Vollrath. All Designs prepared by Vollrath are provided to you on a confidential basis unless agreed otherwise in writing by Vollrath.

You may not use the Designs for any purpose unless you engage Vollrath to complete the design and construction in accordance with the Design and then only for the purpose of completing the design and construction. It is illegal to reproduce, duplicate, modify, resell, redistribute, lease, loan, or develop derivative work, in whole or in part, from the Designs without the express written consent of Vollrath.

VOLLRATH[®]

1236 N. 18th Street
Sheboygan, WI 53081

vollrathfoodservice.com

REVISIONS

NO.	DESCRIPTION	DATE

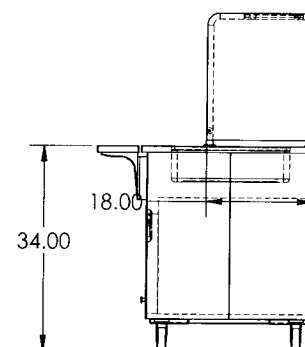
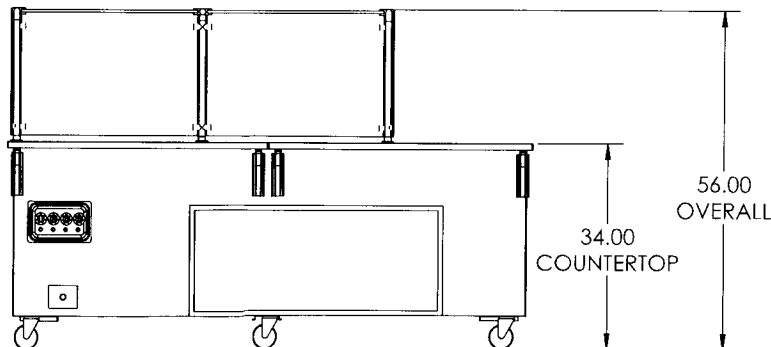
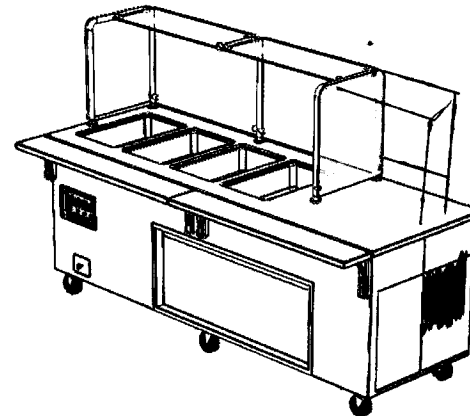
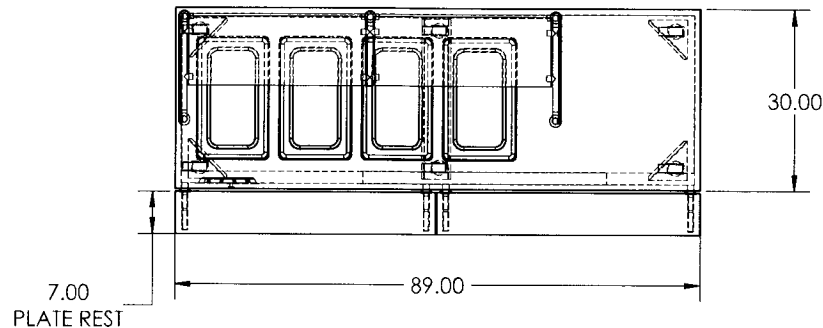

EXTEND GUARD!
PROVIDE 6" CLEARANCE f/
TRAY PASS

Pendergast Rio
Vista

4/3

PROJECT NUMBER	C-12428
DATE	5/27/2021
SCALE	NTS
DRAWN BY	Robert Tully
SHEET TITLE	VOLLRATH PLAN, FRONT, SIDE
SHEET NUMBER	1 of 1

EQUIPMENT 1	EQUIPMENT 2	EQUIPMENT 3	UNIT VOLTS	UNIT AMPS	UNIT PLUG	BASE FINISH	BASE COLOR
HOT_STEAM	UTILITY_SPACE	NONE	208	12	NEMA 6-15P	BRUSHED STAINLESS	0

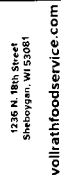
[illegible]

Pendergast Rio Vista

C-12428

ERLEFORS E.

5/27/2021

SCALE

NTS

TRANSMIT

Robert Tully

11

**VOLLRATH
PLAN, FRONT,
SIDE**

1 of 1

The designs, drawings, renderings, and other documents ("Designs") furnished by The Vollath Company, L.L.C. ("Vollath") to you (including anything in electronic format), are owned by Vollath, and all rights therein will remain with Vollath. All Designs are provided to you under license from Vollath. All Designs prepared by Vollath are provided to you as confidential information and may contain trade secrets or other intellectual property or proprietary information of Vollath or its licensors or other providers of those materials and are protected by United States and international copyright, trademark, patent, trade secret, and other intellectual property or proprietary rights laws, as applicable. The Designs may not be duplicated, reproduced, modified, or distributed without the express written consent of Vollath. All Designs prepared by Vollath are provided to you on a confidential basis unless agreed otherwise in writing by Vollath.

You may not use the Designs for any purpose unless you engage Vollrath to complete the design and construction in accordance with the Design and then only for the purpose of completing the design and construction. It is illegal to produce, duplicate, modify, resell, redistribute, lease, loan, or develop derivative work, in whole or in part, from the Designs without the express written consent of Vollrath.

☐ **APPROVED**
☐ **REVISE AND RESUBMIT**
☐ **APPROVED AS NOTED**
☐ **REJECTED**

This drawing must be checked, signed, and returned before fabrication begins. Please verify all dimensions, equipment positions, finishes, breath guard mounting, and clearances.

SIGNATURE _____ DATE _____

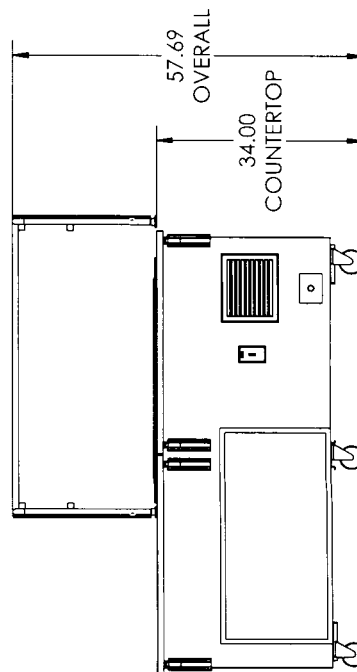
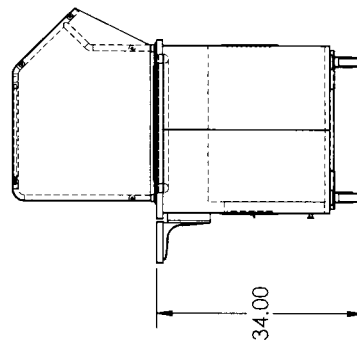
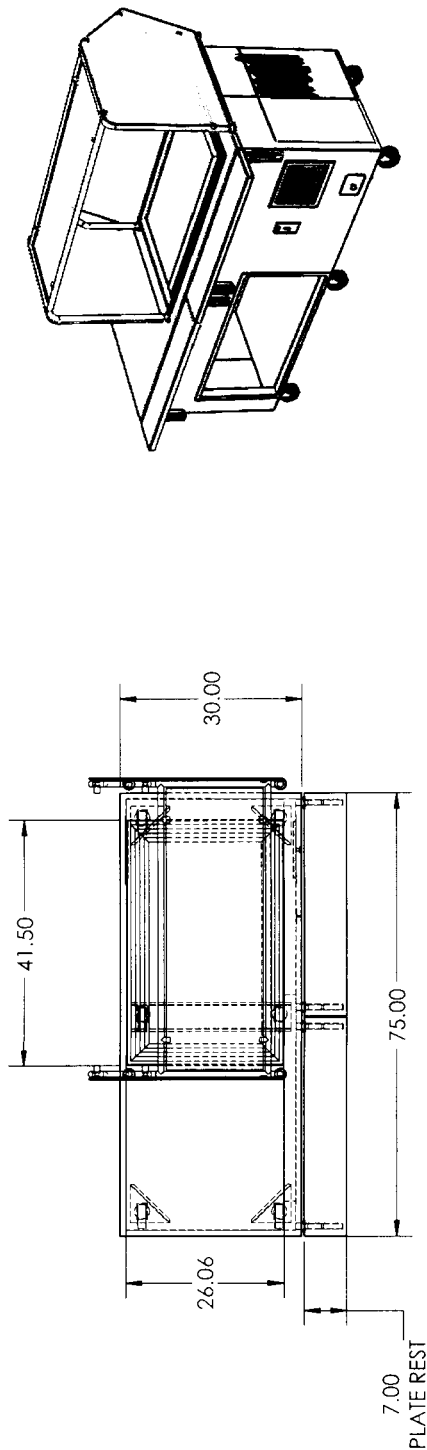

EQUIPMENT_1	EQUIPMENT_2	EQUIPMENT_3	UNIT_VOLTS	UNIT_AMPS	UNIT_PLUG	BASE_FINISH	BASE_COLOR
UTILITY_SPACE	COLD_FROST	NONE	120	7.8	NEMA 5-15P	BRUSHED STAINLESS	0

THIS DOCUMENT WAS ORIGINALLY CREATED ON A 11" x 17" SIZE SHEET

© 2020 The Vollrath Company, L.L.C. All Rights Reserved