

Server 37 1 Qty 2  
Utility Counter  
A Custom Configuration  
B Custom Counter Depth  
C Casters : 4" (2) w/Brakes

A Top Layout Operator L-R  
Top Cutout By Vollrath  
(1) Dropin Tray Dispenser  
Delfield LT2-1014  
Supplied And Installed By Others

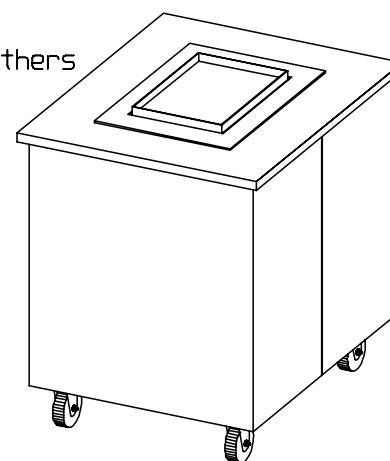

Finishes And Materials  
Top : \*\* 14 Ga SST  
Body : \*\* 18 Ga SST  
Trim : Standard SST

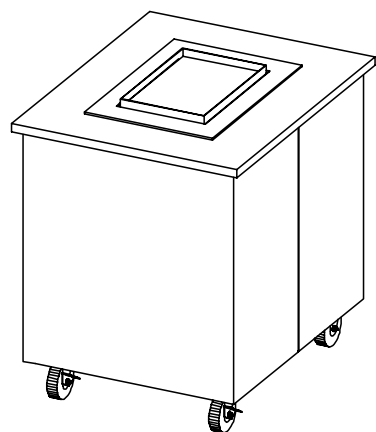
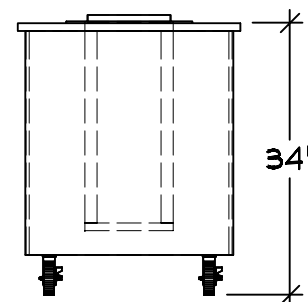
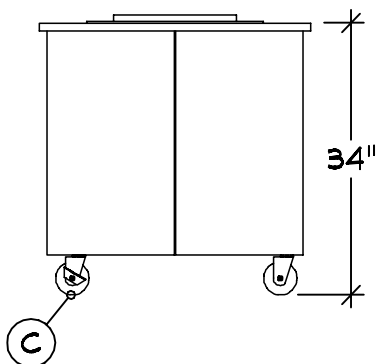

PRKES

PARK ELEMENTRY



07-28-21

COPYRIGHT 2021

THE VOLLRATH CO., LLC

SHEBOYGAN, WI

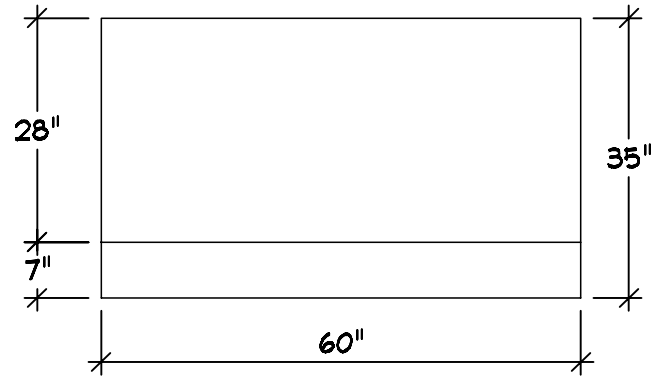
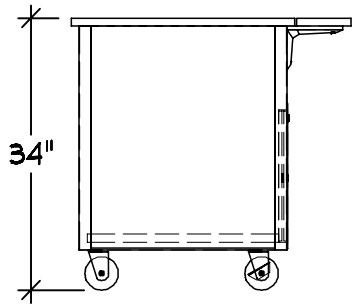

Server 38 1 Qty 1  
Utility Counter  
A Casters : 4" (2) w/Brakes  
B Operator Side Plate Rest  
w/ Lift-off Bracket  
C Storage Shelf w/ Bypass  
Doors And Lock

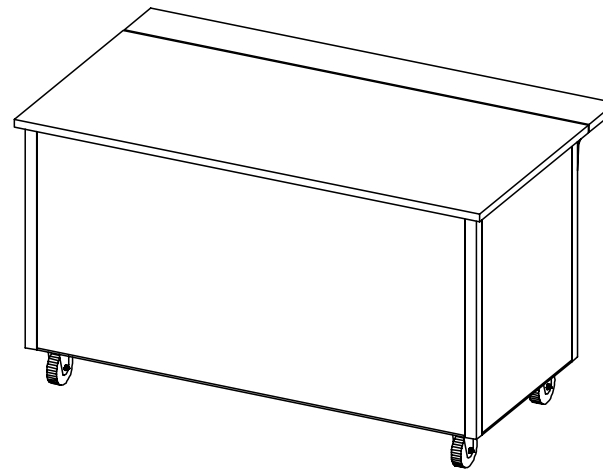
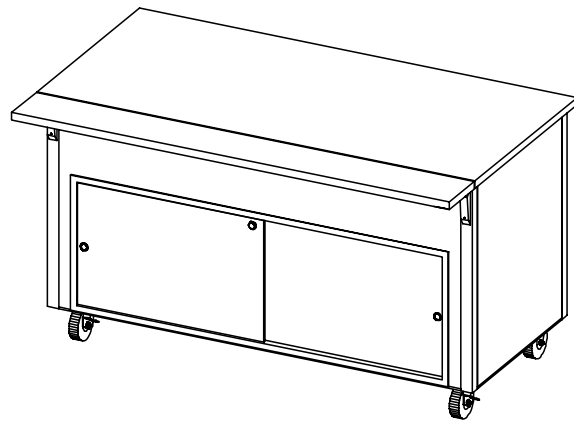

Finishes And Materials  
Top : \*\* 14 Ga SST  
Body : Laminate TBD  
Trim : Standard SST  
Plate Rest : 18 Ga SST  
Storage Door: To Match Base

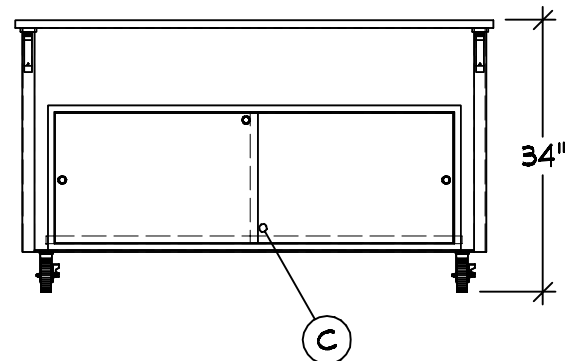
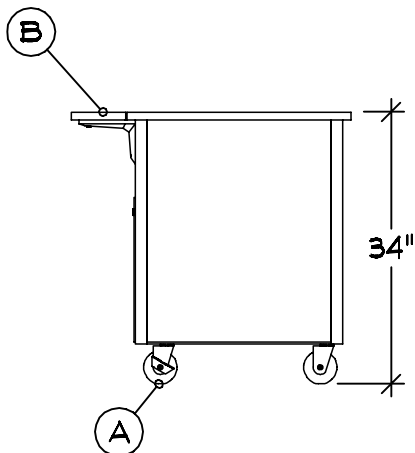

PRKES

PARK ELEMENTRY



THE VOLLRATH CO., LLC

07-28-21

COPYRIGHT 2021  
SHEBOYGAN, WI

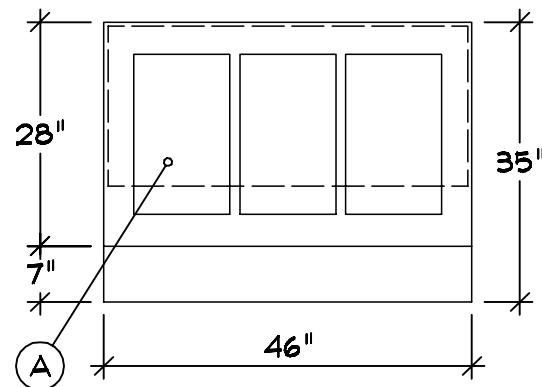
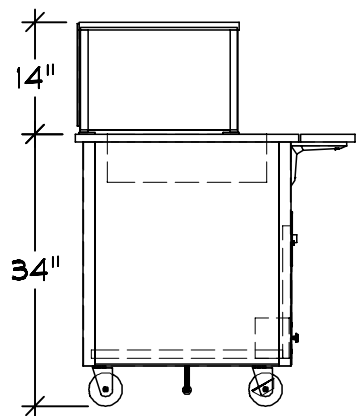

Server 39 1 Qty 1  
 Hot Food Counter  
 A 3 Individual Wet Hot Wells  
 B Casters : 4" (2) w/Brakes  
 C Operator Side Plate Rest  
 w/ Lift-off Bracket  
 D Storage Shelf w/o Doors  
 E Controls : Infinite Dial  
 F Drain : 1½" w/ Ball Valve  
 G Classic Breath Guard  
 NSF Single Side Cafeteria  
 Single Deck  
 Full Width S-S  
 End Panels Both Sides

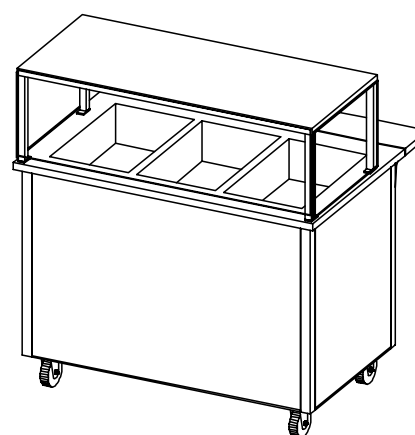
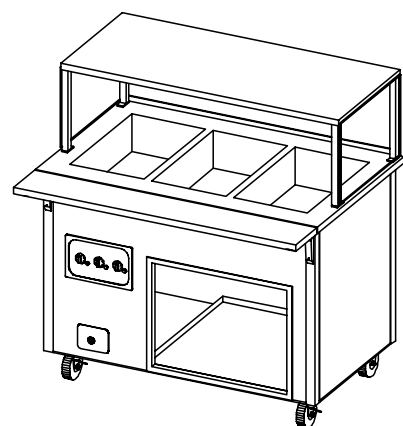

Finishes And Materials  
 Top : \*\* 14 Ga SST  
 Body : Laminate TBD  
 Trim : Standard SST  
 Plate Rest : 18 Ga SST  
 Breath Grd : Polished SST

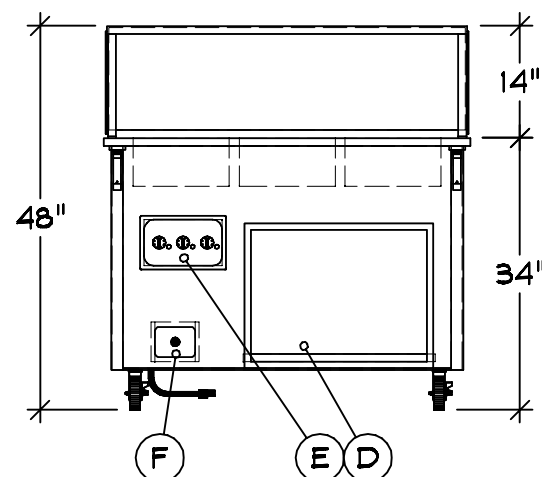
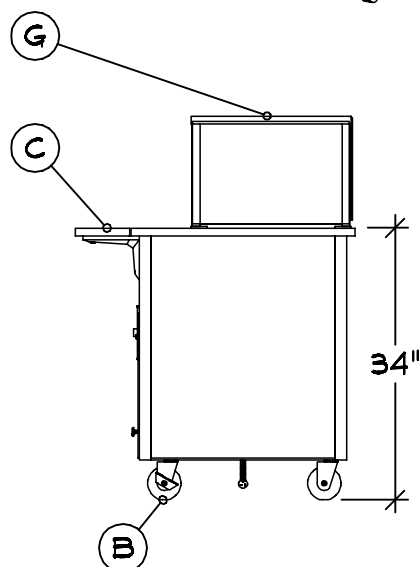

VOLTS 208 60 ELECTRICAL  
 Ø 1 - - NEMA 6-15  
 9.0A

PLUMBING CW: -  
 HW: -  
 WASTE: (1) Ø.5" INDIRECT

PRKES

PARK ELEMENTRY



07-28-21

COPYRIGHT 2021  
 SHEBOYGAN, WI

THE VOLLRATH CO., LLC



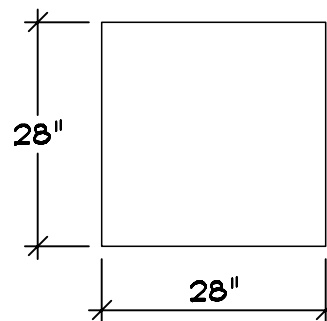
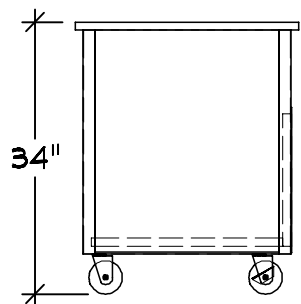

Server 40 : Qty 1  
 Utility Counter  
 A Casters : 4" (2) w/Brakes  
 B Storage Shelf w/o Doors

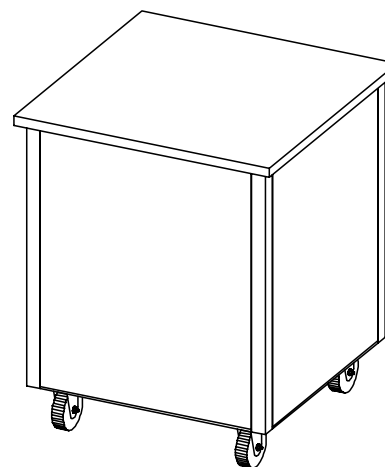
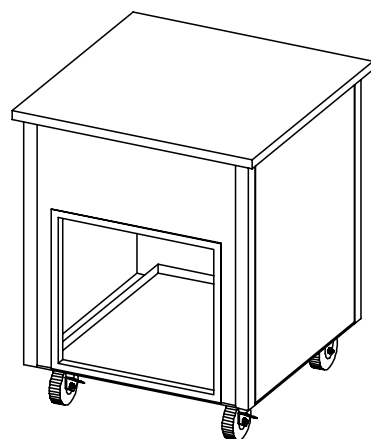

#### Finishes And Materials

Top : \*\* 14 Ga SST

Body : Laminate TBD

Trim : Standard SST

Storage Door : Polished SST

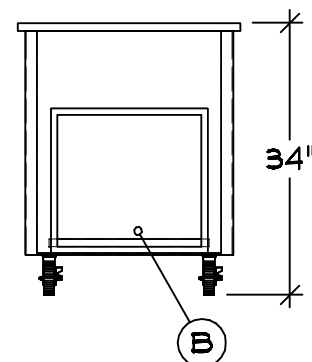
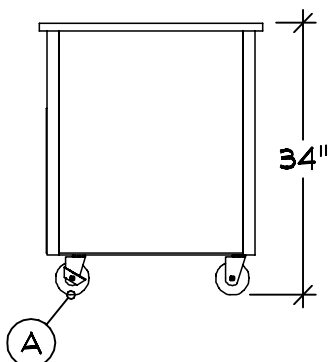

PRKES

PARK ELEMENTRY



07-28-21

COPYRIGHT 2021

THE VOLLRATH CO., LLC

SHEBOYGAN, WI

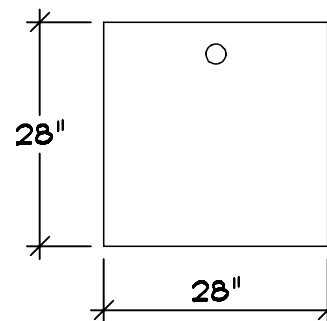
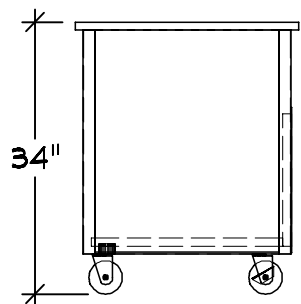

Server 41 : Qty 1  
 Cashier Station  
 A Casters : 4" (2) w/Brakes  
 B Storage Shelf w/o Doors

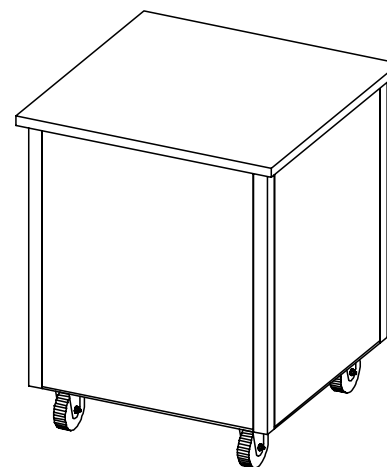
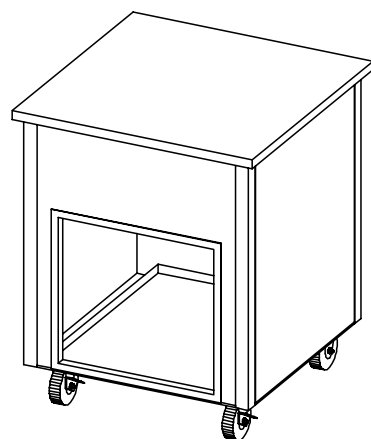

Finishes And Materials  
 Top : \*\* 14 Ga SST  
 Body : Laminate TBD  
 Trim : Standard SST

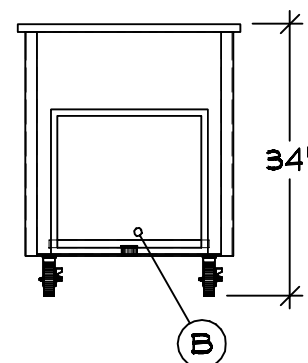
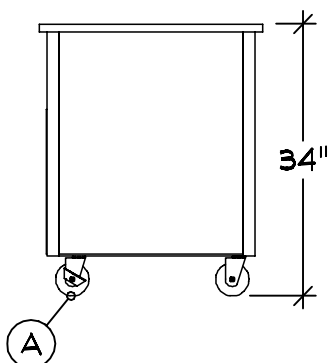

PRKES

PARK ELEMENTRY



07-28-21

COPYRIGHT 2021

THE VOLLRATH CO., LLC

SHEBOYGAN, WI

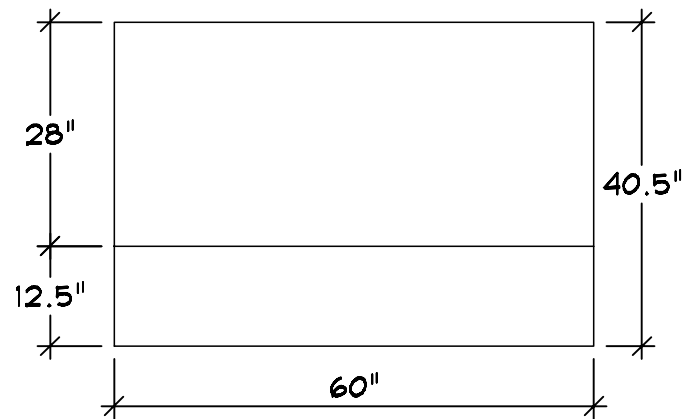
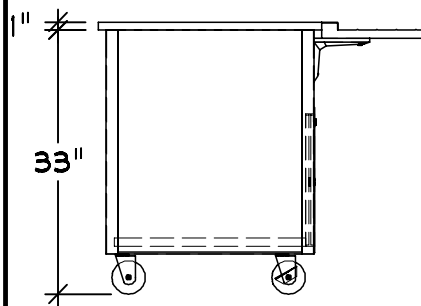

Server 42 1 Qty 1  
 Utility Counter  
 A Casters : 4" (2) w/Brakes  
 B Service Side V Rib Tray  
 Slide w/ Lift-off Brackets  
 C Storage Shelf w/ Bypass  
 Doors And Lock  
 D Wall Installation, Service  
 Side Access Required

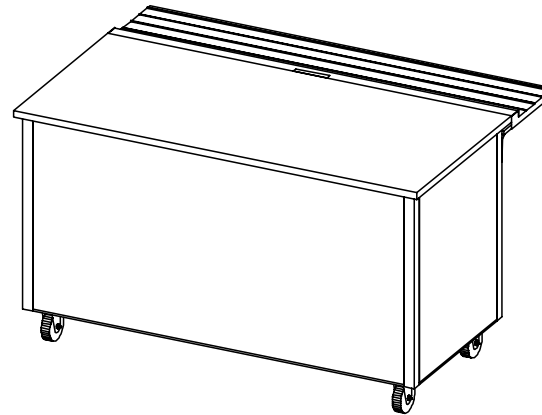
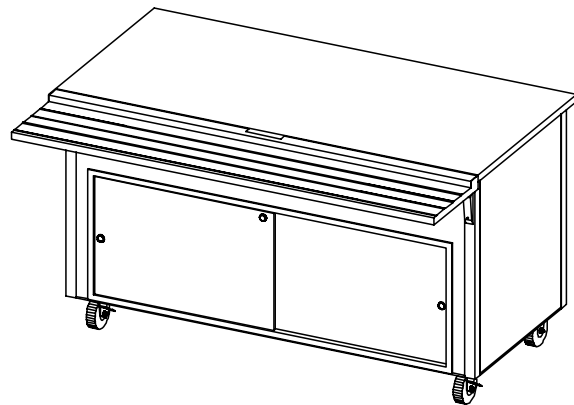

Finishes And Materials  
 Top : \*\* 14 Ga SST  
 Body : Laminate TBD  
 Trim : Standard SST  
 Tray Rail : 18 Ga SST

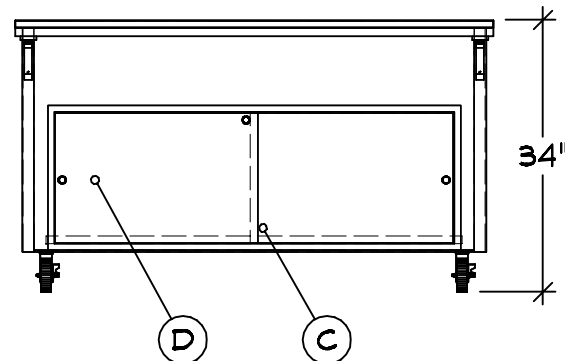
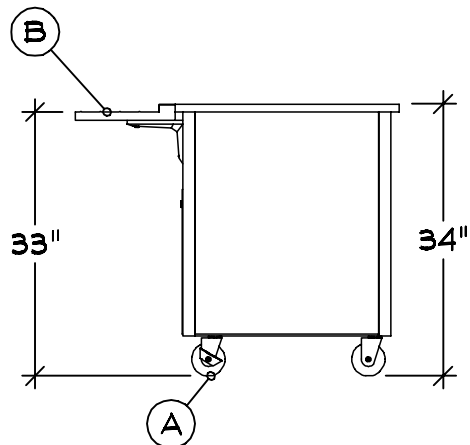

PRKES

PARK ELEMENTRY



07-28-21

THE VOLLRATH CO., LLC

COPYRIGHT 2021  
 SHEBOYGAN, WI

## GENERAL NOTES - PLEASE READ

### CONFIGURATION:

THESE DRAWINGS ARE TO BE USED IN CONJUNCTION WITH THE PREPARED QUOTATION AND MUST BE RECONCILED PRIOR TO RELEASE FOR FABRICATION.

### DIMENSIONS:

ALL DIMENSIONS SHOWN ARE  $\pm 1/4"$

### CONNECTIONS:











ALL PIPING, FITTINGS, AND INTERCONNECTION SERVICES SHOWN ARE TO BE SUPPLIED AND INSTALLED BY LICENSED CONTRACTORS IN ACCORDANCE WITH ALL LOCAL CODES.

### BY OTHERS:

VERIFY ALL EQUIPMENT LISTED AS BY OTHERS FOR SIZE AND MECHANICAL SERVICE REQUIREMENTS.

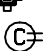
### NOTE:

IN LINE WITH THE POLICY TO CONTINUALLY IMPROVE ITS PRODUCTS, THE MANUFACTURE RESERVES THE RIGHT TO CHANGE MATERIALS AND SPECIFICATIONS WITHOUT NOTICE.

	CONNECTION POINT
	COLD WATER
	HOT WATER
	HOT + COLD WATER
	DRAIN
	POWER
	SWITCH
	CORD SET
	CONV OUTLET RECP
	DUPLEX RECPTACLE
	SINGLE RECPTACLE
	REFRIGERATION



## CONFIDENTIAL DESIGN

The Vollrath Company, L.L.C. ("Vollrath") considers this new design proprietary and confidential. Due to the existing relationship of trust and good faith between Vollrath and Recipient, Vollrath is providing this proprietary and confidential design and related information to Recipient with the understanding that Recipient will maintain such design and information in secrecy and will not directly or indirectly use, disseminate, or otherwise disclose this proprietary and confidential information to any outside person or organization without the express written prior consent of The Vollrath Company, L.L.C.

07-27-2021

07-27-2021 : 09:17:13a

07-27-2021 : 09:18:21a

07-28-2021 : 01:01:02p

PRKES

PARK ELEMENTRY



THE VOLLRATH CO., LLC

07-28-21

COPYRIGHT 2021  
SHEBOYGAN, WI