

Server 1 | Qty 1
 Tray Counter
 A Casters : 4* (2) w/Brakes
 B SST Upper Shelf
 C SST Lower Shelf
 D (6) Flatware Cylinders

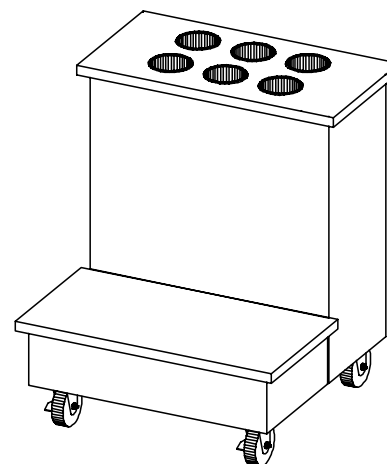

Finishes And Materials
 Top : 16 Ga SST
 Body : ** 18 Ga SST
 Trim : Standard SST

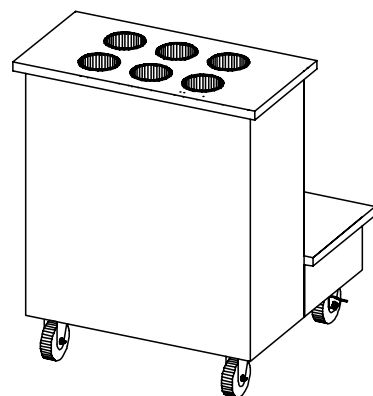
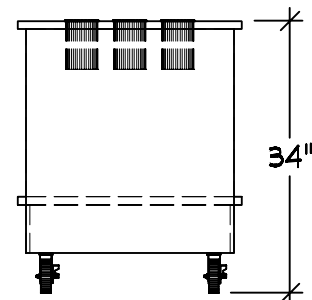
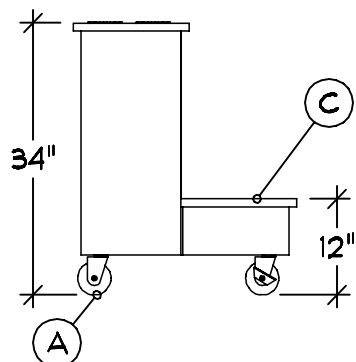

PORTR

PORTER ELEMENTARY



07-29-21

COPYRIGHT 2021

THE VOLLRATH CO., LLC

SHEBOYGAN, WI

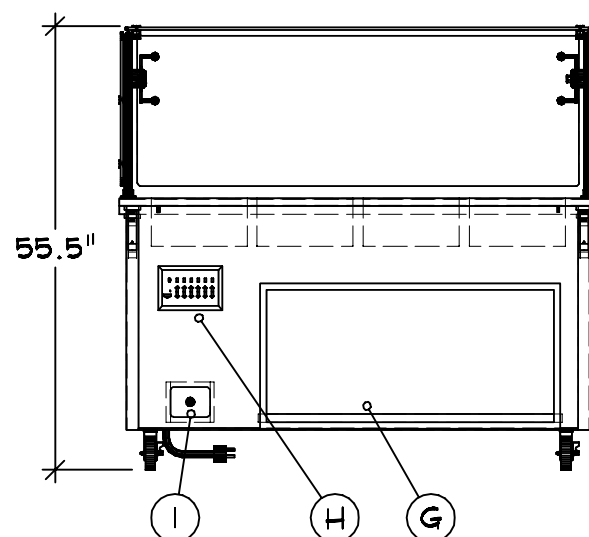
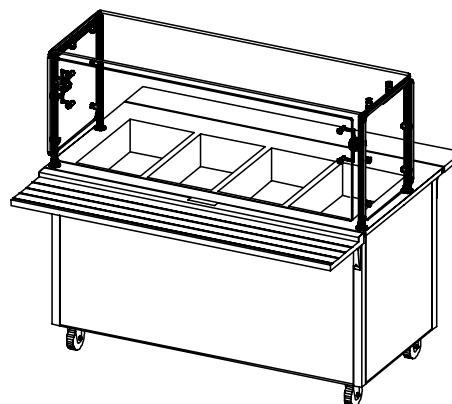
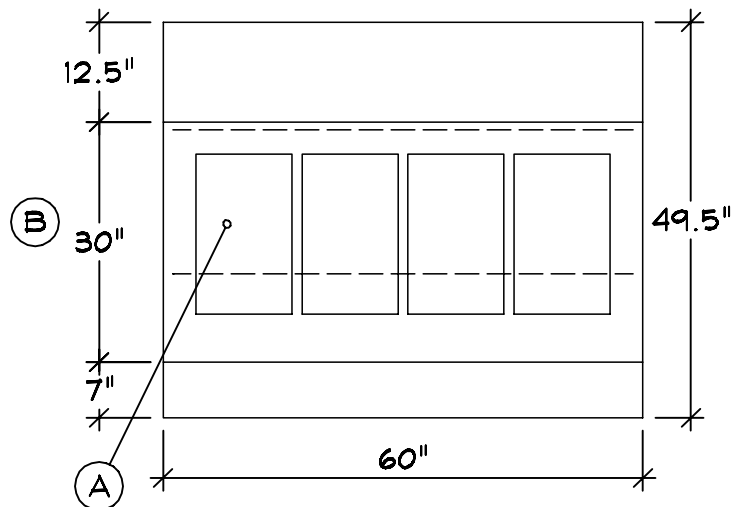
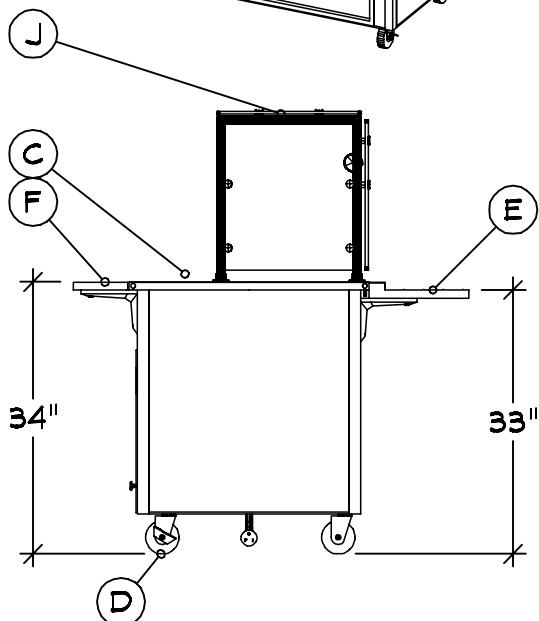
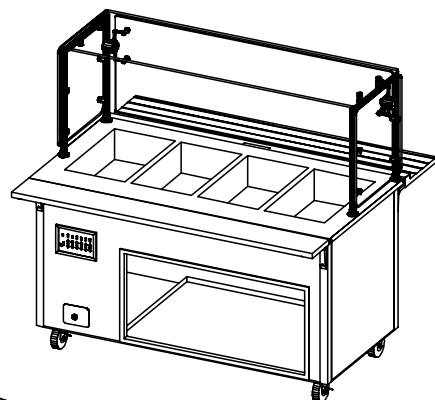
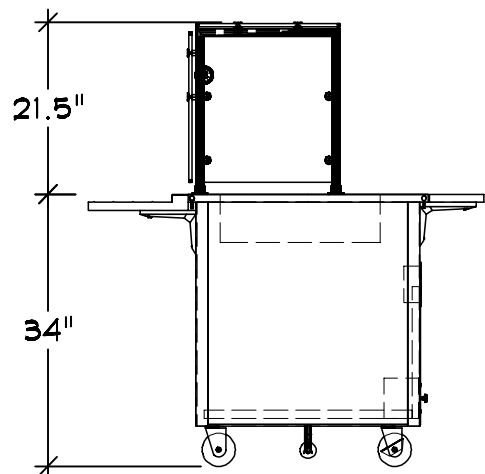

Server 2 | Qty 1
 Hot Food Counter
 A 4 Individual Wet Hot Wells
 B Custom Counter Depth
 C Line Up Locks
 D Casters : 4" (2) w/Brakes
 E Customer Side V Rib Tray
 Slide w/ Lift-off Brackets
 F Operator Side Plate Rest
 w/ Lift-off Bracket
 G Storage Shelf w/o Doors
 H Controls : Touch Temp
 I Drain : 1\2" w/ Ball Valve
 J Velocity Breath Guard

NSF Single Side Cafeteria
 Full Width S-S
 Adjustable Front Panel
 LED Light Strip
 On Board Switch
 Cafeteria Style End Panels
 Both Sides

Finishes And Materials

Top : ** 14 Ga SST
 Body : Laminate TBD
 Trim : Standard SST
 Tray Rail : 18 Ga SST
 Plate Rest : 18 Ga SST
 Breath Grd : Brushed SST

VOLTS 120
 20.9 A
 ELECTRICAL
 NEMA 5-30

PLUMBING CW: -
 HW: -
 WASTE: (1) 0.5" INDIRECT

PORTR

PORTER ELEMENTARY



07-29-21

COPYRIGHT 2021
 SHEBOYGAN, WI

THE VOLLRATH CO., LLC

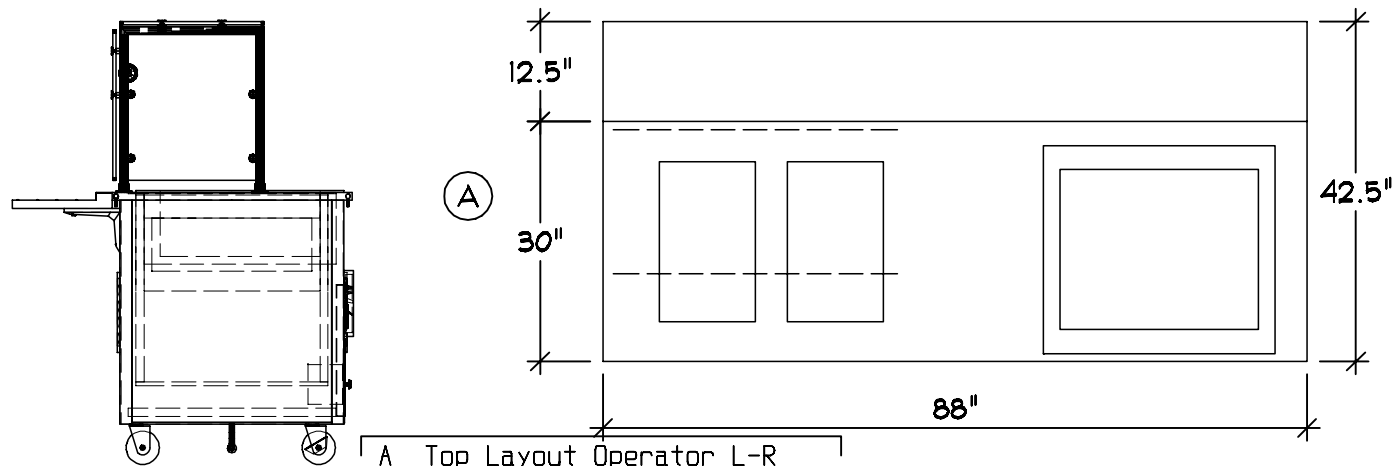

A Top Layout Operator L-R

- (1) 2 Pan Combination Hot/Cold Well Drop-In
- Open Work Top
- (1) 2 Pan Drop-In Iced Cold Well

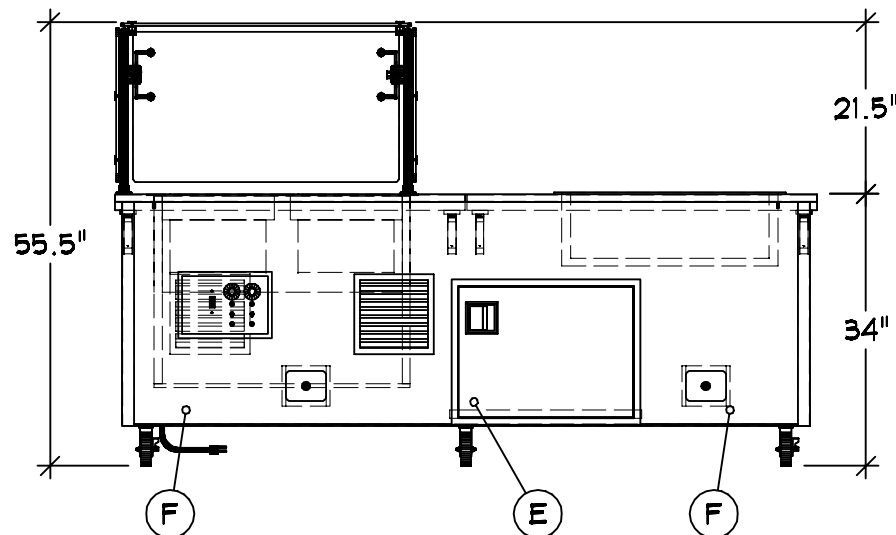
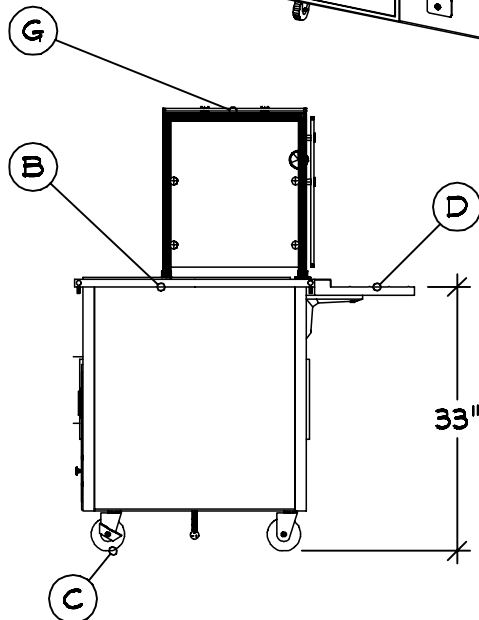
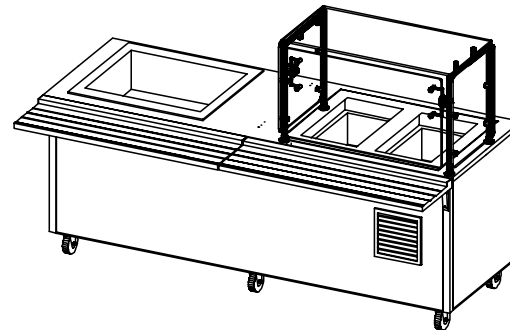
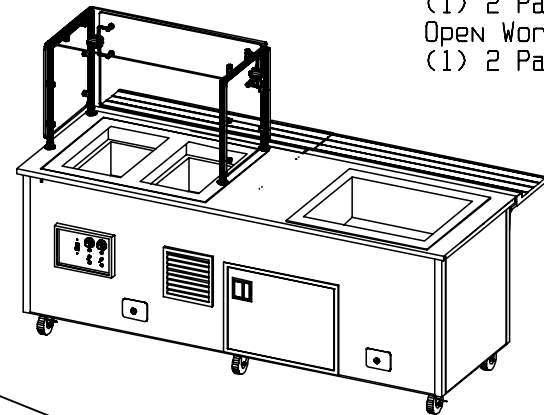

- Server 3 | Qty 1
- Utility Counter
- A Custom Counter Depth
- B Line Up Locks
- C Casters : 4" (2) w/Brakes
- D Customer Side V Rib Tray
- Slide w/ Lift-off Brackets
- E Storage Shelf w/ Hinged
- Doors And Lock
- F Drain : 1 1/2" w/ Ball Valve
- G Velocity Breath Guard

NSF Single Side Cafeteria
Over Hot/Cold Well Only
Adjustable Front Panel
LED Light Strip
On Board Switch
Cafeteria Style End Panels
Both Sides

Finishes And Materials

Top : ** 14 Ga SST
Body : Laminate TBD
Trim : Standard SST
Tray Rail : 18 Ga SST
Plate Rest : 18 Ga SST
Breath Grd : Brushed SST

VOLTS 120
Ø 1
10.5 A

60
1/2
1

ELECTRICAL
NEMA 5-15

PLUMBING CW: -
HW: -
WASTE: (2) Ø.5" INDIRECT

PORTR

PORTER ELEMENTARY



07-29-21

COPYRIGHT 2021

THE VOLLRATH CO., LLC

SHEBOYGAN, WI

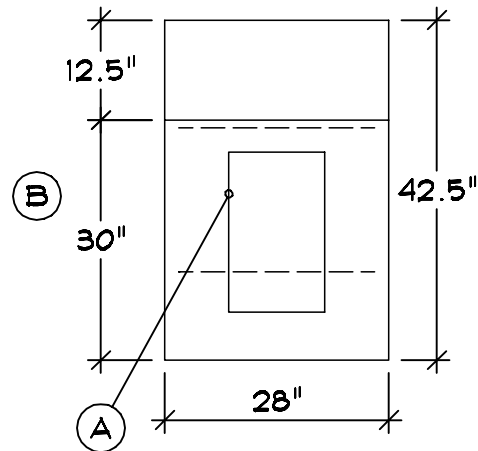
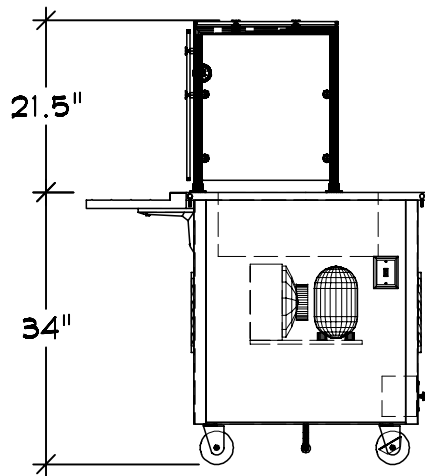

Server 4 | Qty 1
 Cold Food Counter
 A Custom Configuration
 B Custom Counter Depth
 C Line Up Locks
 D Casters : 4" (2) w/Brakes
 E Customer Side V Rib Tray
 Slide w/ Lift-off Brackets
 F Drain : 1\2" w/ Ball Valve
 G Velocity Breath Guard

NSF Single Side Cafeteria
 Over Hot/Cold Well Only
 Adjustable Front Panel
 LED Light Strip
 On Board Switch
 Cafeteria Style End Panels
 Both Sides

A Top Layout Operator L-R
 (1) 1 Pan Integrated Cold Well - Centered

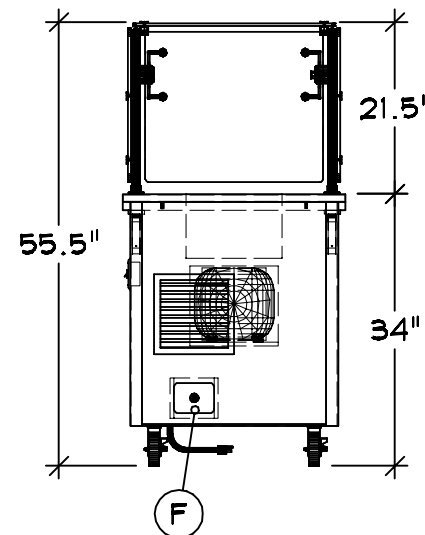
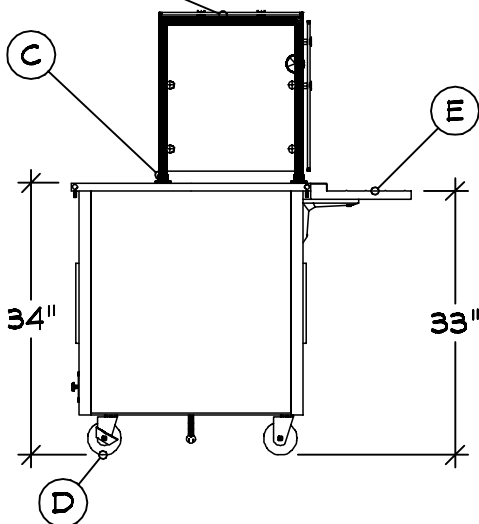
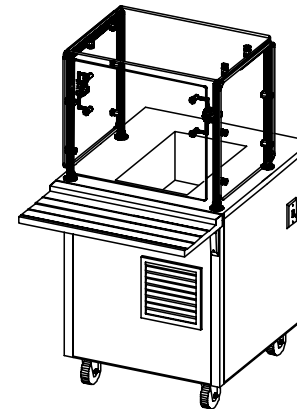
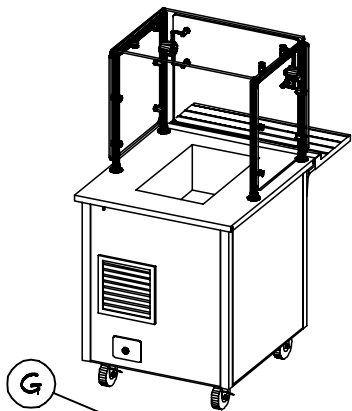

Finishes And Materials

Top : ** 14 Ga SST
 Body : Laminate TBD
 Trim : Standard SST
 Tray Rail : 18 Ga SST
 Plate Rest : 18 Ga SST
 Breath Grd : Brushed SST

VOLTS	120		ELECTRICAL NEMA 5-15
Ø	1 3.5 A		

PLUMBING	CW: - HW: -
WASTE:	(1) Ø.5" INDIRECT

PORTR

PORTER ELEMENTARY



07-29-21

COPYRIGHT 2021

THE VOLLRATH CO., LLC

SHEBOYGAN, WI

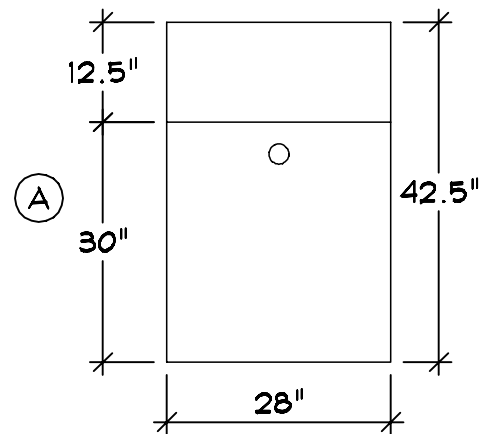
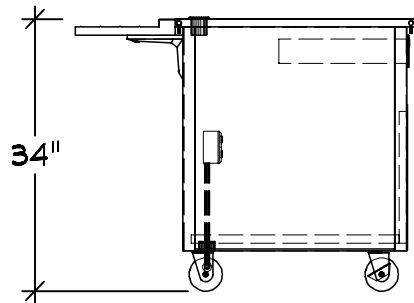

Server 5 | Qty 1
 Cashier Station
 A Custom Counter Depth
 B Line Up Locks
 C Casters : 4" (2) w/Brakes
 D Customer Side V Rib Tray
 Slide w/ Lift-off Brackets
 E Storage Shelf w/o Doors
 F Cash Drawer
 G Receptacle And Cord
 Grommet

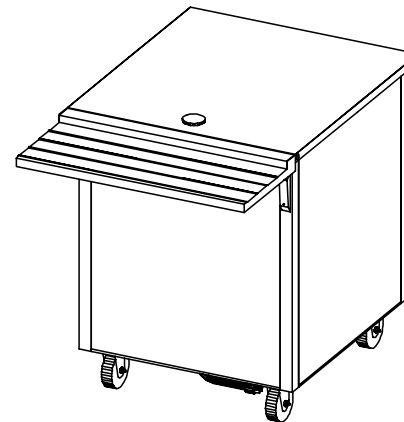
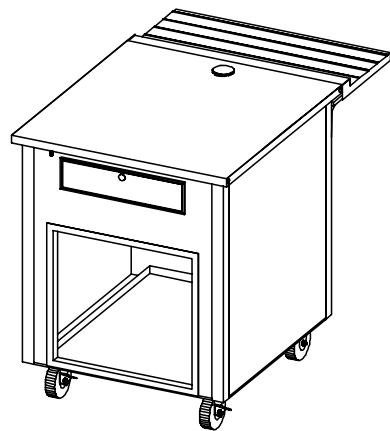

Finishes And Materials
 Top : 16 Ga SST
 Body : Laminate TBD
 Trim : Standard SST
 Tray Rail : 18 Ga SST

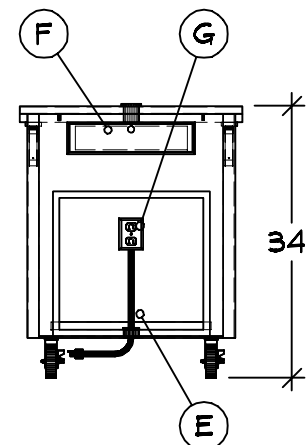
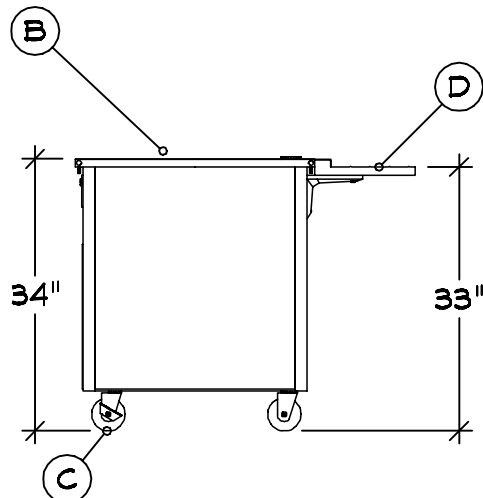

VOLTS	120	60	ELECTRICAL NEMA 5-15
Ø	1	W	
10.0 Max A			

PORTR

PORTER ELEMENTARY



07-29-21
 COPYRIGHT 2021
 SHEBOYGAN, WI

THE VOLLRATH CO., LLC

GENERAL NOTES - PLEASE READ

CONFIGURATION:

THESE DRAWINGS ARE TO BE USED IN CONJUNCTION WITH THE PREPARED QUOTATION AND MUST BE RECONCILED PRIOR TO RELEASE FOR FABRICATION.

DIMENSIONS:

ALL DIMENSIONS SHOWN ARE $\pm 1/4"$

CONNECTIONS:











ALL PIPING, FITTINGS, AND INTERCONNECTION SERVICES SHOWN ARE TO BE SUPPLIED AND INSTALLED BY LICENSED CONTRACTORS IN ACCORDANCE WITH ALL LOCAL CODES.

BY OTHERS:

VERIFY ALL EQUIPMENT LISTED AS BY OTHERS FOR SIZE AND MECHANICAL SERVICE REQUIREMENTS.

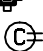
NOTE:

IN LINE WITH THE POLICY TO CONTINUALLY IMPROVE ITS PRODUCTS, THE MANUFACTURE RESERVES THE RIGHT TO CHANGE MATERIALS AND SPECIFICATIONS WITHOUT NOTICE.

	CONNECTION POINT
	COLD WATER
	HOT WATER
	HOT + COLD WATER
	DRAIN
	POWER
	SWITCH
	CORD SET
	CONV OUTLET RECP
	DUPLEX RECPTACLE
	SINGLE RECPTACLE
	REFRIGERATION



CONFIDENTIAL DESIGN

The Vollrath Company, L.L.C. ("Vollrath") considers this new design proprietary and confidential. Due to the existing relationship of trust and good faith between Vollrath and Recipient, Vollrath is providing this proprietary and confidential design and related information to Recipient with the understanding that Recipient will maintain such design and information in secrecy and will not directly or indirectly use, disseminate, or otherwise disclose this proprietary and confidential information to any outside person or organization without the express written prior consent of The Vollrath Company, L.L.C.

07-23-2021

07-27-2021 : 06:53:52a

07-29-2021 : 09:13:08a

PORTR

PORTER ELEMENTARY



THE VOLLRATH CO., LLC

07-29-21

COPYRIGHT 2021
SHEBOYGAN, WI