

Server 37 1 Qty 2
 Utility Counter
 A Custom Counter Depth
 B Casters : 4" (2) w/Brakes

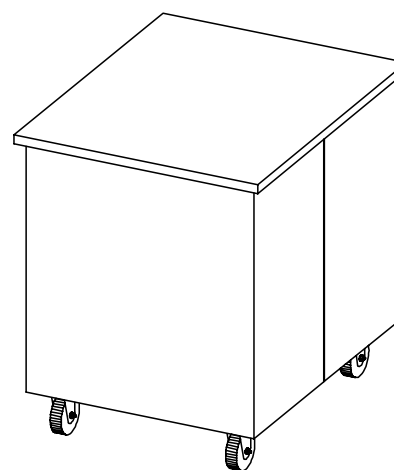

Finishes And Materials
 Top : ** 14 Ga SST
 Body : ** 18 Ga SST
 Trim : Standard SST

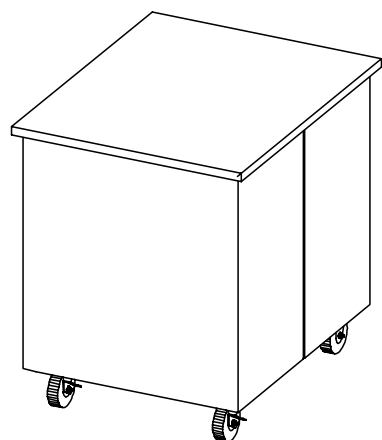
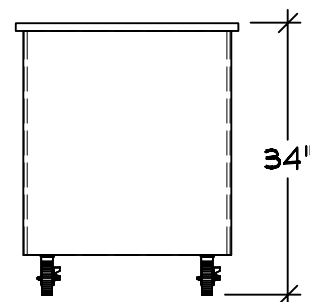
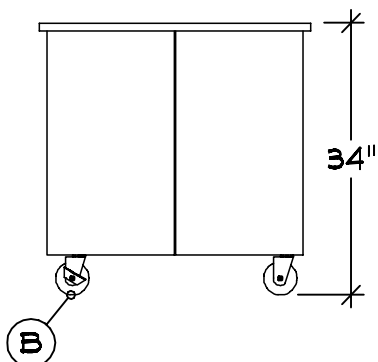

MERRY

MERRYMAN ELEM



THE VOLLRATH CO., LLC

08-06-21
 COPYRIGHT 2021
 SHEBOYGAN, WI

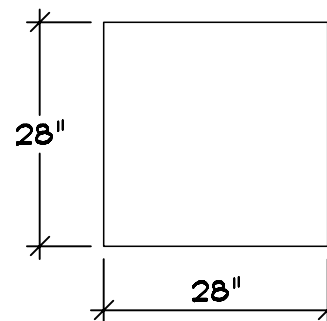
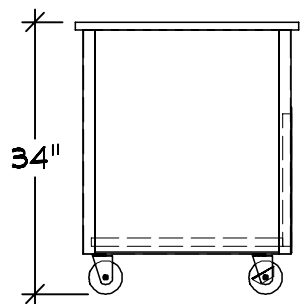

Server 38 1 Qty 2
 Utility Counter
 A Casters : 4" (2) w/Brakes
 B Storage Shelf w/o Doors

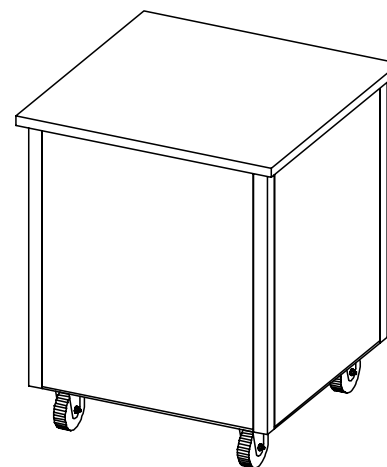
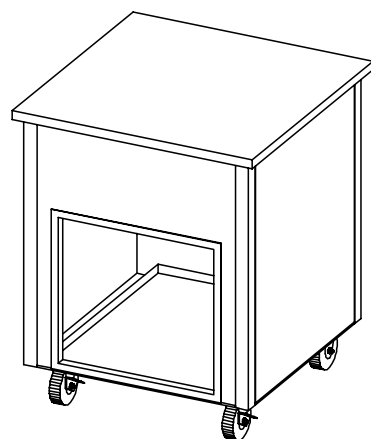

Finishes And Materials
 Top : ** 14 Ga SST
 Body : Laminate TBD
 Trim : Standard SST

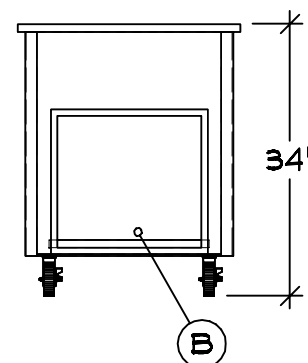
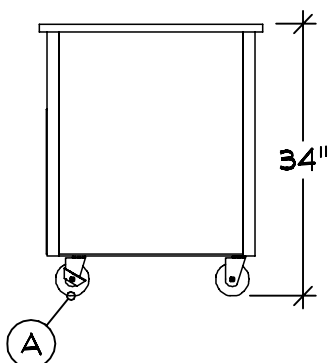

MERRY

MERRYMAN ELEM



THE VOLLRATH CO., LLC

08-06-21
 COPYRIGHT 2021
 SHEBOYGAN, WI

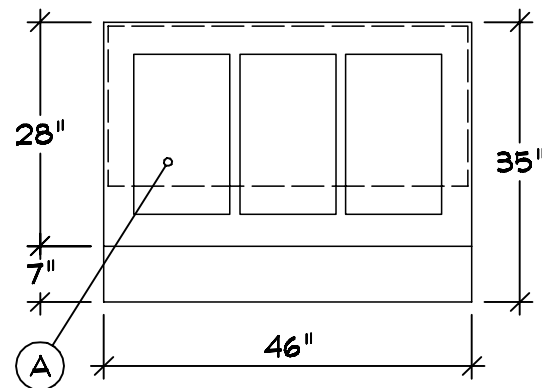
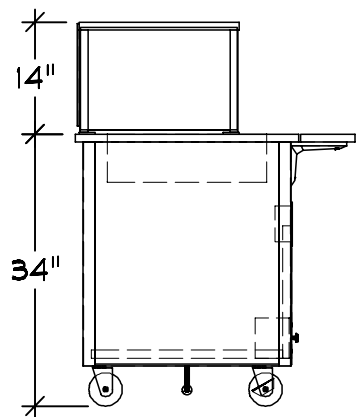

Server 39 1 Qty 1
 Hot Food Counter
 A 3 Individual Wet Hot Wells
 B Casters : 4" (2) w/Brakes
 C Operator Side Plate Rest
 w/ Lift-off Bracket
 D Storage Shelf w/o Doors
 E Controls : Touch Temp
 F Drain : 1½" w/ Ball Valve
 G Classic Breath Guard
 NSF Single Side Cafeteria
 Single Deck
 Full Width S-S
 End Panels Both Sides

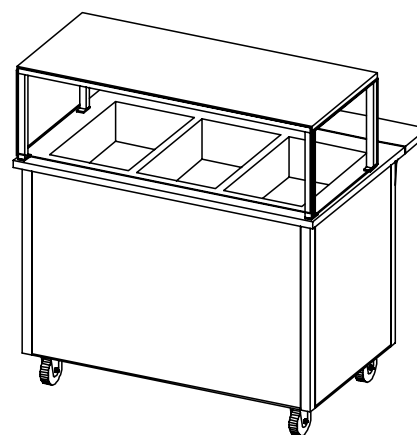
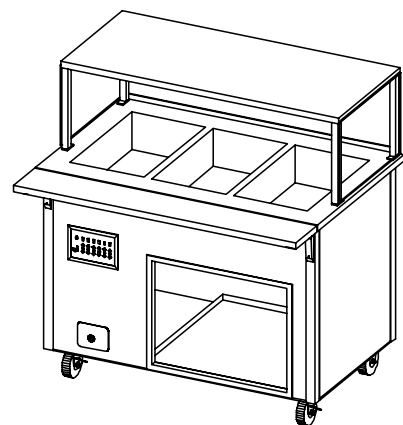

Finishes And Materials
 Top : ** 14 Ga SST
 Body : Laminate TBD
 Trim : Standard SST
 Plate Rest : 18 Ga SST
 Breath Grd : Polished SST

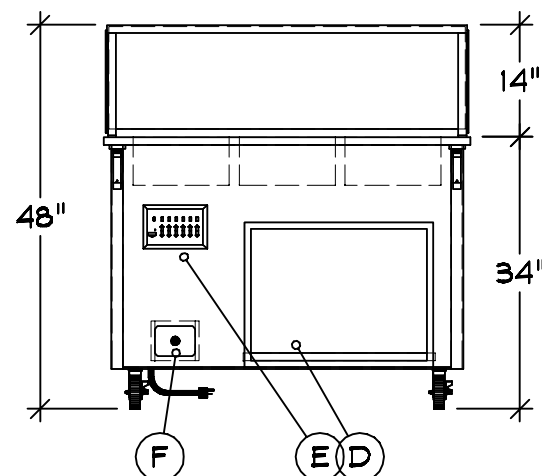
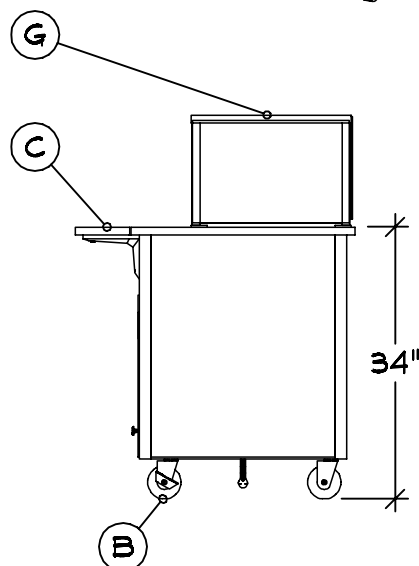

VOLTS 208 60 ELECTRICAL
 1 1 - - NEMA 6-15
 9.0A

PLUMBING CW: -
 HW: -
 WASTE: (1) Ø.5" INDIRECT

MERRY

MERRYMAN ELEM



08-06-21

COPYRIGHT 2021

THE VOLLRATH CO., LLC

SHEBOYGAN, WI

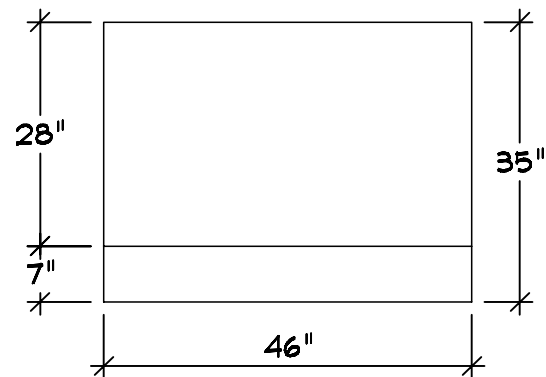
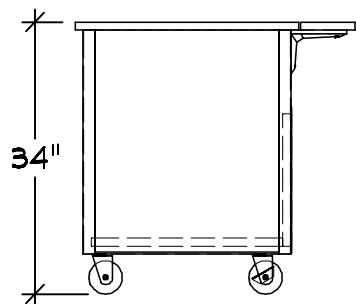

Server 40 : Qty 1
 Utility Counter
 A Casters : 4" (2) w/Brakes
 B Operator Side Plate Rest
 w/ Lift-off Bracket
 C Storage Shelf w/o Doors

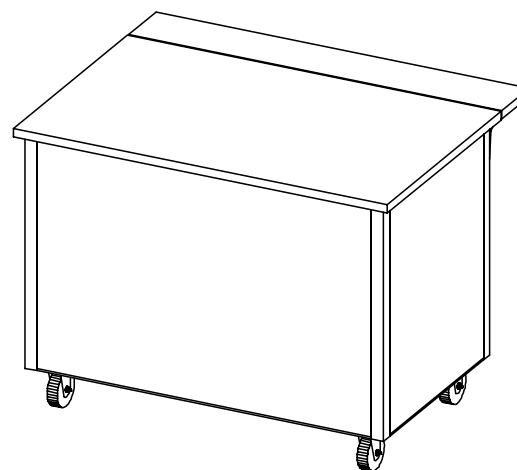
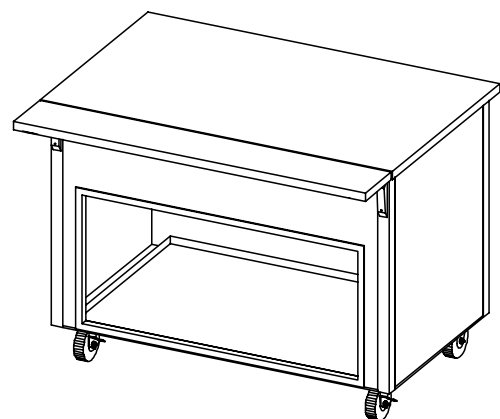

Finishes And Materials

Top : ** 14 Ga SST
 Body : Laminate TBD
 Trim : Standard SST
 Plate Rest : 18 Ga SST
 Storage Door : Polished SST

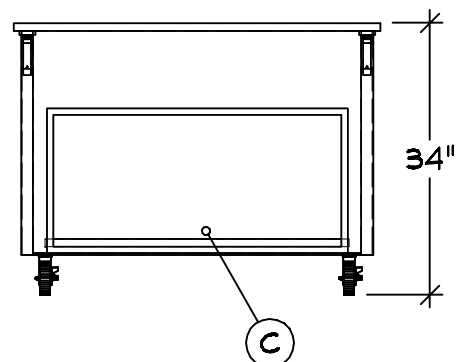
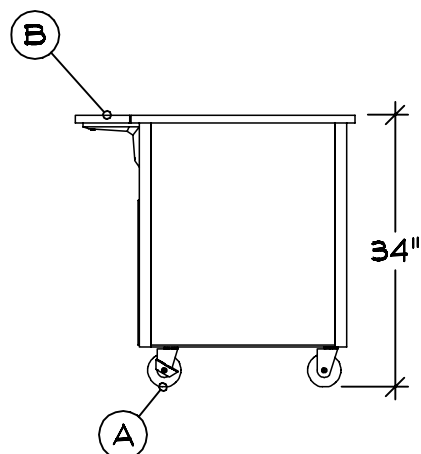

MERRY

MERRYMAN ELEM



THE VOLLRATH CO., LLC

08-06-21

COPYRIGHT 2021
 SHEBOYGAN, WI

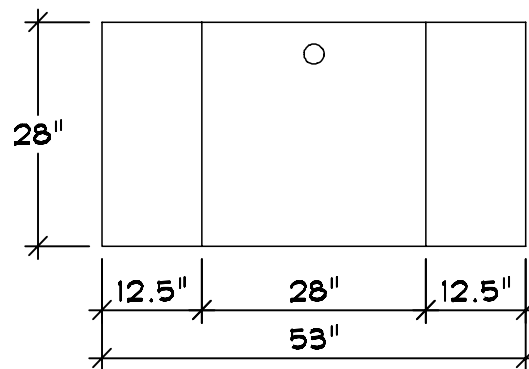
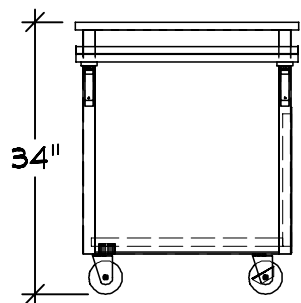

- Server 41 : Qty 1
 Cashier Station
 A Casters : 4" (2) w/Brakes
 B Operator RH Side V Rib
 Tray Slide w /Lift-off
 Brackets 30" Mounting
 Height
 C Operator LH Side V Rib
 Tray Slide w/ Lift-off
 Brackets 30" Mounting
 Height
 D Storage Shelf w/o Doors

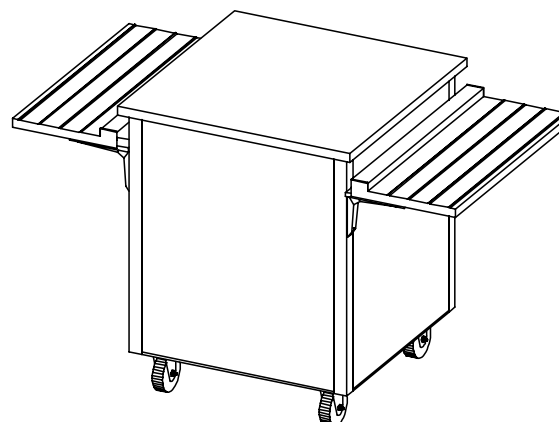
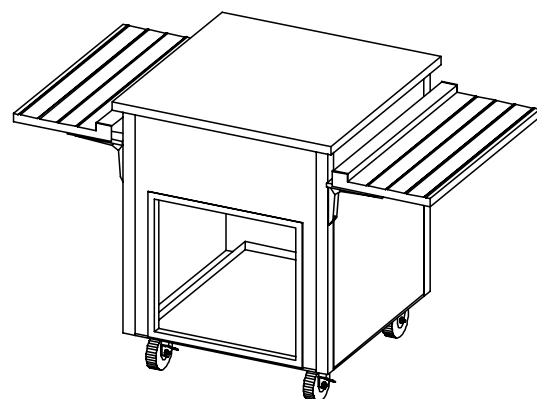

Finishes And Materials
 Top : ** 14 Ga SST
 Body : Laminate TBD
 Trim : Standard SST
 Tray Rail : 18 Ga SST

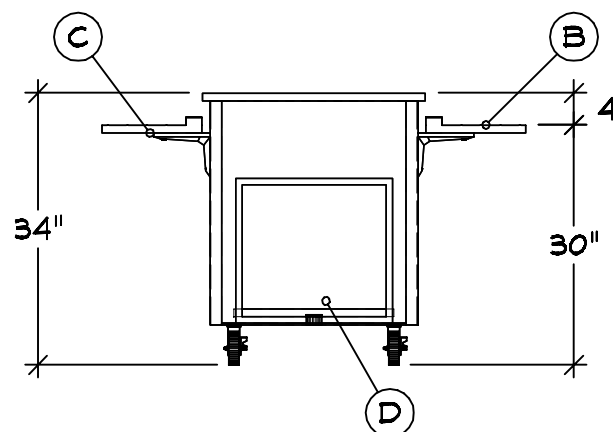
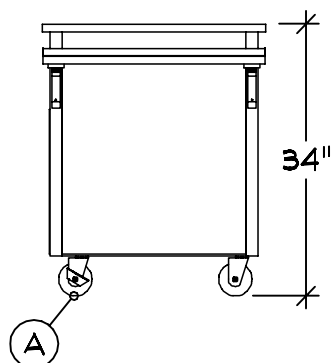

MERRY

MERRYMAN ELEM



08-06-21

COPYRIGHT 2021

THE VOLLRATH CO., LLC

SHEBOYGAN, WI

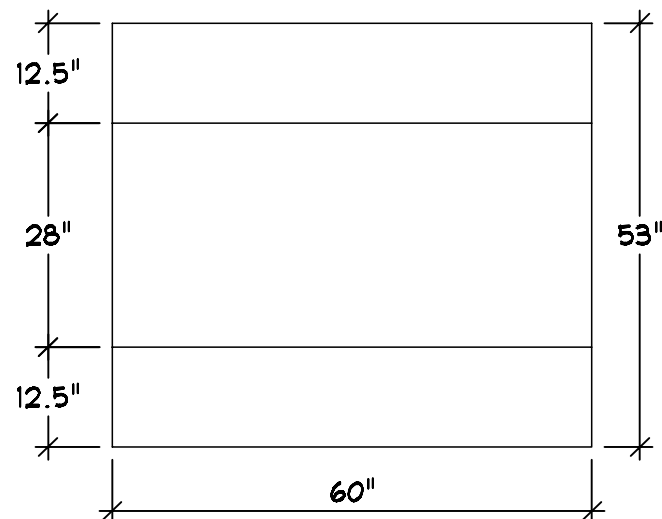
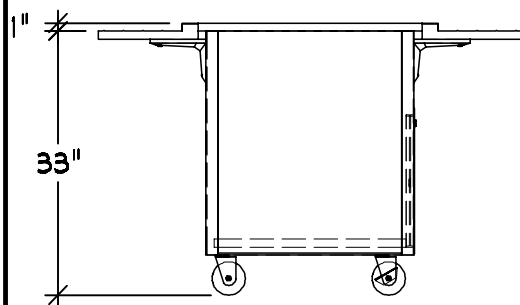

Server 42 1 Qty 1
Utility Counter
A Casters : 4* (2) w/Brakes
B Customer Side V Rib Tray
Slide w/ Lift-off Brackets
C Operator Side V Rib Tray
Slide w/ Lift-off Brackets
D Storage Shelf w/ Bypass
Doors And Lock

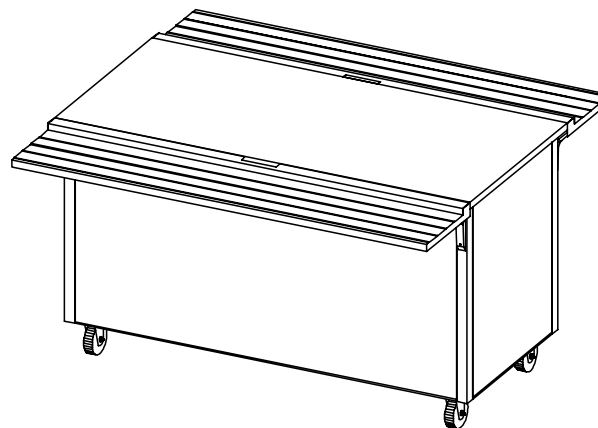
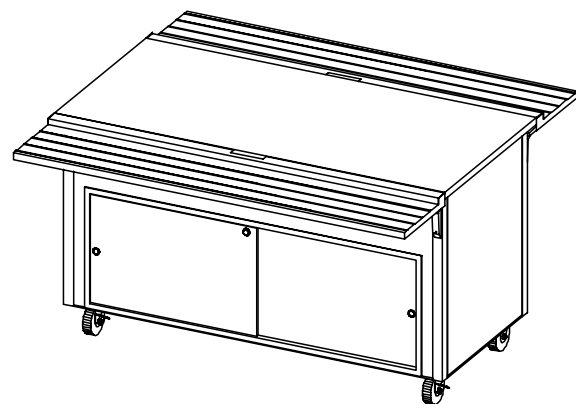

Finishes And Materials
Top : ** 14 Ga SST
Body : Laminate TBD
Trim : Standard SST
Tray Rail : 18 Ga SST
Storage Door : To Match Base

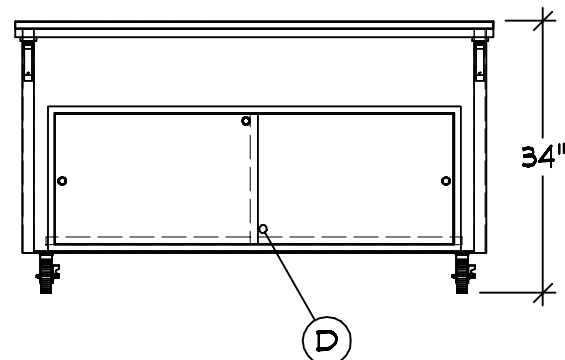
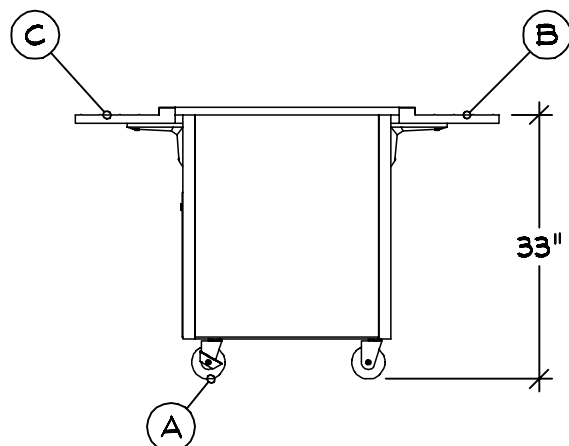

MERRY

MERRYMAN ELEM



THE VOLLRATH CO., LLC

08-06-21
COPYRIGHT 2021
SHEBOYGAN, WI

GENERAL NOTES - PLEASE READ

CONFIGURATION:

THESE DRAWINGS ARE TO BE USED IN CONJUNCTION WITH THE PREPARED QUOTATION AND MUST BE RECONCILED PRIOR TO RELEASE FOR FABRICATION.

DIMENSIONS:

ALL DIMENSIONS SHOWN ARE $\pm 1/4"$

CONNECTIONS:











ALL PIPING, FITTINGS, AND INTERCONNECTION SERVICES SHOWN ARE TO BE SUPPLIED AND INSTALLED BY LICENSED CONTRACTORS IN ACCORDANCE WITH ALL LOCAL CODES.

BY OTHERS:

VERIFY ALL EQUIPMENT LISTED AS BY OTHERS FOR SIZE AND MECHANICAL SERVICE REQUIREMENTS.

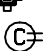
NOTE:

IN LINE WITH THE POLICY TO CONTINUALLY IMPROVE ITS PRODUCTS, THE MANUFACTURE RESERVES THE RIGHT TO CHANGE MATERIALS AND SPECIFICATIONS WITHOUT NOTICE.

	CONNECTION POINT
	COLD WATER
	HOT WATER
	HOT + COLD WATER
	DRAIN
	POWER
	SWITCH
	CORD SET
	CONV OUTLET RECP
	DUPLEX RECPTACLE
	SINGLE RECPTACLE
	REFRIGERATION



CONFIDENTIAL DESIGN

The Vollrath Company, L.L.C. ("Vollrath") considers this new design proprietary and confidential. Due to the existing relationship of trust and good faith between Vollrath and Recipient, Vollrath is providing this proprietary and confidential design and related information to Recipient with the understanding that Recipient will maintain such design and information in secrecy and will not directly or indirectly use, disseminate, or otherwise disclose this proprietary and confidential information to any outside person or organization without the express written prior consent of The Vollrath Company, L.L.C.

08-06-2021

08-06-2021 : 08:24:42a

08-06-2021 : 08:25:59a

MERRY

MERRYMAN ELEM



THE VOLLRATH CO., LLC

08-06-21

COPYRIGHT 2021
SHEBOYGAN, WI