



Outperform every day.™

Project:

Item Number:

Quantity:

Signature Server® Cashier Stations with Stainless Steel Counters



Shown with optional tray slide and cash drawer.

ITEM NO.

37015

STANDARD FEATURES

- Reinforced stainless steel unibody construction provides extra durability in a lightweight, mobile base
- Base is 18-gauge 400 series stainless steel with applied black laminate
- Top is one-piece 16-gauge 300 series stainless steel
- Operator side is open
- Stainless steel bottom shelf
- Accepts optional cash drawer. See Signature Server Options and Accessories specification sheet on Vollrath.com for details.
- Heavy-duty 4" (10 cm) swivel casters with brakes

Note: Signature Server® equipment orders cannot be canceled or returned.

WARRANTY

All models shown come with Vollrath's standard warranty against defects in materials and workmanship. For full warranty details, please refer to www.Vollrath.com.

OPTIONS

BASE COLOR

- ☐ Black Laminate (Standard)
- ☐ Matte Laminate. Specify manufacturer/color: _____
- ☐ Wood Grain. Specify manufacturer/color: _____

Stainless Steel

Vinyl Wrap

- ☐ Food Words ☐ Food Images
- ☐ Bubbles ☐ Checkerboard

COUNTERTOP MATERIAL

- ☐ 18 Ga Stainless Steel (Standard)
- ☐ 14 Ga Stainless Steel
- ☐ Textured Stainless Steel

CUSTOM OPTIONS

Contact Vollrath Representative for all options.

- ☐ Toe Kick ☐ Electrical Outlet
- ☐ Back Splash ☐ Custom _____

EXTENDED WARRANTY

Contact Vollrath Representative for details.

ACCESSORIES

See Signature Server Accessories Spec Sheet.

Plate Rest w/ Mounting Kit (Stainless Steel)

- ☐ Customer Side ☐ Plain ☐ Textured
- ☐ Operator Side ☐ Plain ☐ Textured

Tray Slide, V-rib (Stainless Steel)

- ☐ Customer Side ☐ 18 Ga ☐ 14 Ga
- ☐ Operator Side ☐ 18 Ga ☐ 14 Ga

Tray Slide, Tubular (Stainless Steel)

- ☐ Customer Side
- ☐ Operator Side

Cutting Board

- ☐ Maple Hardwood ☐ White Poly

End Shelf (Stainless Steel)

- ☐ Operator Left ☐ Operator Right
- ☐ Operator Left and Operator Right

Storage Module

- ☐ With Doors ☐ Without Doors

Stationary Legs

- ☐ Adjustable 4-5" ☐ 4"F fixed ☐ 6" Fixed

Line Locks

- ☐ Line Locks

Cord Cutout

- ☐ Cutout in Countertop with Receptacle

Cash Drawer

- ☐ Cash Drawer

Approvals

Date

Signature Server® Cashier Stations with Stainless Steel Counters

DIMENSIONS ((Shown in inches (cm))

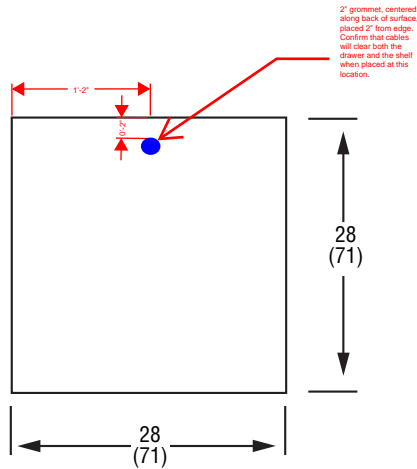

Top View

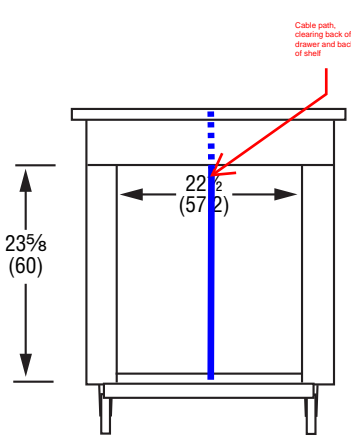

Operator Side View

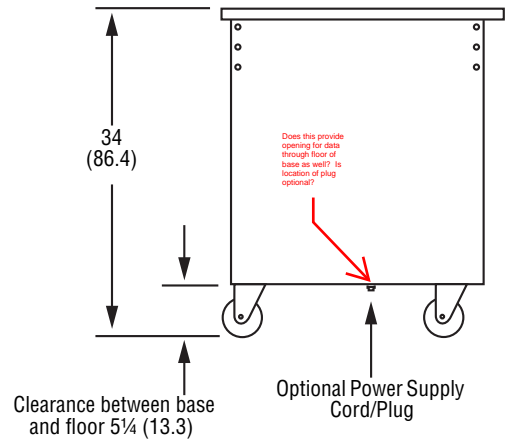

End View

Note: For accessory dimensions, see the accessory spec sheets on vollrath.com

8/3/21



Outperform every day.™

www.vollrath.com

The Vollrath Company, L.L.C.
1236 North 18th Street
Sheboygan, WI 53081-3201 U.S.A.
Main Tel: 800.624.2051 or 920.457.4851
Main Fax: 800.752.5620 or 920.459.6573
Customer Service: 800.628.0830

Technical Services
techservicereps@vollrathco.com
Induction Products: 800.825.6036
Countertop Warming Products:
800.354.1970
All Other Products: 800.628.0832