

Server 66 1 Qty 1  
 Cold Food Counter  
 A (1) 5 Pan Cold Well  
 B Custom Counter Depth  
 C Line Up Locks  
 D Casters : 4" (2) w/Brakes  
 E Customer Side V Smooth  
 Tray Slide w/ Lift-off  
 Brackets  
 G Drain : 1½" w/ Ball Valve  
 H SST End Shelf Service  
 Left End  
 I Controls : Customer Side  
 Access  
 J Access Breath Guard  
 Single Side Buffet  
 Adjustable Height Frame  
 Full Width S-S  
 End Panels Both Sides  
 NSF End Panels

#### Finishes And Materials

Top : \*\* 14 Ga SST  
 Body : Formica 851  
 Trim : Standard SST  
 Tray Rail : 18 Ga SST  
 Plate Rest : 18 Ga SST  
 End Shelf : 18 Ga SST  
 Breath Grd : SST Frame, Top  
 Shelf To Match Body

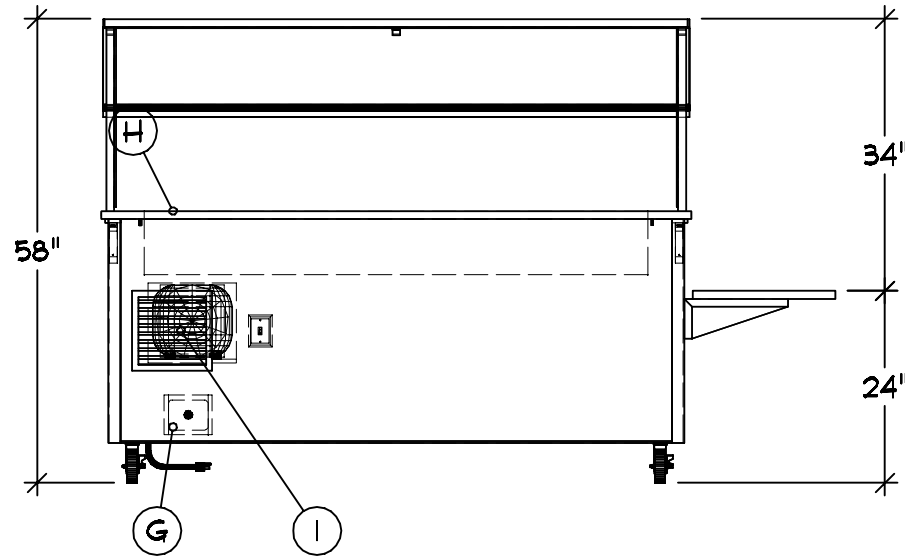
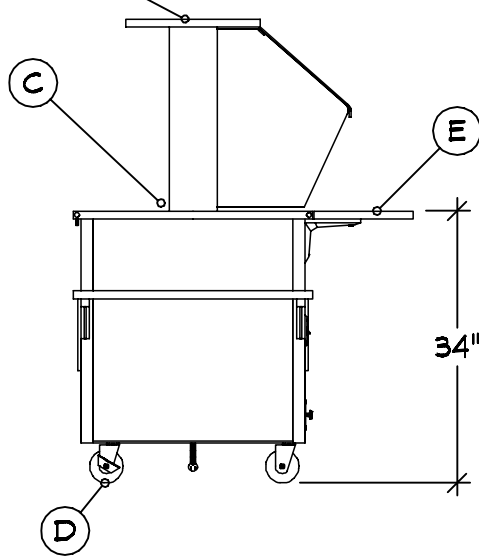
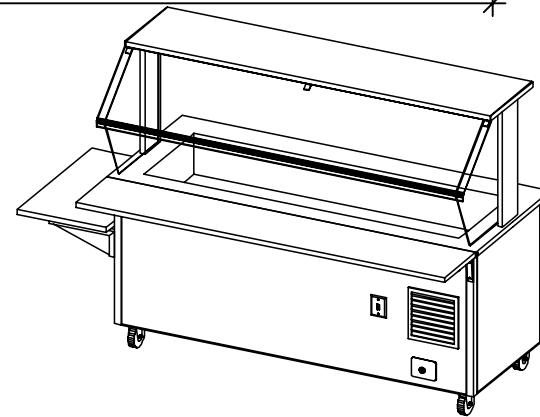
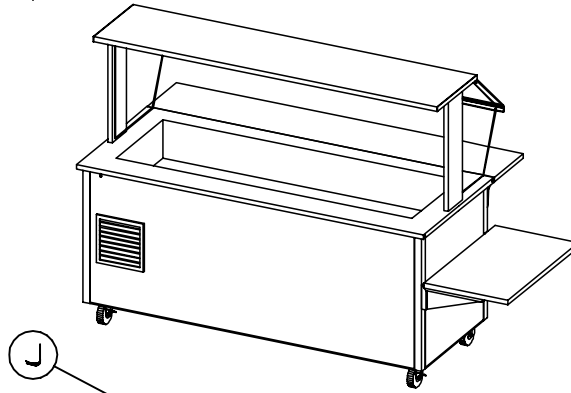

VOLTS 120 60 ELECTRICAL  
 1 1 1/2  
 7.8 A NEMA 5-15

PLUMBING CW: -  
 HW: -  
 WASTE: (1) Ø.5" INDIRECT

JCKMS

JACKSON MIDDLE SCHOOL



07-07-21

COPYRIGHT 2021

THE VOLLRATH CO., LLC

SHEBOYGAN, WI

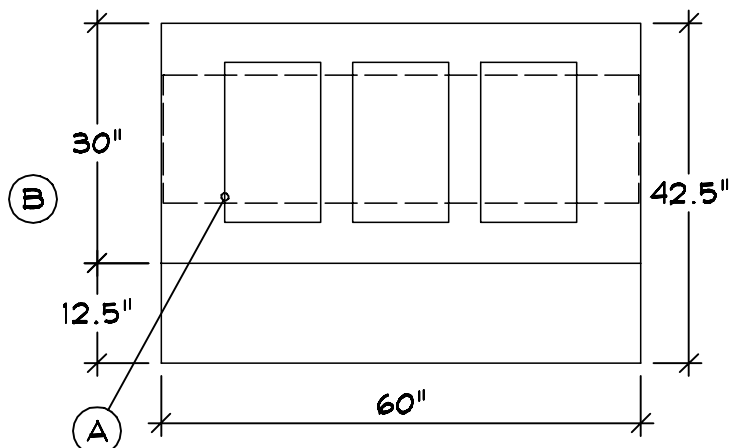
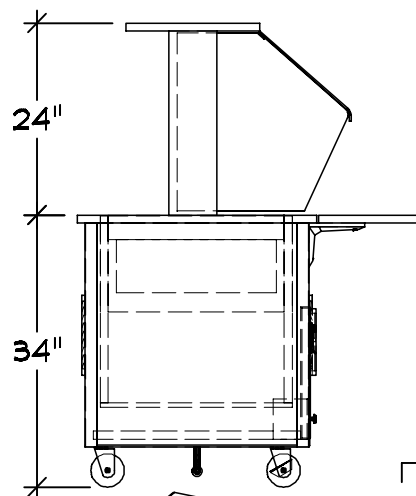

A Top Layout Operator L-R  
(1) 3 Pan Drop Individual  
Hot/Cold Well

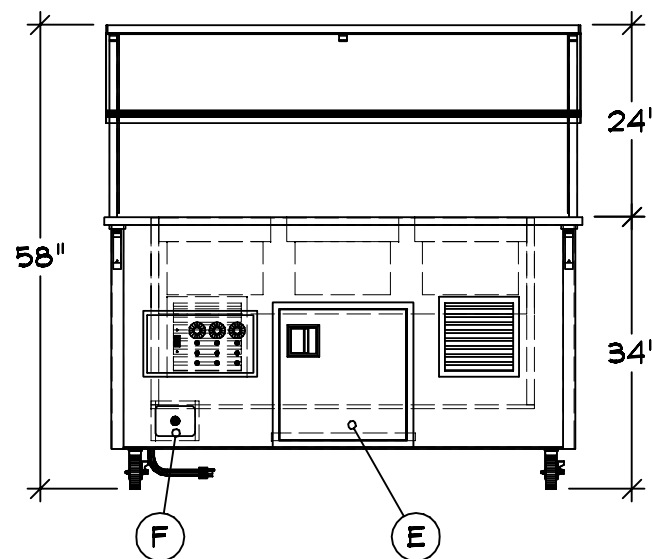
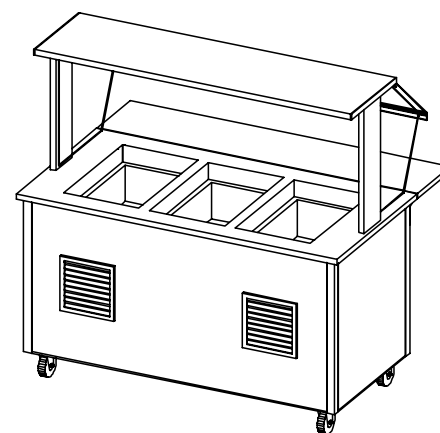
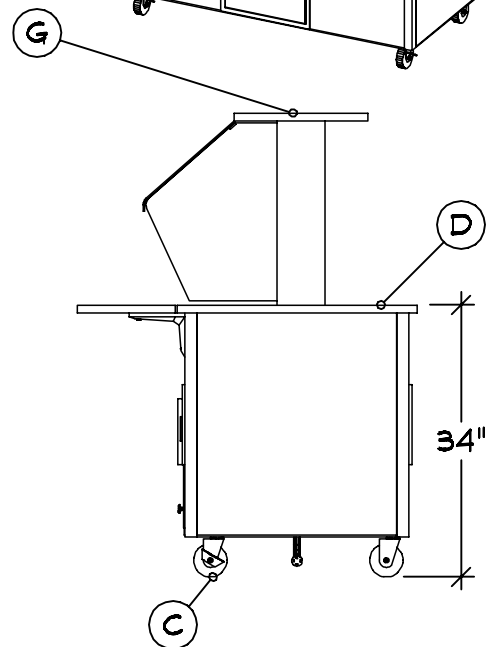
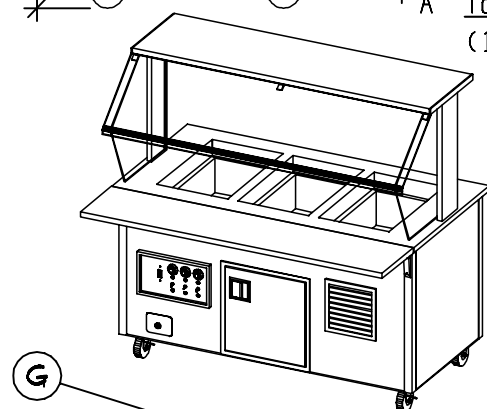

Server 67 1 Qty 2  
Utility Counter  
A Custom Configuration  
B Custom Counter Depth  
C Casters : 4" (2) w/Brakes  
D Customer Side V Smooth  
Tray Slide w/ Lift-off  
Brackets  
E Storage Shelf w/ Hinged  
Doors And Lock  
F Drain : 1 1/2" w/ Ball Valve  
G Access Breath Guard  
Single Side Buffet  
With Fixed Height Frame  
Full Width S-S  
End Panel Both Sides  
NSF Standards

Finishes And Materials  
Top : \*\* 14 Ga SST  
Body : Formica 851  
Trim : Standard SST  
Tray Rail : 18 Ga SST  
Storage Door : To Match Base  
Breath Grd : SST Frame, Top  
Shelf To Match Body

VOLTS 208  
Ø 1  
11.2A  
ELECTRICAL  
NEMA 14-20

PLUMBING CW: -  
HW: -  
WASTE: (2) Ø.5" INDIRECT

JCKMS  
JACKSON MIDDLE SCHOOL

VOLLRATH  
07-07-21  
COPYRIGHT 2021  
THE VOLLRATH CO., LLC SHEBOYGAN, WI

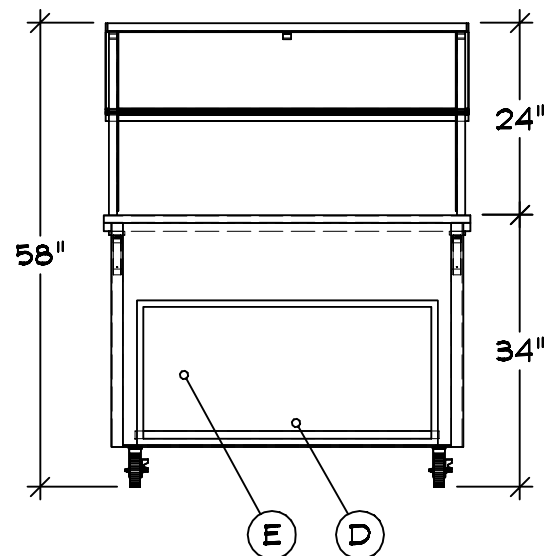
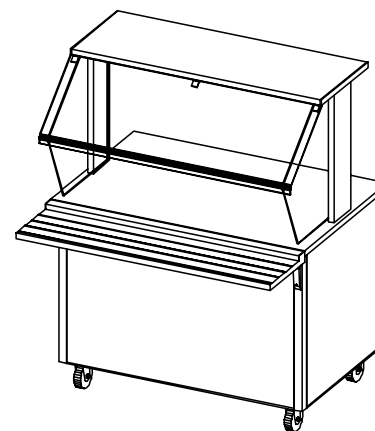
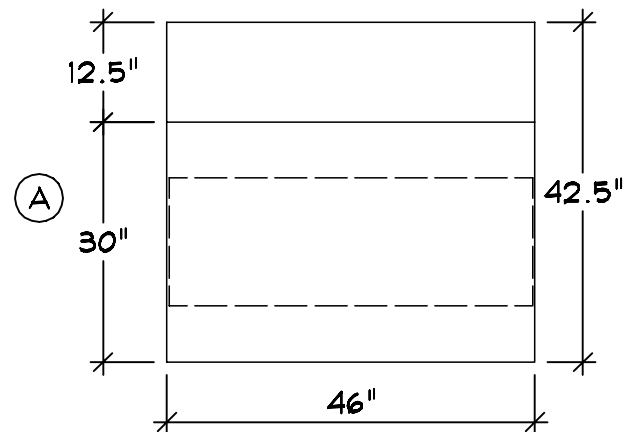
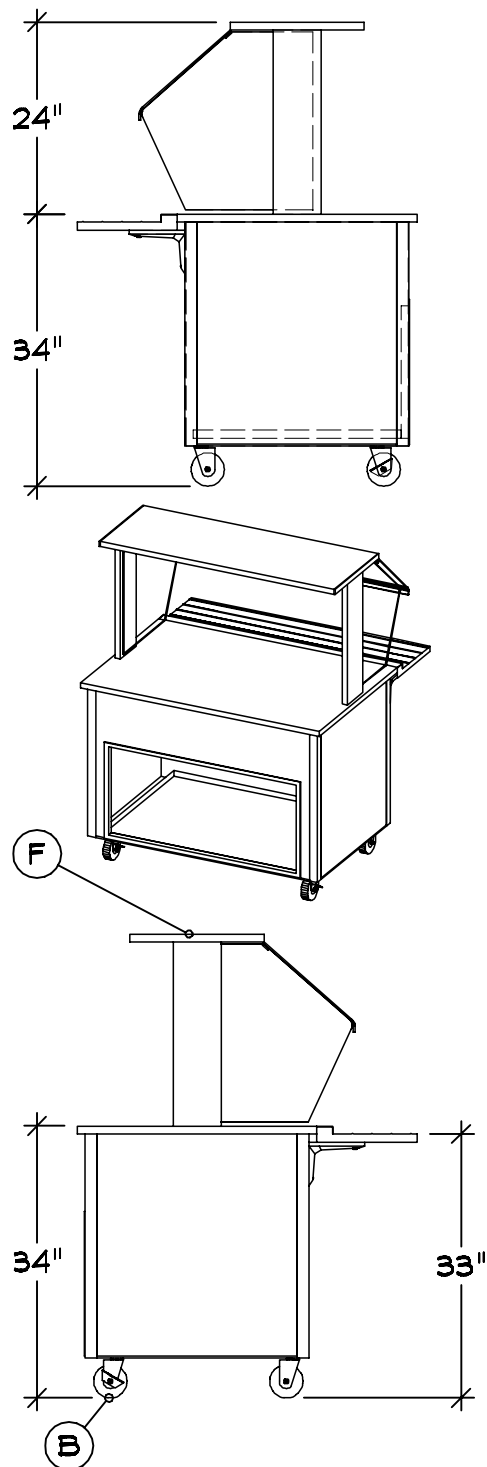

Server 69 1 Qty 1

Utility Counter

- A Custom Counter Depth
- B Casters : 4" (2) w/Brakes
- C Wall Side V Rib Tray Slide w/ Lift-off Brackets
- D Storage Shelf w/o Doors
- E Wall Installation, Service Side Access Required
- F Access Breath Guard

#### Finishes And Materials

- Top : \*\* 14 Ga SST
- Body : Formica 851
- Trim : Standard SST
- Tray Rail : 18 Ga SST
- Plate Rest : 18 Ga SST
- End Shelf : 18 Ga SST
- Breath Grd : SST Frame, Top Shelf To Match Body

JCKMS

JACKSON MIDDLE SCHOOL



07-07-21

COPYRIGHT 2021

THE VOLLRATH CO., LLC

SHEBOYGAN, WI



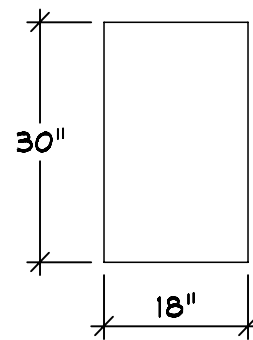
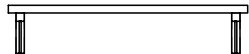

Server 73 | Qty 1 + Item 73.1  
SST End Shelf  
Custom Counter Depth  
Shipped Loose

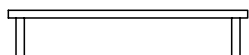
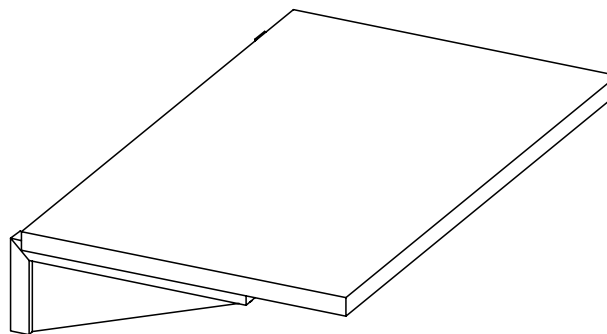
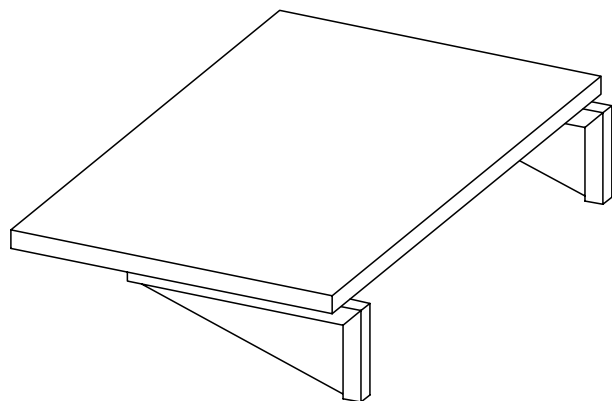

JCKMS

JACKSON MIDDLE SCHOOL



07-07-21

COPYRIGHT 2021

THE VOLLRATH CO., LLC

SHEBOYGAN, WI

## GENERAL NOTES - PLEASE READ

### CONFIGURATION:

THESE DRAWINGS ARE TO BE USED IN CONJUNCTION WITH THE PREPARED QUOTATION AND MUST BE RECONCILED PRIOR TO RELEASE FOR FABRICATION.

### DIMENSIONS:

ALL DIMENSIONS SHOWN ARE  $\pm 1/4"$

### CONNECTIONS:











ALL PIPING, FITTINGS, AND INTERCONNECTION SERVICES SHOWN ARE TO BE SUPPLIED AND INSTALLED BY LICENSED CONTRACTORS IN ACCORDANCE WITH ALL LOCAL CODES.

### BY OTHERS:

VERIFY ALL EQUIPMENT LISTED AS BY OTHERS FOR SIZE AND MECHANICAL SERVICE REQUIREMENTS.

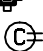
### NOTE:

IN LINE WITH THE POLICY TO CONTINUALLY IMPROVE ITS PRODUCTS, THE MANUFACTURE RESERVES THE RIGHT TO CHANGE MATERIALS AND SPECIFICATIONS WITHOUT NOTICE.

|   |                  |
|---|------------------|
|  | CONNECTION POINT |
|  | COLD WATER       |
|  | HOT WATER        |
|  | HOT + COLD WATER |
|  | DRAIN            |
|  | POWER            |
|  | SWITCH           |
|  | CORD SET         |
|  | CONV OUTLET RECP |
|  | DUPLEX RECPTACLE |
|  | SINGLE RECPTACLE |
|  | REFRIGERATION    |



## CONFIDENTIAL DESIGN

The Vollrath Company, L.L.C. ("Vollrath") considers this new design proprietary and confidential. Due to the existing relationship of trust and good faith between Vollrath and Recipient, Vollrath is providing this proprietary and confidential design and related information to Recipient with the understanding that Recipient will maintain such design and information in secrecy and will not directly or indirectly use, disseminate, or otherwise disclose this proprietary and confidential information to any outside person or organization without the express written prior consent of The Vollrath Company, L.L.C.

06-08-2021

06-08-2021 : 07:38:06a

06-09-2021 : 07:23:13a

07-02-2021 : 11:42:40a

07-02-2021 : 11:44:32a

07-02-2021 : 11:46:40a

07-07-2021 : 12:10:04p

Jill Hundley  
THE VOLLRATH COMPANY

v. 920-459-5302

Email: [jhundley@vollrathco.com](mailto:jhundley@vollrathco.com)

JCKMS

JACKSON MIDDLE SCHOOL



THE VOLLRATH CO., LLC

07-07-21

COPYRIGHT 2021  
SHEBOYGAN, WI