

Server 1 | Qty 1
 Hot Food Counter
 A 5 Individual Wet Hot Wells
 B Line Up Locks
 C Casters : 4" (2) w/Brakes
 D Customer Side V Rib Tray
 Slide w/ Lift-off Brackets
 E Storage Shelf w/o Doors
 F Controls : Infinite Dial
 G Drain : 1½" w/ Ball Valve
 H Classic Breath Guard

Single Side Cafeteria

Single Deck

Full Width S-S

6" Front Opening Gap

*** Does Not Meet Current
 NSF Standards

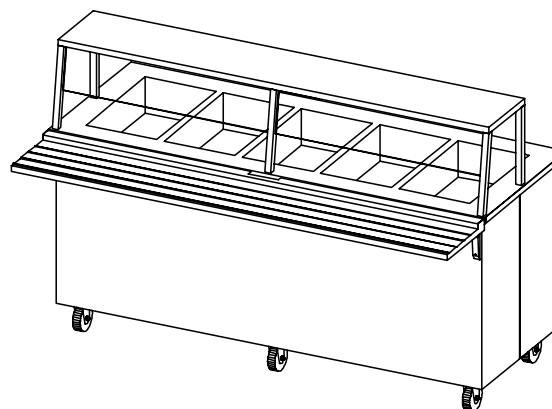
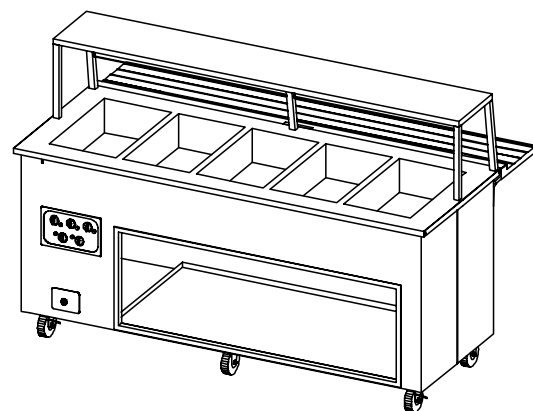

Finishes And Materials

Top : 18 Ga SST

Body : ** 18 Ga SST

Trim : Standard SST

Tray Rail : 18 Ga SST

Breath Grd : Polished SST

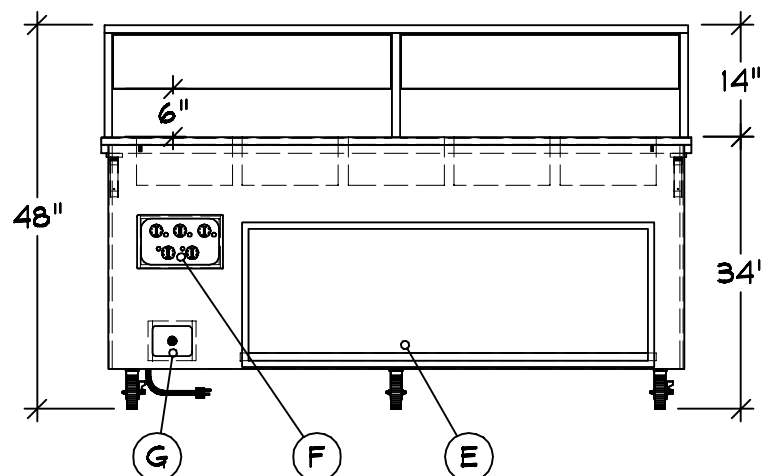
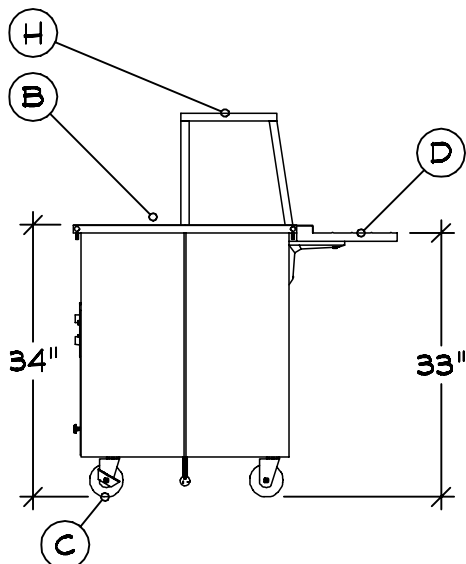

VOLTS 120
 15.0 A
 60
 1
 ELECTRICAL
 NEMA 5-20

PLUMBING CW: -
 HW: -
 WASTE: (1) 0.5" INDIRECT

IBERV

IBERVILLE PUBLIC SCHOOLS



08-05-21

COPYRIGHT 2021

THE VOLLRATH CO., LLC

SHEBOYGAN, WI

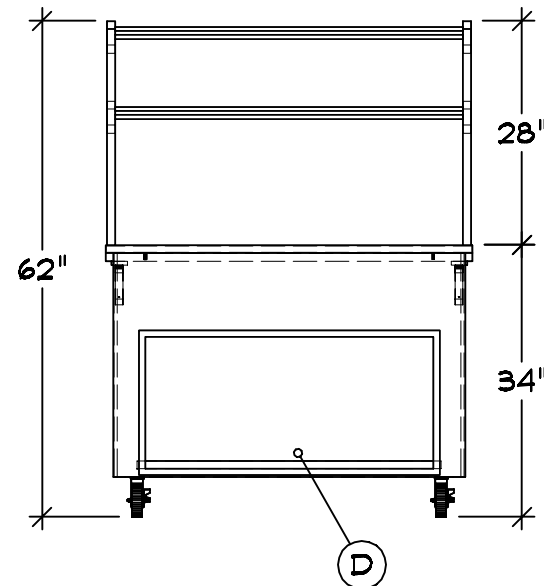
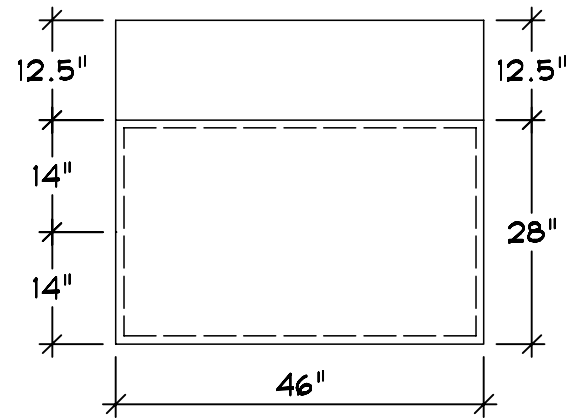
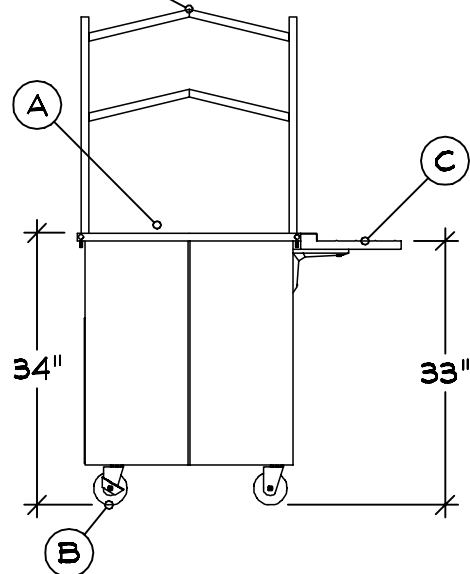
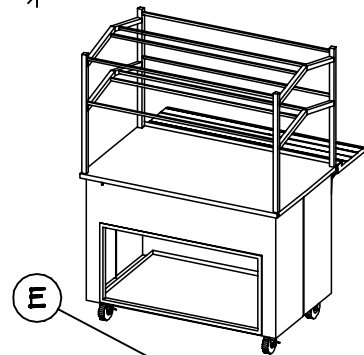
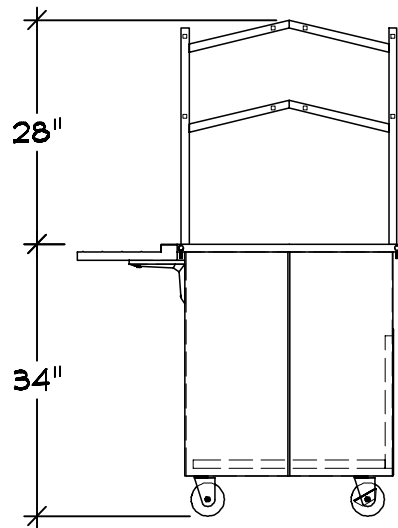

Server 2 | Qty 1
 Utility Counter
 A Line Up Locks
 B Casters : 4" (2) w/Brakes
 C Customer Side V Rib Tray
 Slide w/ Lift-off Brackets
 D Storage Shelf w/o Doors
 E Overshelf Breath Guard
 Speed Serve
 Full Width S-S
 Double Shelf
 *** Does Not Meet Current
 NSF Standards

Finishes And Materials
 Top : 16 Ga SST
 Body : ** 18 Ga SST
 Trim : Standard SST
 Tray Rail : 18 Ga SST
 Storage Door : Polished SST
 Breath Grd : Polished SST

IBERV

IBERVILLE PUBLIC SCHOOLS



THE VOLLRATH CO., LLC

08-05-21
 COPYRIGHT 2021
 SHEBOYGAN, WI

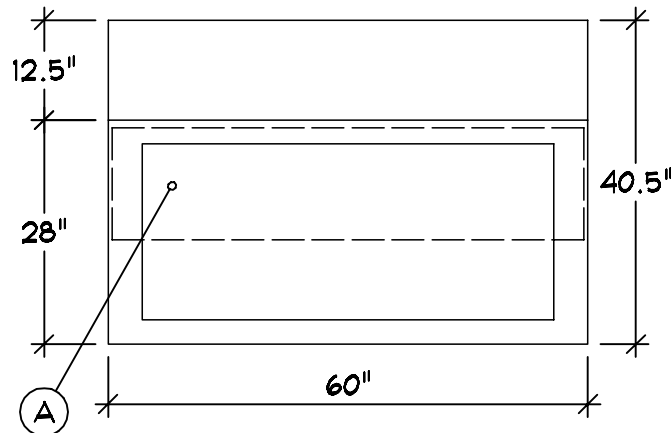
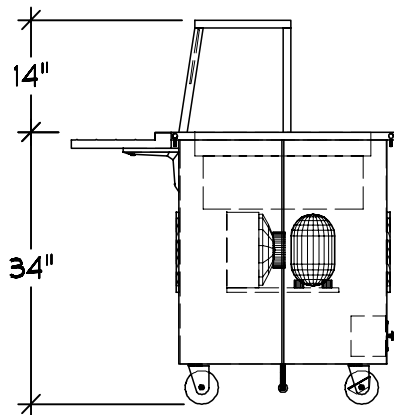

Server 3 | Qty 1
Cold Food Counter
A (1) 4 Pan Nsf7 Cold Well
B Line Up Locks
C Casters : 4" (2) w/Brakes
D Customer Side V Rib Tray
Slide w/ Lift-off Brackets
E Drain : 1\2" w/ Ball Valve
F Classic Breath Guard

Single Side Cafeteria
Single Deck
Full Width S-S
*** 6" Front Panel Opening
*** Does Not Meet Current
NSF Standards

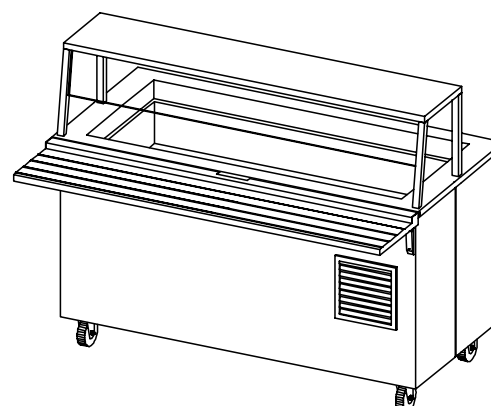
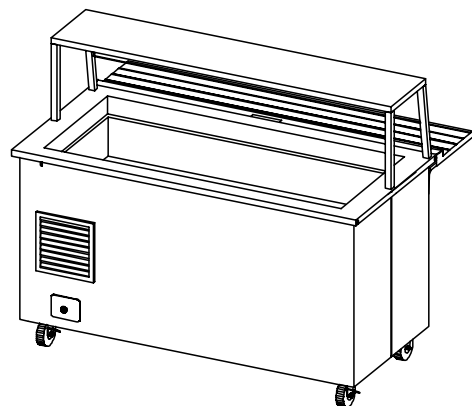

Finishes And Materials
Top : 18 Ga SST
Body : ** 18 Ga SST
Trim : Standard SST
Tray Rail : 18 Ga SST
Breath Grd : Polished SST

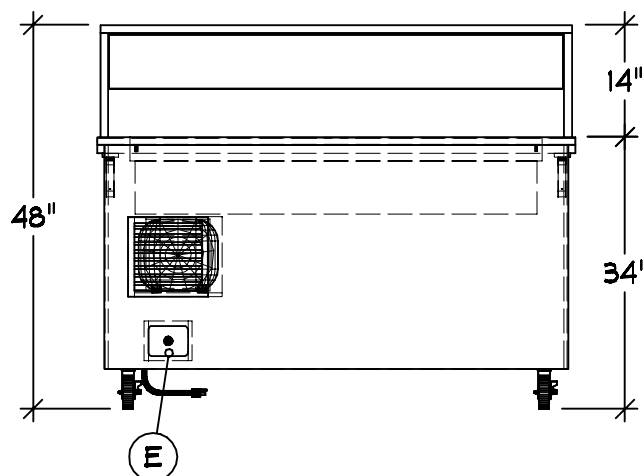
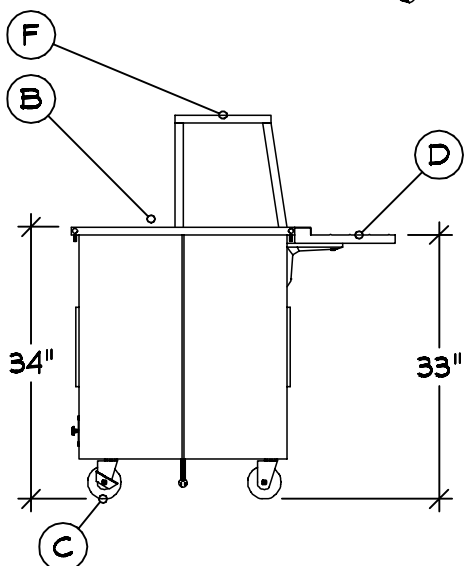

VOLTS 120
Ø 1
7.5 A
ELECTRICAL
60
NEMA 5-15

PLUMBING CW: -
HW: -
WASTE: (1) Ø.5" INDIRECT

IBERV

IBERVILLE PUBLIC SCHOOLS



08-05-21

COPYRIGHT 2021

THE VOLLRATH CO., LLC

SHEBOYGAN, WI

GENERAL NOTES - PLEASE READ

CONFIGURATION:

THESE DRAWINGS ARE TO BE USED IN CONJUNCTION WITH THE PREPARED QUOTATION AND MUST BE RECONCILED PRIOR TO RELEASE FOR FABRICATION.

DIMENSIONS:

ALL DIMENSIONS SHOWN ARE $\pm 1/4"$

CONNECTIONS:











ALL PIPING, FITTINGS, AND INTERCONNECTION SERVICES SHOWN ARE TO BE SUPPLIED AND INSTALLED BY LICENSED CONTRACTORS IN ACCORDANCE WITH ALL LOCAL CODES.

BY OTHERS:

VERIFY ALL EQUIPMENT LISTED AS BY OTHERS FOR SIZE AND MECHANICAL SERVICE REQUIREMENTS.

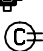
NOTE:

IN LINE WITH THE POLICY TO CONTINUALLY IMPROVE ITS PRODUCTS, THE MANUFACTURE RESERVES THE RIGHT TO CHANGE MATERIALS AND SPECIFICATIONS WITHOUT NOTICE.

	CONNECTION POINT
	COLD WATER
	HOT WATER
	HOT + COLD WATER
	DRAIN
	POWER
	SWITCH
	CORD SET
	CONV OUTLET RECP
	DUPLEX RECPTACLE
	SINGLE RECPTACLE
	REFRIGERATION



CONFIDENTIAL DESIGN

The Vollrath Company, L.L.C. ("Vollrath") considers this new design proprietary and confidential. Due to the existing relationship of trust and good faith between Vollrath and Recipient, Vollrath is providing this proprietary and confidential design and related information to Recipient with the understanding that Recipient will maintain such design and information in secrecy and will not directly or indirectly use, disseminate, or otherwise disclose this proprietary and confidential information to any outside person or organization without the express written prior consent of The Vollrath Company, L.L.C.

08-04-2021

08-04-2021 : 07:57:15a

08-05-2021 : 09:50:17a

IBERV

IBERVILLE PUBLIC SCHOOLS



THE VOLLRATH CO., LLC

08-05-21

COPYRIGHT 2021
SHEBOYGAN, WI