

GATEP

GATE GROUP



THE VOLLRATH CO., LLC

06-24-21

COPYRIGHT 2021
SHEBOYGAN, WI

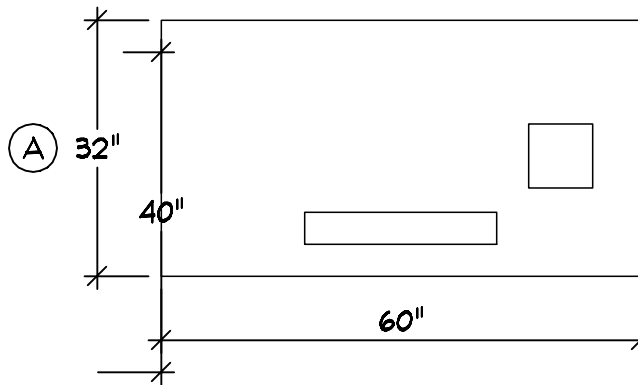
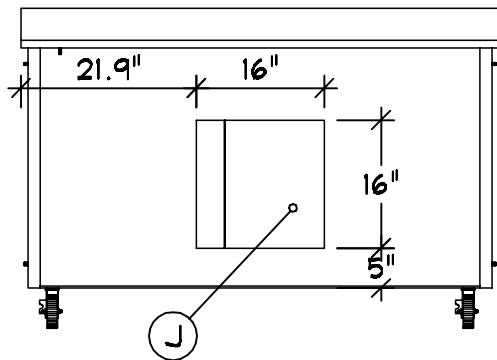

A Top Layout Operator L-R
Open Work Top
d Drip Trough - Centered
Pipe Opening

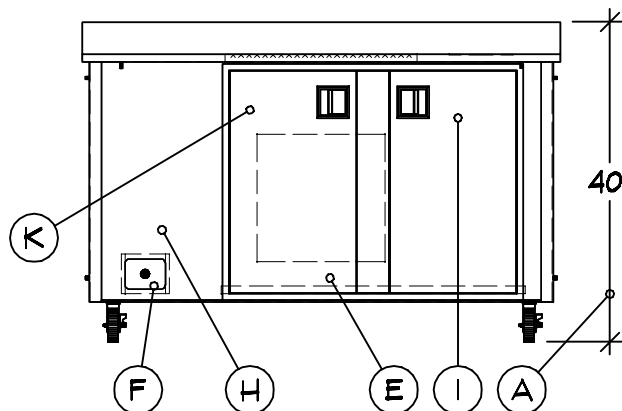
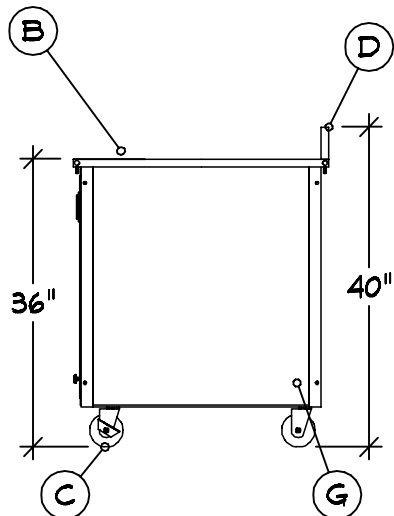
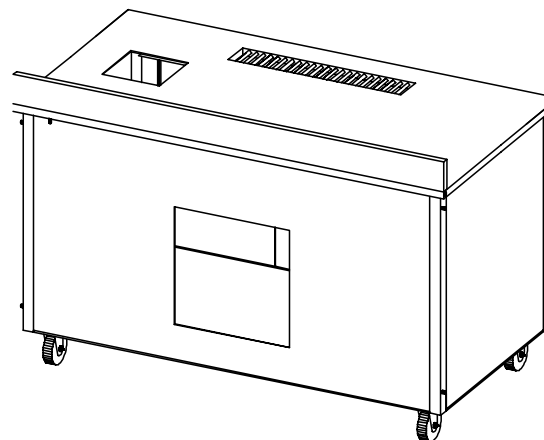
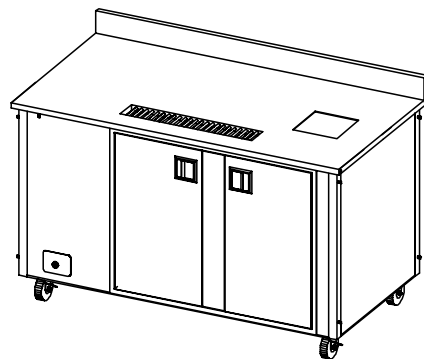
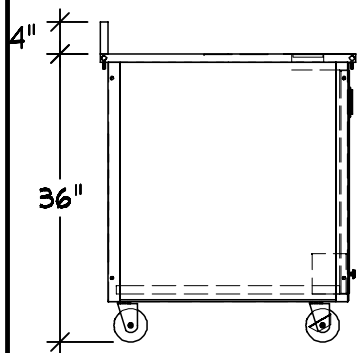

- Server 1 | Qty 1
Beverage Counter
- A Custom Counter Depth & Height
 - B Line Up Locks
 - C Casters : 4" (2) w/Brakes
 - D 4" High Wall Side SST Splash
 - E Open Storage w/ Hinged Doors And Lock
 - F Drain : 1\2" w/ Ball Valve
 - G Filler Panels And Studs
 - H Wall Installation, Service Side Access Required
 - I Welded Subframe Reinforced Base
 - J Rear Panel Opening For Pipes
 - K Custom Height Storage

Finishes And Materials
Top : 16 Ga SST
Body : Standard Black
Trim : Standard SST
Filler : 18 Ga SST
Splash : 16 Ga SST
Storage Door : To Match Base

PLUMBING CW: -
HW: -
WASTE: (1) Ø.5" INDIRECT

GATEP

GATE GROUP



THE VOLLRATH CO., LLC

06-24-21
COPYRIGHT 2021
SHEBOYGAN, WI

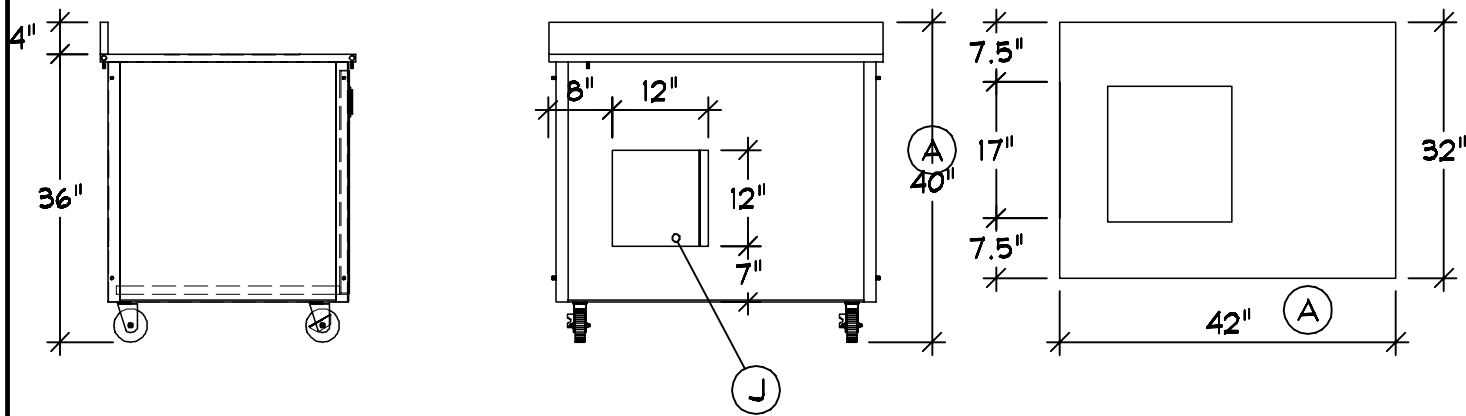

- Server 2 | Qty 1
Utility Counter
- A Custom Counter Width, Depth & Height
 - B Line Up Locks
 - C Casters : 4" (2) w/Brakes
 - D 4" High Wall Side SST Splash
 - E Open Storage w/ Hinged Doors And Lock
 - F Custom Height Storage
 - G Filler Panels And Studs
 - H Wall Installation, Service Side Access Required
 - I Welded Subframe Reinforced Base
 - J Rear Panel Opening For Pipes

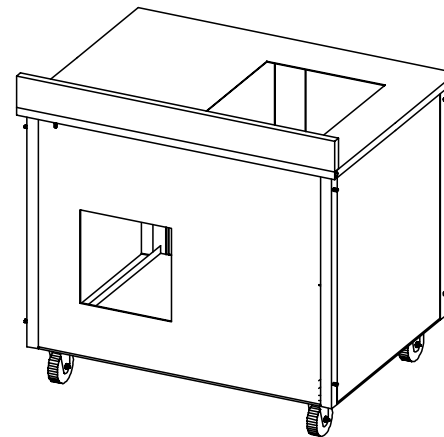
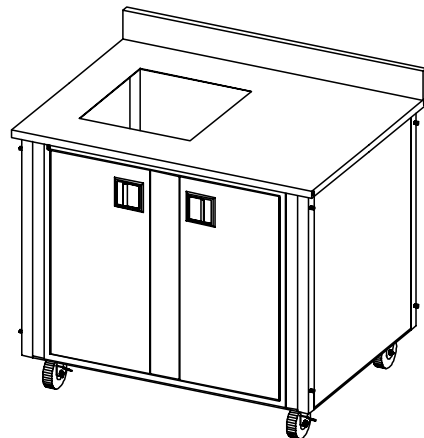

Finishes And Materials
 Top : 16 Ga SST
 Body : Standard Black
 Trim : Standard SST
 Filler : 18 Ga SST
 Splash : 16 Ga SST
 Storage Door : To Match Base

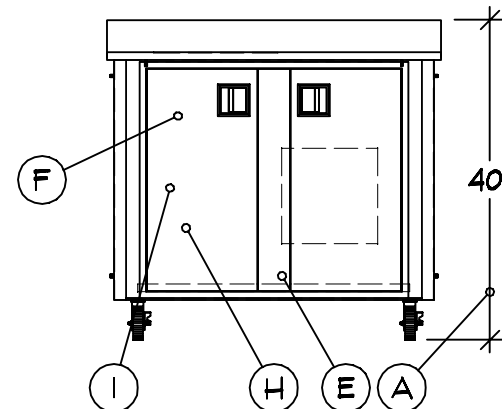
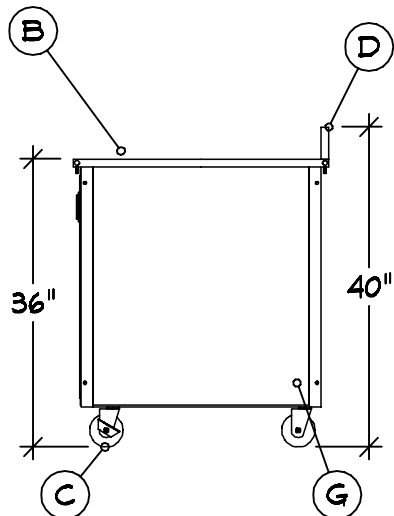

GATEP

GATE GROUP



06-24-21

COPYRIGHT 2021

THE VOLLRATH CO., LLC

SHEBOYGAN, WI

GENERAL NOTES - PLEASE READ

CONFIGURATION:

THESE DRAWINGS ARE TO BE USED IN CONJUNCTION WITH THE PREPARED QUOTATION AND MUST BE RECONCILED PRIOR TO RELEASE FOR FABRICATION.

DIMENSIONS:

ALL DIMENSIONS SHOWN ARE $\pm 1/4"$

CONNECTIONS:











ALL PIPING, FITTINGS, AND INTERCONNECTION SERVICES SHOWN ARE TO BE SUPPLIED AND INSTALLED BY LICENSED CONTRACTORS IN ACCORDANCE WITH ALL LOCAL CODES.

BY OTHERS:

VERIFY ALL EQUIPMENT LISTED AS BY OTHERS FOR SIZE AND MECHANICAL SERVICE REQUIREMENTS.

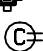
NOTE:

IN LINE WITH THE POLICY TO CONTINUALLY IMPROVE ITS PRODUCTS, THE MANUFACTURE RESERVES THE RIGHT TO CHANGE MATERIALS AND SPECIFICATIONS WITHOUT NOTICE.

	CONNECTION POINT
	COLD WATER
	HOT WATER
	HOT + COLD WATER
	DRAIN
	POWER
	SWITCH
	CORD SET
	CONV OUTLET RECP
	DUPLEX RECPTACLE
	SINGLE RECPTACLE
	REFRIGERATION



CONFIDENTIAL DESIGN

The Vollrath Company, L.L.C. ("Vollrath") considers this new design proprietary and confidential. Due to the existing relationship of trust and good faith between Vollrath and Recipient, Vollrath is providing this proprietary and confidential design and related information to Recipient with the understanding that Recipient will maintain such design and information in secrecy and will not directly or indirectly use, disseminate, or otherwise disclose this proprietary and confidential information to any outside person or organization without the express written prior consent of The Vollrath Company, L.L.C.

06-23-2021

06-23-2021 : 02:16:59p

06-23-2021 : 03:25:01p

06-24-2021 : 06:35:58a

GATEP

GATE GROUP



THE VOLLRATH CO., LLC

06-24-21

COPYRIGHT 2021
SHEBOYGAN, WI