

FRKHC	
FRANKLIN - HOT/COLD	
	05-27-21
THE VOLLRATH CO., LLC	COPYRIGHT 2021 SHEBOYGAN, WI

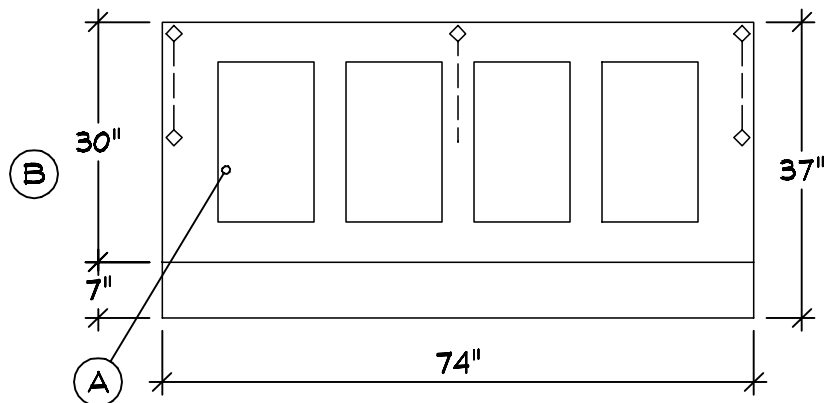

A Top Layout Operator L-R
(4) Combination Hot/Cold Wells
Integrated Into Top Surface

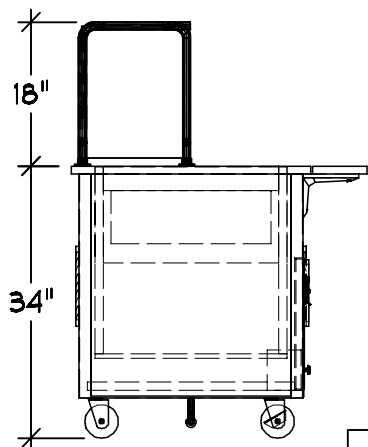
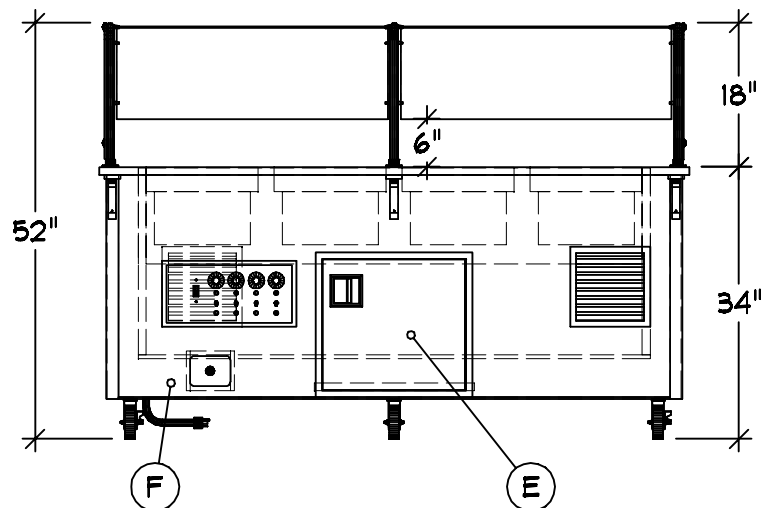
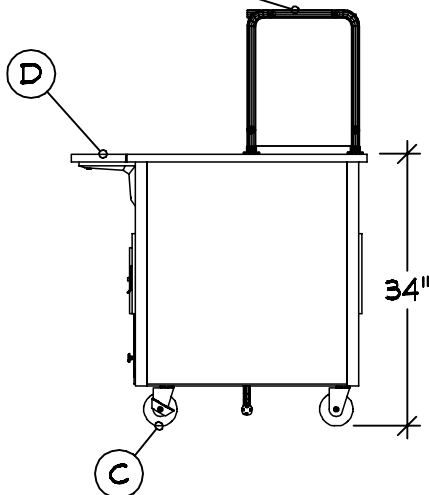
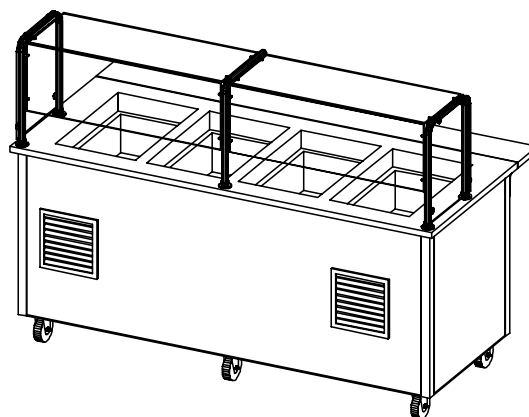
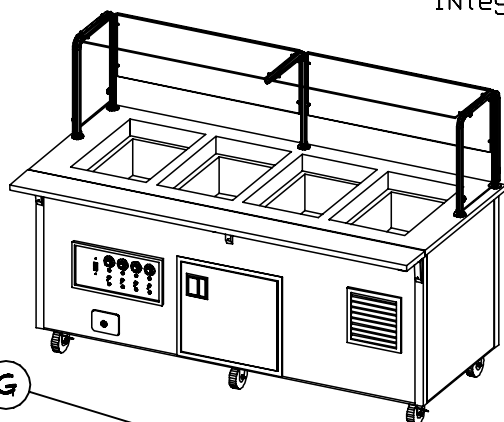

- Server 1 | Qty 1
Utility Counter
A Custom Configuration
B Custom Counter Depth
C Casters : 4" (2) w/Brakes
D Operator Side Plate Rest
w/ Lift-off Bracket
E Access Area w/ Hinged
Doors And Lock
F Drain : 1 1/2" w/ Ball Valve
G Contemporary Breath Guard

Single Side Cafeteria
With Top Shelf
Full Width S-S
*** 6" Front Opening
*** Does Not Meet Current
NSF Standards

Finishes And Materials

Top : ** 14 Ga SST
Body : Standard Black
Trim : Standard SST
Plate Rest : 18 Ga SST
Storage Door : To Match Base
Breath Grd : Brushed SST

VOLTS 208
Ø 1
12.8 A

ELECTRICAL
NEMA 14-20

PLUMBING CW: -
HW: -
WASTE: (1) Ø.5" INDIRECT

FRKHC

FRANKLIN - HOT/COLD



05-27-21

COPYRIGHT 2021

THE VOLLRATH CO., LLC

SHEBOYGAN, WI

GENERAL NOTES - PLEASE READ

CONFIGURATION:

THESE DRAWINGS ARE TO BE USED IN CONJUNCTION WITH THE PREPARED QUOTATION AND MUST BE RECONCILED PRIOR TO RELEASE FOR FABRICATION.

DIMENSIONS:

ALL DIMENSIONS SHOWN ARE $\pm 1/4"$

CONNECTIONS:











ALL PIPING, FITTINGS, AND INTERCONNECTION SERVICES SHOWN ARE TO BE SUPPLIED AND INSTALLED BY LICENSED CONTRACTORS IN ACCORDANCE WITH ALL LOCAL CODES.

BY OTHERS:

VERIFY ALL EQUIPMENT LISTED AS BY OTHERS FOR SIZE AND MECHANICAL SERVICE REQUIREMENTS.

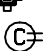
NOTE:

IN LINE WITH THE POLICY TO CONTINUALLY IMPROVE ITS PRODUCTS, THE MANUFACTURE RESERVES THE RIGHT TO CHANGE MATERIALS AND SPECIFICATIONS WITHOUT NOTICE.

	CONNECTION POINT
	COLD WATER
	HOT WATER
	HOT + COLD WATER
	DRAIN
	POWER
	SWITCH
	CORD SET
	CONV OUTLET RECP
	DUPLEX RECPTACLE
	SINGLE RECPTACLE
	REFRIGERATION



CONFIDENTIAL DESIGN

The Vollrath Company, L.L.C. ("Vollrath") considers this new design proprietary and confidential. Due to the existing relationship of trust and good faith between Vollrath and Recipient, Vollrath is providing this proprietary and confidential design and related information to Recipient with the understanding that Recipient will maintain such design and information in secrecy and will not directly or indirectly use, disseminate, or otherwise disclose this proprietary and confidential information to any outside person or organization without the express written prior consent of The Vollrath Company, L.L.C.

05-27-2021

05-27-2021 : 10:26:22a

05-27-2021 : 11:04:39a

FRKHC

FRANKLIN - HOT/COLD



THE VOLLRATH CO., LLC

05-27-21

COPYRIGHT 2021
SHEBOYGAN, WI