

☐ APPROVED AS NOTED

☐ REJECTED

This drawing must be checked, signed, and returned before fabrication begins. Please verify all dimensions, equipment positions, finishes, breath guard mounting, and clearances.

SIGNATURE _____ DATE _____

The designs, drawings, renderings, and other documents ("Designs") furnished by The Vollrath Company, L.L.C. ("Vollrath") to you (including anything in electronic format), are owned by Vollrath. Its licensors or other providers of those materials and are protected by United States and international copyright, trademark, patent, trade secret, and other intellectual property or proprietary rights laws, as applicable. The Designs may not be duplicated, reproduced, modified, or distributed, without the express written consent of Vollrath. All Designs prepared by Vollrath are provided to you on a confidential basis unless agreed otherwise in writing by Vollrath.

You may not use the Designs for any purpose unless you engage Vollrath to complete the design and construction in accordance with the Design and then only for the purpose of completing the design and construction. It is illegal to reproduce, duplicate, modify, resell, redistribute, lease, loan, or develop derivative work, in whole or in part, from the Designs without the express written consent of Vollrath.



1236 N. 18th Street
Sheboygan, WI 53081

vollrathfoodservice.com

REVISIONS

--	--

**Pendergast -
Desert Horizon**

1934 LC NUMBER	
----------------	--

C-12412

BIBLIOGRAPHY

MAIL	6/3/2021
------	----------

SCALE

NTS

Robert Tully

SALLI TULL

**VOLLRATH
PLAN, FRONT,
SIDE**

SHEET NAME

1 of 1

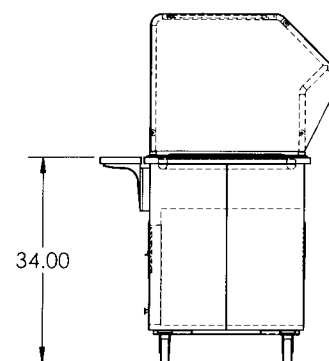
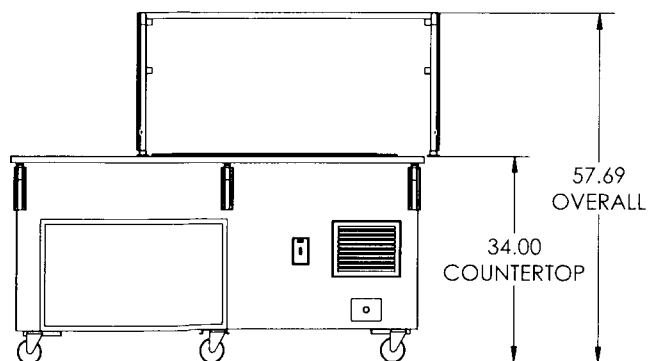
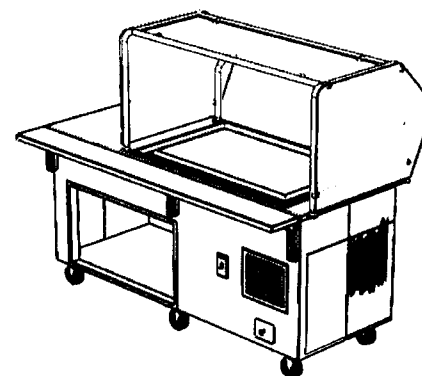
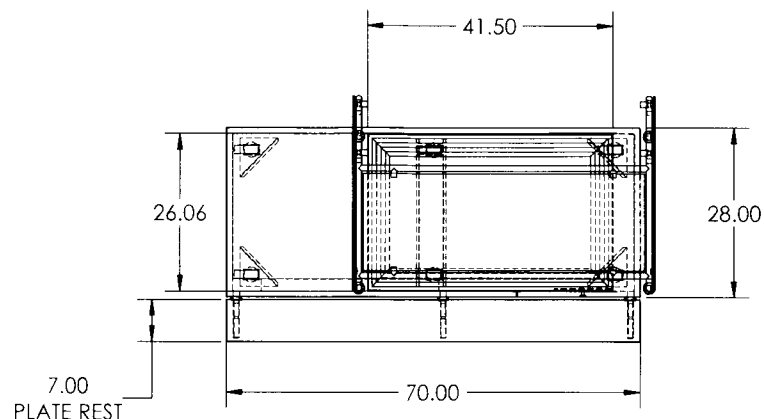

EQUIPMENT 1	EQUIPMENT 2	EQUIPMENT 3	UNIT VOLTS	UNIT AMPS	UNIT PLUG	BASE FINISH	BASE COLOR
UTILITY_SPACE	COLD_FROST	NONE	120	7.8	NEMA 5-15P	BRUSHED STAINLESS	0

☐ APPROVED

☐ REVISE AND RESUBMIT

☐ APPROVED AS NOTED

☐ REJECTED

This drawing must be checked, signed, and returned before fabrication begins. Please verify all dimensions, equipment positions, finishes, breath guard mounting, and clearances.

SIGNATURE _____ DATE _____

The designs, drawings, renderings, and other documents ("Designs") furnished by The Vollrath Company, L.L.C. ("Vollrath") to you (including anything in electronic format), are owned by Vollrath, its licensors or other providers of those materials and are protected by United States and international copyright, trademark, patent, trade secret, and other intellectual property or proprietary rights laws, as applicable. The Designs may not be duplicated, reproduced, modified, or distributed, without the express written consent of Vollrath. All Designs prepared by Vollrath are provided to you on a confidential basis unless agreed otherwise in writing by Vollrath.

You may not use the Designs for any purpose unless you engage Vollrath to complete the design and construction in accordance with the Design and then only for the purpose of completing the design and construction. It is illegal to reproduce, duplicate, modify, resell, redistribute, lease, loan, or develop derivative work, in whole or in part, from the Designs without the express written consent of Vollrath.



1236 N. 18th Street
Sheboygan, WI 53081

vollrathfoodservice.com

REVISIONS

DATE	NO.	DESCRIPTION

Pendergast -
Desert Horizon

PROJECT NUMBER

C-12412

DATE

6/3/2021

SCALE

NTS

DRAWN BY

Robert Tully

CHECKED BY

PROJECT TITLE

VOLLRATH
PLAN, FRONT,
SIDE

SHEET NUMBER

1 of 1

EXTEND GUARD
length of unit
w/ 6" clearance
for tray pass

Assemble and
Trash

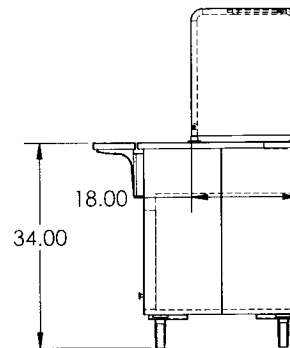
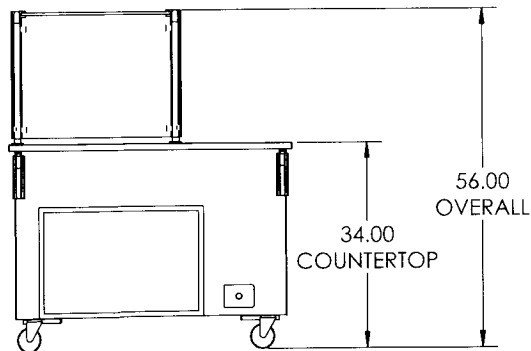
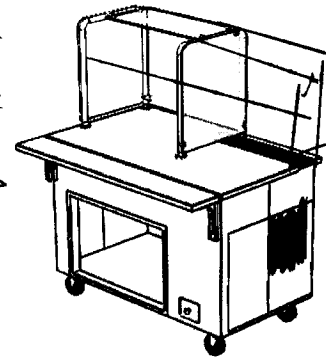
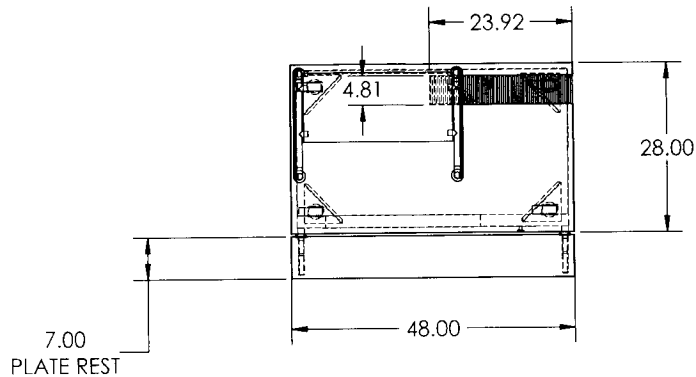

EQUIPMENT 1	EQUIPMENT 2	EQUIPMENT 3	UNIT VOLTS	UNIT AMPS	UNIT PLUG	BASE FINISH	BASE COLOR
UTILITY_SPACE	BEVERAGE	NONE	NA	0	N/A	BRUSHED STAINLESS	0