

BOLTR

BOELTER



THE VOLLRATH CO., LLC

07-29-21

COPYRIGHT 2021

SHEBOYGAN, WI

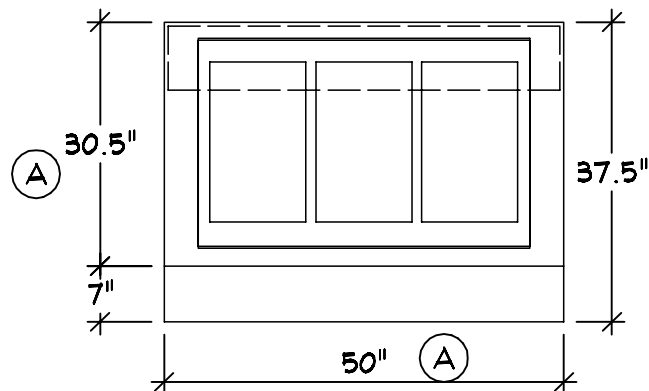
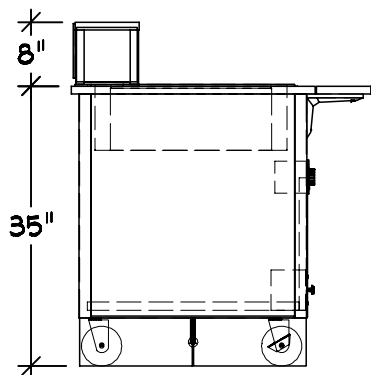

Server 83 1 Qty 1
Utility Counter
A Custom Counter Width,
Depth And Height
B Casters : 5" (2) w/Brakes
(Adds 1" To Height)
C Skirt : SST Toe Kick Alls
D Operator Side Plate Rest
w/ Lift-off Bracket
E Storage Shelf w/o Doors
F Drain : 1½" w/ Ball Valve
G Classic Breath Guard

Single Side Cafeteria
Custom Width Depth And Height
Single Deck
Tempered Glass Kit
Full Width S-S
End Panels Both Sides
** Does Not Meet Current NSF
Standards

A Top Layout Operator L-R
(1) 3 Pan Dropin Wet Hot Well
625 Watt Wells
TSTAT Control Panel

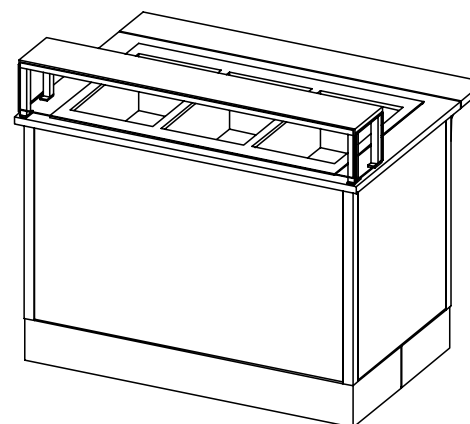
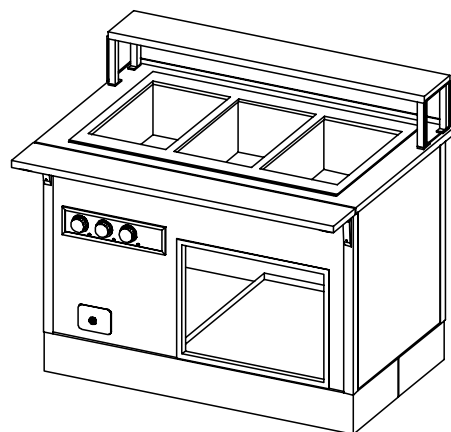

Finishes And Materials
Top : 16 Ga SST
Body : Formica 9285-58
White Twill
Trim : Standard SST
Skirt : 18 Ga SST
Plate Rest : 18 Ga SST
Breath Grd : Polished SST

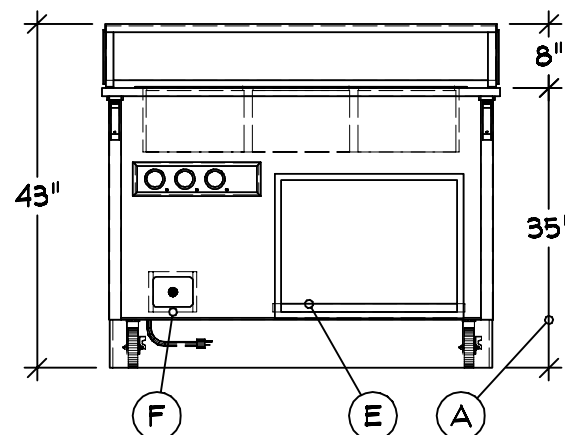
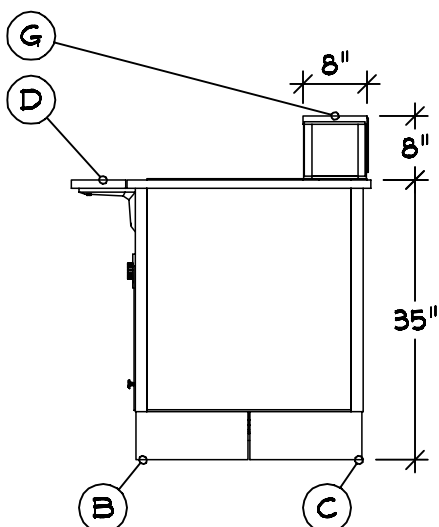

VOLTS 208 60 ELECTRICAL
Ø 1 - - NEMA 6-15
9.0A

PLUMBING CW: -
HW: -
WASTE: (1) Ø.5" INDIRECT

BOLTR

BOELTER



07-29-21
COPYRIGHT 2021
SHEBOYGAN, WI

THE VOLLRATH CO., LLC

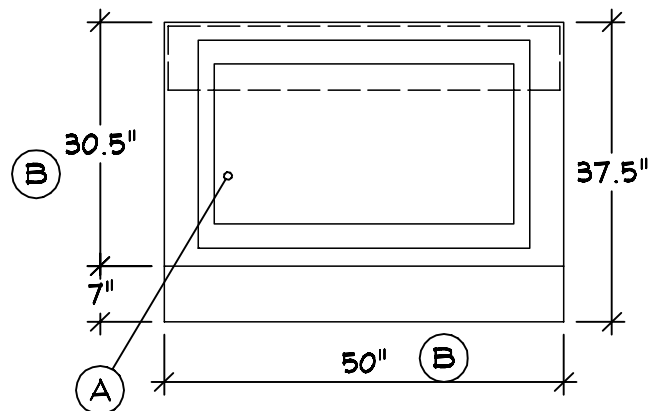
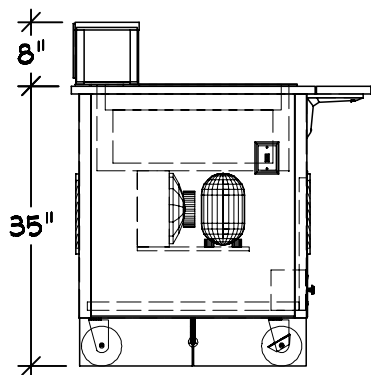

A Top Layout Operator L-R
(1) 3 Pan Drop-in NSF7 Cold Well

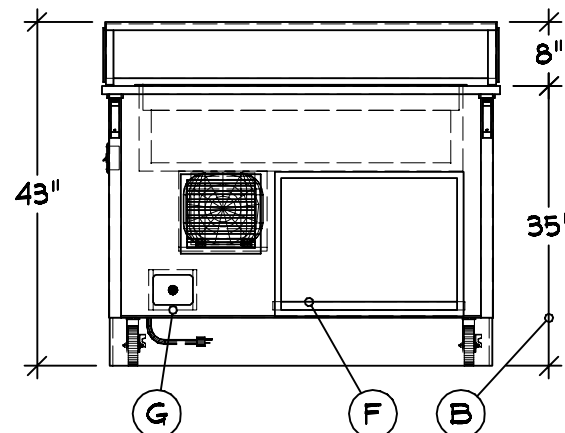
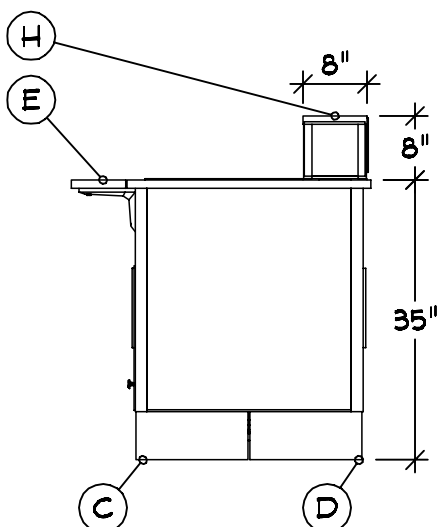
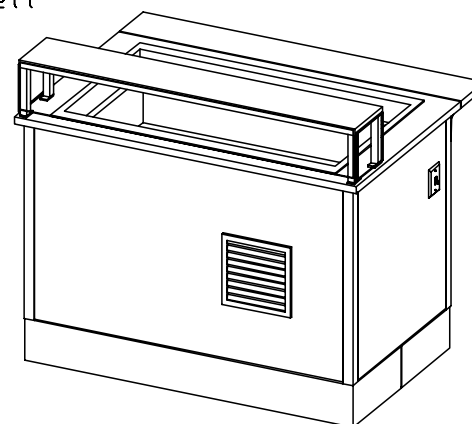
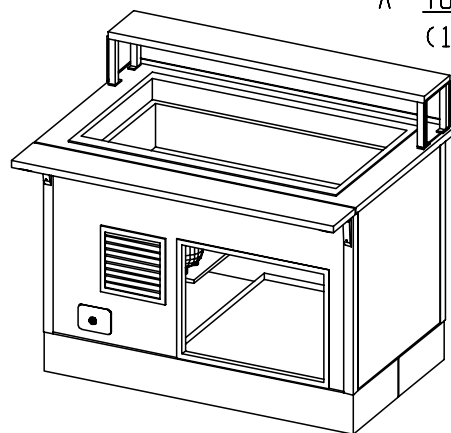

Server 86 1 Qty 1
Utility Counter
A Custom Configuration
B Custom Counter Width,
Depth And Height
C Casters : 5" (2) w/Brakes
(Adds 1" To Height)
D Skirt : SST Toe Kick Alls
E Operator Side Plate Rest
w/ Lift-off Bracket
F Storage Shelf w/o Doors
G Drain : 1 1/2" w/ Ball Valve
H Classic Breath Guard

Single Side Cafeteria
Custom Width Depth And Height
Single Deck
Tempered Glass Kit
Full Width S-S
End Panels Both Sides
** Does Not Meet Current NSF
Standards

Finishes And Materials
Top : 16 Ga SST
Body : Formica 9285-58
White Twill
Trim : Standard SST
Skirt : 18 Ga SST
Plate Rest : 18 Ga SST
Breath Grd : Polished SST

VOLTS 120 60 ELECTRICAL
Ø 1 1/2" NEMA 5-15
3.5 A

PLUMBING CW: -
HW: -
WASTE: (1) Ø.5" INDIRECT

BOLTR

BOELTER

VOLLRATH

THE VOLLRATH CO., LLC

07-29-21
COPYRIGHT 2021
SHEBOYGAN, WI

GENERAL NOTES - PLEASE READ

CONFIGURATION:

THESE DRAWINGS ARE TO BE USED IN CONJUNCTION WITH THE PREPARED QUOTATION AND MUST BE RECONCILED PRIOR TO RELEASE FOR FABRICATION.

DIMENSIONS:

ALL DIMENSIONS SHOWN ARE $\pm 1/4"$

CONNECTIONS:











ALL PIPING, FITTINGS, AND INTERCONNECTION SERVICES SHOWN ARE TO BE SUPPLIED AND INSTALLED BY LICENSED CONTRACTORS IN ACCORDANCE WITH ALL LOCAL CODES.

BY OTHERS:

VERIFY ALL EQUIPMENT LISTED AS BY OTHERS FOR SIZE AND MECHANICAL SERVICE REQUIREMENTS.

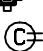
NOTE:

IN LINE WITH THE POLICY TO CONTINUALLY IMPROVE ITS PRODUCTS, THE MANUFACTURE RESERVES THE RIGHT TO CHANGE MATERIALS AND SPECIFICATIONS WITHOUT NOTICE.

	CONNECTION POINT
	COLD WATER
	HOT WATER
	HOT + COLD WATER
	DRAIN
	POWER
	SWITCH
	CORD SET
	CONV OUTLET RECP
	DUPLEX RECPTACLE
	SINGLE RECPTACLE
	REFRIGERATION



CONFIDENTIAL DESIGN

The Vollrath Company, L.L.C. ("Vollrath") considers this new design proprietary and confidential. Due to the existing relationship of trust and good faith between Vollrath and Recipient, Vollrath is providing this proprietary and confidential design and related information to Recipient with the understanding that Recipient will maintain such design and information in secrecy and will not directly or indirectly use, disseminate, or otherwise disclose this proprietary and confidential information to any outside person or organization without the express written prior consent of The Vollrath Company, L.L.C.

07-28-2021

07-28-2021 : 07:14:37a

07-28-2021 : 07:19:11a

07-28-2021 : 11:04:46a

07-29-2021 : 07:15:06a

BOLTR

BOELTER



THE VOLLRATH CO., LLC

07-29-21

COPYRIGHT 2021
SHEBOYGAN, WI